

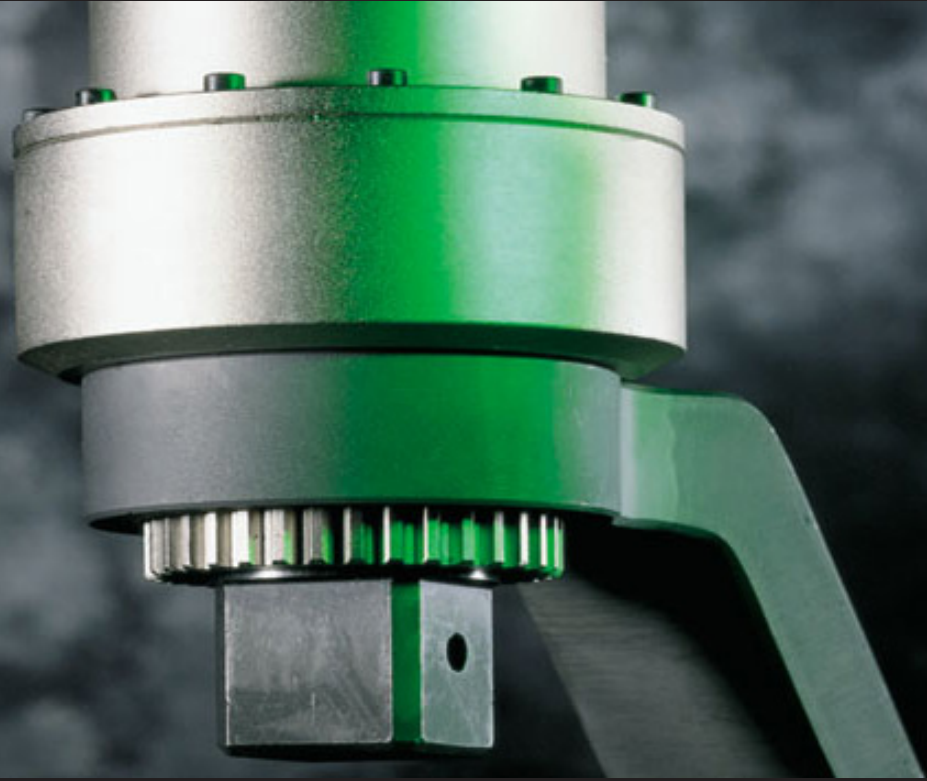

## MANUAL TORQUE MULTIPLIERS



*DynaTorque*

CRITICAL FASTENING SOLUTIONS

Since 1970, **AIMCO** has been providing Global Assembly and Critical Bolting Tooling solutions for the Automotive, Electronics, Aerospace, Energy Services, and General Assembly Industries.

Headquartered in Portland, Oregon, **AIMCO** has become a leading importer and exporter of industrial power tools. **AIMCO** currently exports to over 33 countries including Mexico, Brazil, Germany, France, Korea, China, the UK, India, Denmark, and most recently in Russia.

We are the complete global source for all critical fastening and bolting solutions. AIMCO can effectively and swiftly meet your needs whether you're in Thailand fastening a 3 mm nut at 3 Nm, or in Tennessee, USA torquing the last lug nut. AIMCO provides the tools and solutions, on a global scale, that guarantee the success of your project. It is with great pride that AIMCO can say the products that we manufacture are MADE IN THE USA.

If **Productivity, Ergonomics, Reliability, and Quality** are driving forces in your business, then let **AIMCO** be your value-added partner. **AIMCO** provides cost effective solutions for our customers by resolving challenges related to tightening and critical bolting strategies, tool selection and installation, joint failure analysis, audit trails, and methods. This, combined with operator training, maximizes the production efficiencies our tools provide.

Our strategically located sales force, coupled with our worldwide distribution, make **AIMCO** the right choice for you.



# *DynaTorque* MANUAL TORQUE MULTIPLIERS

*The ultimate solution for accurate, safe torque application*

## CONSTRUCTION FEATURES

- Compact design for use in tight spaces
- High strength planetary gears
- Tempered steel internal components
- No-maintenance permanent internal greasing
- Anti-Wind Up feature
- Phosphatized Chrome Plated external finish



### Casing

Finished in Phosphatized Chrome

### Reaction Bar

Standard offset reaction bar supplied with each unit. Custom Reaction Bars available to suit specific applications (by quotation)

### Shear Design Drive

- External drive fitted with shear design for overload protection
- Spare drive supplied with each unit
- Simple, field replaceable design

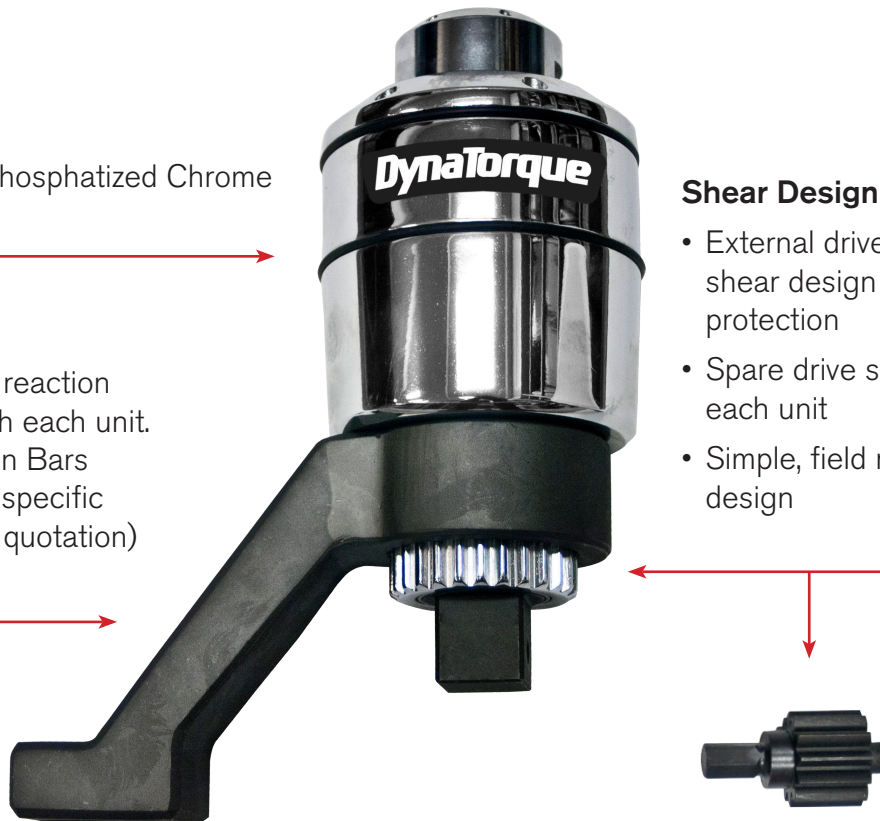

## FEATURES AND BENEFITS

---

Manual Torque Multipliers offer the perfect, economical solution to high torque bolting applications.

- Superior power to weight ratio
- Delivered torque accuracy +/- 4%
- Anti-Wind Up feature (2,800 Nm models and up)
- True Torque Multiplication Ratios
- Standard Reaction Arms supplied. Custom reaction arms/nose extensions available to suit specific applications
- Replaces long lever arms and/or slugging wrenches
- Manually powered – no external power source required
- Value priced
- No preventative maintenance required
- Overload protected by Shear Drive design



## ANTI-WIND UP FEATURE

---

Standard on models delivering 2,800 Nm and up.

- Eliminates the backward force on the torque input device
- Prevents input device from springing backward when released, ensuring operator safety
- Eliminates the need to continually rotate the input device in 360 degree movements to apply torque. In many applications this is simply not possible
- Facilitates removal of the multiplier from the application upon completion of the job

## SHEAR-OFF SYSTEM

---

In order to protect the gear system against overload, DynaTorque Multipliers are fitted with a controlled shear-off system (spare torsion shaft included). Sheared off pins can easily be replaced at the work site.

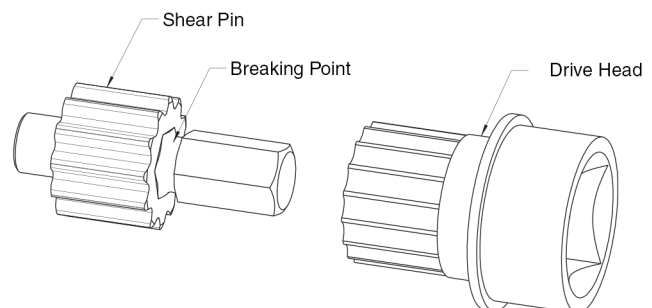

# SPECIFICATIONS

	MODEL	INPUT	OUTPUT	RATIO	MAX TORQUE OUTPUT	
		in	in		Nm	ft-lb
	ATM-800	1/2	3/4	1:3.5	800	590
	ATM-1800	3/4	1	1:3.6	1,800	1,238
	ATM-2800	1/2	1	1:13	2,800	2,066
	ATM-3800	3/4	1	1:13	3,800	2,804
	ATM-5000	3/4	1.5	1:17	5,000	3,690
	ATM-8000	3/4	1.5	1:49	8,000	5,904
	ATM-12000	3/4	1.5	1:58	12,000	8,856
	ATM-16000	3/4	2.5	1:75	16,000	11,808

## SPECIFICATIONS

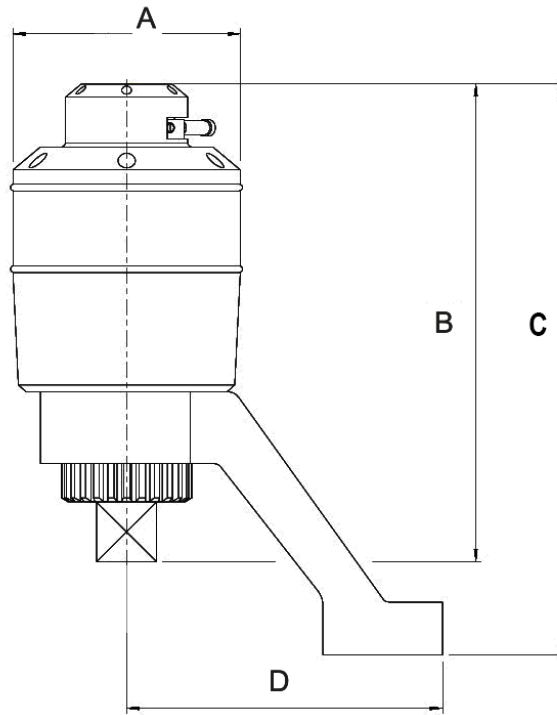

	A	B	C	D	WEIGHT*	
	(MM)	(MM)	(MM)	(MM)	LB	KG
ATM-800	65	105	132	130	2.9	1.3
ATM-1800	90	150	188	132	6.6	3.0
ATM-2800	95	200	240	132	11.5	5.2
ATM-3800	95	200	240	132	11.5	5.2
ATM-5000	120	215	272	150	15.4	7.0
ATM-8000	132	268	344	200	25.4	11.5
ATM-12000	156	272	348	200	30.9	14.0
ATM-16000	215	292	370	225	57.3	26.0

\* Weight shown does not include weight of reaction device.

# *DynaTorque*

# ACCESSORIES



## CARRYING CASE

All DynaTorque Multipliers are supplied in a rugged, weather-resistant, portable carrying case.

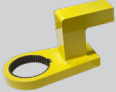
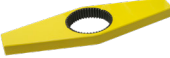

## REACTION BARS

Each tool includes a standard, offset reaction bar. Although a wide variety of applications are easily tightened using the standard bar, many applications are unique in nature. AIMCO offers design consultation and specialized reaction bar designs to suit your specific needs. Contact an AIMCO Customer Service Associate for more details, 1-503-254-6600, or toll free 1-800-852-1368.

	MODEL	DESCRIPTION
 Single Ended Flat	26810	6000 Series
	26800	7000 Series
	25277	8000 Series
	27255	9000 Series
	30303	8X Series
 Single Ended Offset	26815	2.375" Offset, 6000 Series
	26885	4.00" Offset, 6000 Series
	27200	3.10" Offset, 7000 Series
	26890	4.00" Offset, 7000 Series
	25274	3.35" Offset, 8000 Series
	25275	4.00" Offset, 8000 Series
	26840	3.35" Offset, 9000 Series
30306	5.00" Offset, 8X Series	
 Double Ended Flat	26830	6000 Series
	26820	7000 Series
	25278	8000 Series
 Double Ended Offset	25276	3.35" Offset, 8000 Series

## APPLICATIONS - PARTIAL REFERENCES

### POWER



### EQUIPMENT FIELD REPAIR



### SHIPYARD



### STEEL MILL



### OFFSHORE AND EXPLORATION

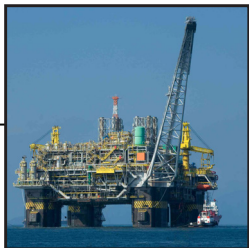

### PETROCHEM



### MINING



### LOCOMOTIVE



#### CORPORATE HEADQUARTERS

10000 SE Pine Street  
Portland, Oregon 97216  
Phone: (503) 254-6600  
Toll Free: 1-800-852-1368

#### AIMCO CORPORATION DE MEXICO SA DE CV

Ave. Cristobal Colon 14529  
Chihuahua, Chihuahua. 31125  
Mexico  
Phone: (01-614) 380-1010  
Fax: (01-614) 380-1019

#### AIMCO CHINA

Room 607, No. 3998 Hongxin Rd  
Minhang District, Shanghai  
China  
Phone: 0086-21-34319246  
Fax: 0086-21-34319245

#### AIMCO SOUTH AMERICA

Calle Congreve No 800. Escobar  
El Aromo. L207  
Provincia de Buenos Aires  
Argentina  
CP: 1625  
Phone: +54 9 11 3341 0543

#### AIMCO SOUTH KOREA

B-1213, 167, Songpa-Daero  
Songpa-Gu, Seoul 05800  
South Korea  
Phone: 0082-2-2054-8930  
Cell: 0082 10 9804 8905

#### AIMCO EUROPE

Dibao Plaza Avenida Río Gallo, 431  
19174 Galápagos - Guadalajara  
Spain  
Phone: +34 673 34 99 25