

MODEL NO.	MAINBOARD ASSEMBLY
iEC4EGV	30209.001
iEC4EGVD	30209.002
iEC4EGVP	30209.003
iEC4EGVN	30209.004
iEC4EGVC	30209.005
iEC4EGVM	30209.006

COMMENTS	ITEM NO.	PART NUMBER	QTY.	DESCRIPTION
	1	SEE CHART	1	MAINBOARD ASSEMBLY, W/TOUCHSCREEN & I/O, GEN 4 CONTROLLER
	2	30203	1	ENCLOSURE ASSEMBLY, W/TOUCHSCREEN, GEN 4 CONTROLLER
	3	27802	1	ENCLOSURE PANEL SIDE COVER
	4	29522	1	SD CARD COVER PLATE
	5	29798	2	SCREW, CAPTIVE FLUSH 4-40, PS10-440-40
	6	27816	1	PLINTH ASSEMBLY, WALL MOUNT
	7	26088	4	SCREW, BHC 8-32X.25, STEEL, BLACK OXIDE
	8	23482	6	KEPS NUT, HEX 10-32, ZINC-PLATED
	9	26363	6	SCREW, FHSC 8-32x5/16, STEEL, BLACK OXIDE
	10	28294	1	LABEL, SERIAL NUMBER AND DESCRIPTION
NOT SHOWN; TO SHIP LOOSE WITH ASSEMBLY	11	28292	1	CABLE, USB 2.0, MALE A TO B, 3M
	12	28293	1	DECAL, EARTH GROUND
	13	28615	1	DECAL, BACKUP CARD ACCESS
NOT SHOWN; TO SHIP LOOSE WITH ASSEMBLY	14	27348	1	I/O WIRING ADAPTER ASSEMBLY
	15	29309	1	SAFETY LABEL, READ OPERATOR'S MANUAL
NOT SHOWN	16	29339	2	MAC ADDRESS

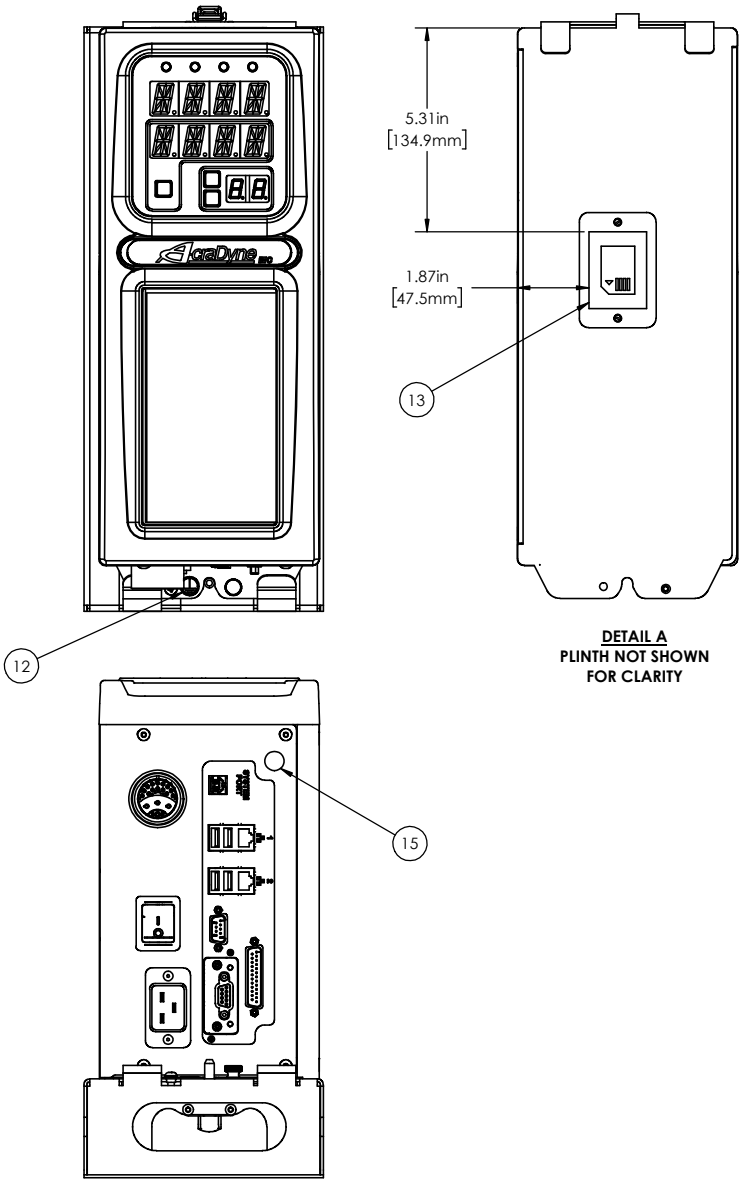

DOCUMENT CONTROL
PRINTED COPIES OF THIS DOCUMENT ARE CONSIDERED TO BE UNCONTROLLED DOCUMENTS. HOLDERS ARE RESPONSIBLE FOR VERIFYING THE CURRENT REVISION LEVEL WITH PURCHASING OR ENGINEERING PRIOR TO USE OR FABRICATION. THE CONTROLLED VERSION OF THIS DOCUMENT IS ELECTRONICALLY MAINTAINED.

PROPRIETARY AND CONFIDENTIAL
THIS DRAWING CONTAINS INFORMATION STRICTLY CONFIDENTIAL TO ACRADYNE/AIMCO. IN THE ABSENCE OF EXPRESSED WRITTEN PERMISSION, ACRADYNE/AIMCO HAS LOANED THIS COPY WITH THE MUTUAL UNDERSTANDING THAT (A) IT WILL NOT BE USED FOR ANY PURPOSE OTHER THAN FOR THAT IN WHICH IT WAS PROVIDED, (B) THE DATA CONTAINED HEREIN WILL NOT BE DISCLOSED TO OTHERS, (C) IT WILL NOT BE REPRODUCED, AND (D) IT WILL BE RETURNED TO ACRADYNE/AIMCO IMMEDIATELY UPON DEMAND.

REVISION LEVEL	REVISION RELEASE DATE	DESCRIPTION OF CHANGES MADE TO PART	ECN #	AUTHOR/ APPROVAL

UNLESS OTHERWISE SPECIFIED, DIMENSIONS ARE IN INCHES
DIMENSIONS AND TOLERANCING PER ANSI Y14.5
SURFACE ROUGHNESS PER ANSI Y14.36

BLOCK TOLERANCING PER DECIMAL:
.X = ±.030 .XX = ±.010 .XXX = ±.005 .XXXX = ±.0005
ANGLE = ±0°30'

REMOVE BURRS AND SHARP EDGES: R.015 MAX
MACHINE SURFACE FINISH: 125 RMS OR BETTER

DRAWINGS AND TECHNICAL DOCUMENTS CONTROLLED BY:
ACRADYNE MECHANICAL ENGINEERING

CONTROLLER ASSY W/ TOUCHSCREEN & I/O		
GEN 4		
SIZE	PART / DRAWING NUMBER	REVISION
D	iEC4EGV	J
SCALE 2:5	DO NOT SCALE DRAWING	SHEET 1 OF 2

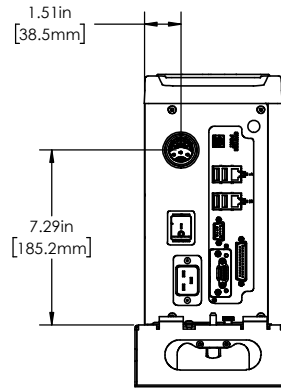
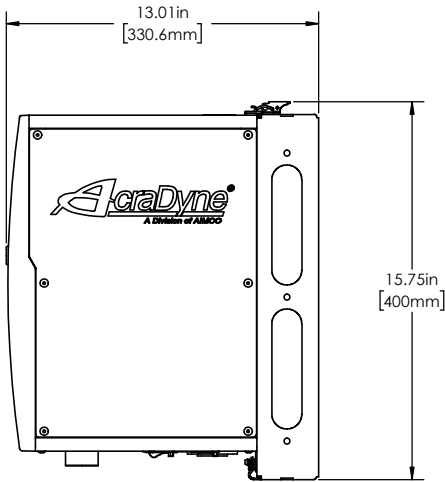
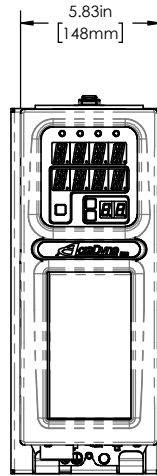
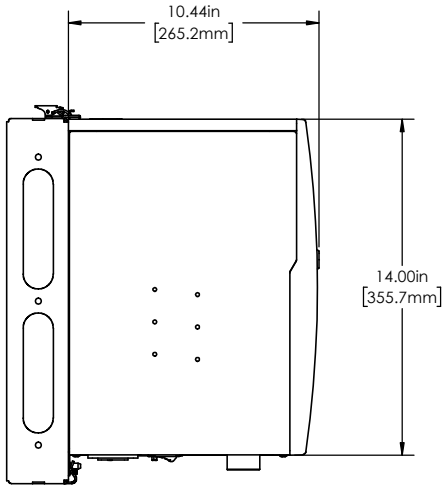
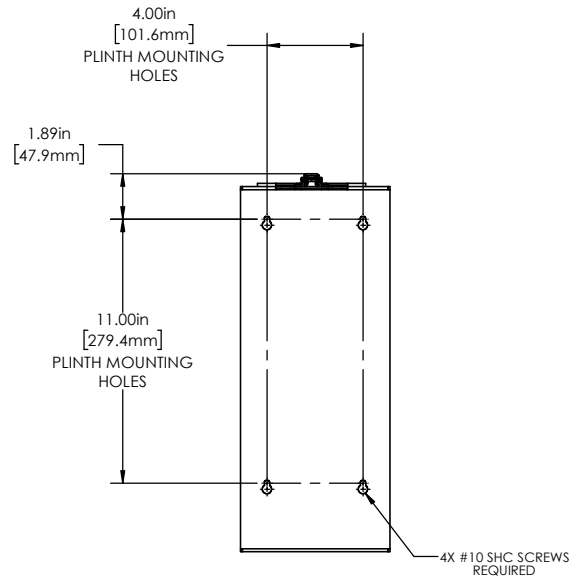
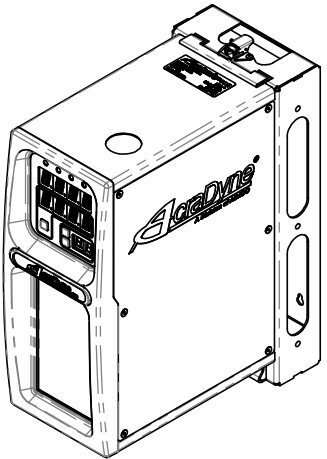
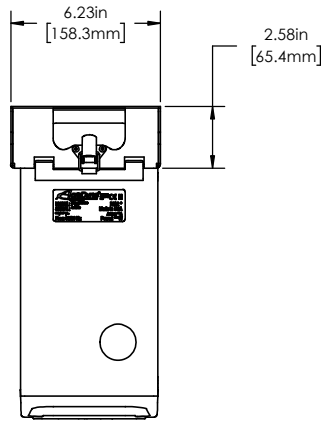
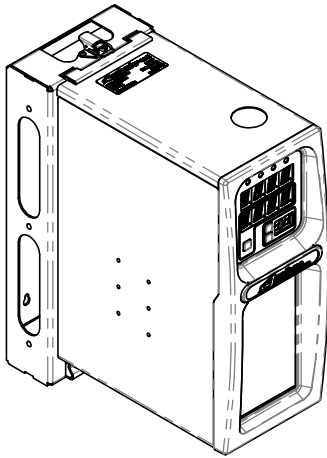

DOCUMENT CONTROL
PRINTED COPIES OF THIS DOCUMENT ARE CONSIDERED TO BE UNCONTROLLED DOCUMENTS. HOLDERS ARE RESPONSIBLE FOR VERIFYING THE CURRENT REVISION LEVEL WITH PURCHASING OR ENGINEERING PRIOR TO USE OR FABRICATION. THE CONTROLLED VERSION OF THIS DOCUMENT IS ELECTRONICALLY MAINTAINED.

PROPRIETARY AND CONFIDENTIAL
THIS DRAWING CONTAINS INFORMATION STRICTLY CONFIDENTIAL TO ACRADYNE/AIMCO. IN THE ABSENCE OF EXPRESSED WRITTEN PERMISSION, ACRADYNE/AIMCO HAS LOANED THIS COPY WITH THE MUTUAL UNDERSTANDING THAT (A) IT WILL NOT BE USED FOR ANY PURPOSE OTHER THAN FOR THAT IN WHICH IT WAS PROVIDED, (B) THE DATA CONTAINED HEREIN WILL NOT BE DISCLOSED TO OTHERS, (C) IT WILL NOT BE REPRODUCED, AND (D) IT WILL BE RETURNED TO ACRADYNE/AIMCO IMMEDIATELY UPON DEMAND.

REVISION LEVEL	REVISION RELEASE DATE	DESCRIPTION OF CHANGES MADE TO PART	ECN #	AUTHOR/ APPROVAL
REVISION BLOCK				

UNLESS OTHERWISE SPECIFIED, DIMENSIONS ARE IN INCHES
DIMENSIONS AND TOLERANCING PER ANSI Y14.5
SURFACE ROUGHNESS PER ANSI Y14.36

BLOCK TOLERANCING PER DECIMAL:
.X = ±.030 .XX = ±.010 .XXX = ±.005 .XXXX = ±.0005
ANGLE = ±0° 30'

REMOVE BURRS AND SHARP EDGES: R.015 MAX
MACHINE SURFACE FINISH: 125 RMS OR BETTER

DRAWINGS AND TECHNICAL DOCUMENTS CONTROLLED BY:
ACRADYNE MECHANICAL ENGINEERING

CONTROLLER ASSY W/ TOUCHSCREEN & I/O		
GEN 4		
SIZE D	PART / DRAWING NUMBER IEC4EGV	REVISION J
SCALE 1:4	DO NOT SCALE DRAWING	SHEET 2 OF 2