

COMMENTS	ITEM NO.	PART NUMBER	QTY.	DESCRIPTION
	1	26481	1	MOTOR ASM.
	2	25574	4	STANDOFF M-F, 4-40x1/4, 3/16 HEX, SS
	3	27785	1	TID BOARD, POPULATED W/O AMP CIRCUIT
	4	29337	3	STANDOFF, M-F, 4-40 X 1/8, SS
	5	29336	1	TID BOARD WIRE INSULATOR
	6	25573	6	SCREW PHP 4-40 X 3/16 18-8 SS
	7	26487	1	O-RING, LED COVER
	8	26483	1	LED COVER
	9	26493	1	LEVER HANDLE
	10	27401	4	SCREW, BHSC 10-32 X 1.25, STEEL, BLK OXIDE
	11	20534	1	LABEL, SERIAL/MODEL NUMBER
	12	25745	5	SCREW, BHSC 4-40 STEEL, BLACK OXIDE
	13	SEE CHART	1	GEARBOX/CLUTCH ASM.
	14	26299	3	O-RING, PINION
	15	27974	1	SLIP RING PINION ADAPTOR, CLUTCH
	16	31686	1	ANGLEHEAD ASM., HT 6000 SERIES
	17	31568	1	MOTOR COUPLER, HT ANGLE TOOL
	18	29285	12	SCREW, BHSC, 8-32 x .38, TORX HEAD, NYLON PELL-IT, BLK OXIDE
	19	20132	1	THROTTLE SPRING
	20	26532	1	GEN 3 TRIGGER ASSY, CAST
	21	20061	2	SCREW, LEVER
	22	26285	1	LEVER TRIGGER PCB ASM.
NOT SHOWN	23	26526	1	TRIGGER CABLE
	24	27660	1	TOOL CONNECTOR ASM., STRAIGHT
	25	26461	2	SCREW, FHC 4-40 X .50 LG., STEEL, BLACK OXIDE
	26	24679	1	RETAINING RNG
	27	24683	1	SPRING, REV BUTTON
	28	24706	1	REV BUTTON SUB-ASSEMBLY
	29	26084	1	HANDLE COVER, MFB
	30	26083	1	HANDLE COVER
	31	24938	10	SCREW, FHSC 4-40X.188, STEEL, BLACK OXIDE
	32	31410	1	GROUND WIRE ASSEMBLY, 18 AWG, 6000 & 7000 HT SERIES
	33	31395.001	1	JUMPER ASM., (3) LINE, MALE/FEMALE, 8" LG.
	34	26297	1	TRAY, WIRE, "D" & LEVER HANDLE
	35	26206	6	SCREW, BHSC 10-32 X .375, STEEL
	36	26495	1	GEAR CASE COVER
	37	26319	3	SCREW, BHSC 6-32 X .188, 18-8 SS
	38	26896	1	CHOOSE REACTION BAR
	39	26514	1	RETAINING RING, SPIRAL, Ø2.441 X Ø2.105 X .078
	40	31685	1	TRANSDUCER WIRE COVER, HT ANGLE TOOL, 6000-SERIES
	41	31819	2	SCREW, SHC, 6-32 X 7/16, STEEL, BLACK OXIDE
NOT SHOWN	42	28257	4	CABLE TIE, 1.65MM WIDE X 71MM LG.

NOTE:
SEE WORK INSTRUCTION DOCUMENT "W2047"
FOR COMPLETE SLIP RING ASSEMBLY INSTRUCTIONS

MODEL NO.	GEARBOX/CLUTCH ASM.
AEN4B66250B	31687
AEN4B66425B	31688
AEN4B66625B	31689
AEN4B66925B	31690

- ◆ ASSEMBLY INSTRUCTIONS
 - ◊ SUB-ASSEMBLY
- 1) GEARS & SPLINES: LUBRICATE WITH DOW CORNING MOLYKOTE BR2 PLUS GREASE.
 - 2) BEARINGS: LUBRICATE WITH CHEVRON SR1 GREASE
 - 3) O-RINGS: LUBRICATE WITH O-RING LUBE
 - 4) APPLY LOCTITE 222 (PURPLE) TIGHTEN TO 1.0Nm (9 IN-LBS)



DOCUMENT CONTROL
PRINTED COPIES OF THIS DOCUMENT ARE CONSIDERED TO BE UNCONTROLLED DOCUMENTS. HOLDERS ARE RESPONSIBLE FOR VERIFYING THE CURRENT REVISION LEVEL WITH PURCHASING OR ENGINEERING PRIOR TO USE OR FABRICATION. THE CONTROLLED VERSION OF THIS DOCUMENT IS ELECTRONICALLY MAINTAINED.

PROPRIETARY AND CONFIDENTIAL
THIS DRAWING CONTAINS INFORMATION STRICTLY CONFIDENTIAL TO ACRADYNE/AIMCO. IN THE ABSENCE OF EXPRESSED WRITTEN PERMISSION, ACRADYNE/AIMCO HAS LOANED THIS COPY WITH THE MUTUAL UNDERSTANDING THAT (A) IT WILL NOT BE USED FOR ANY PURPOSE OTHER THAN FOR THAT IN WHICH IT WAS PROVIDED, (B) THE DATA CONTAINED HEREIN WILL NOT BE DISCLOSED TO OTHERS, (C) IT WILL NOT BE REPRODUCED, AND (D) IT WILL BE RETURNED TO ACRADYNE/AIMCO IMMEDIATELY UPON DEMAND.

REVISION LEVEL	REVISION RELEASE DATE	DESCRIPTION OF CHANGES MADE TO PART	ECN #	AUTHOR/ APPROVAL
REVISION BLOCK				

UNLESS OTHERWISE SPECIFIED,
DIMENSIONS ARE IN INCHES
DIMENSIONS AND TOLERANCING PER ANSI Y14.5
SURFACE ROUGHNESS PER ANSI Y14.36

BLOCK TOLERANCING PER DECIMAL:
X = ±.030 XX = ±.010 XXX = ±.005 XXXX = ±.0005
ANGLE = ±.30°

REMOVE BURRS AND SHARP EDGES: R.015 MAX
MACHINE SURFACE FINISH: 125 RMS OR BETTER

DRAWINGS AND TECHNICAL DOCUMENTS CONTROLLED BY:
ACRADYNE MECHANICAL ENGINEERING

**ANGLE NUTRUNNER,
SLIPRING CLUTCH
6000-SERIES**

SIZE	PART / DRAWING NUMBER	REVISION
D	AEN4B66 B	A
SCALE 1:2	DO NOT SCALE DRAWING	SHEET 1 OF 2

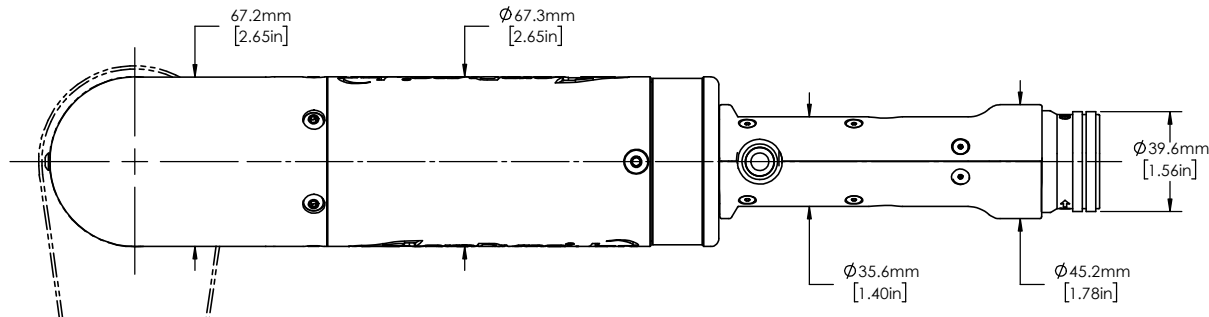

TOOL MODELS
AEN4B66250B
AEN4B66425B
AEN4B66625B
AEN4B66925B

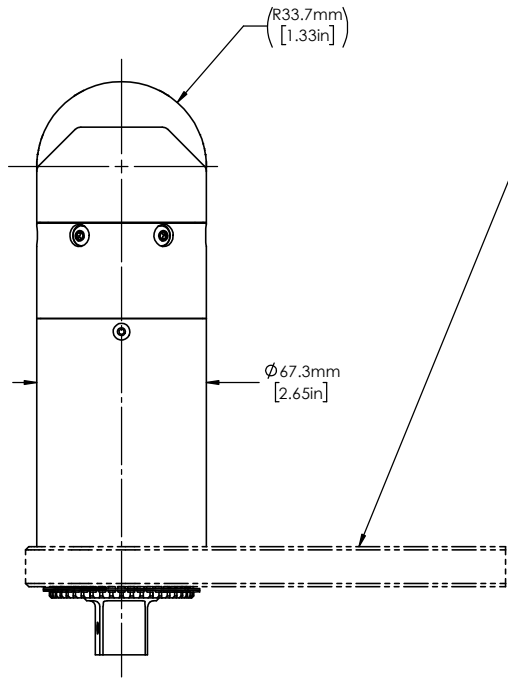

NOTE:
REACTION BAR GEOMETRY
TO CHANGE DEPENDING
ON REACTION BAR CHOSEN.

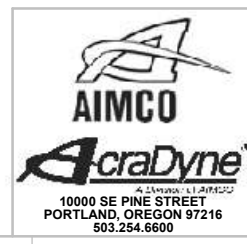
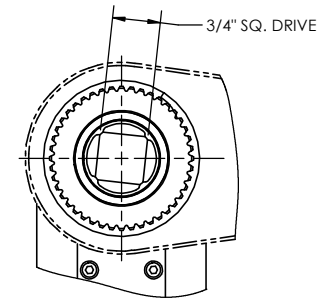
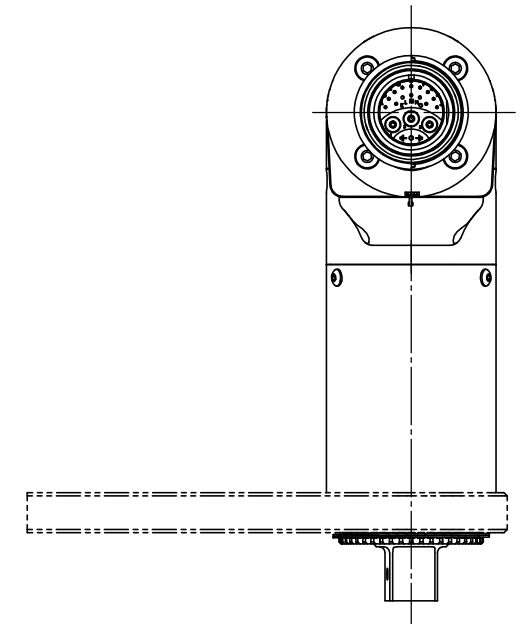
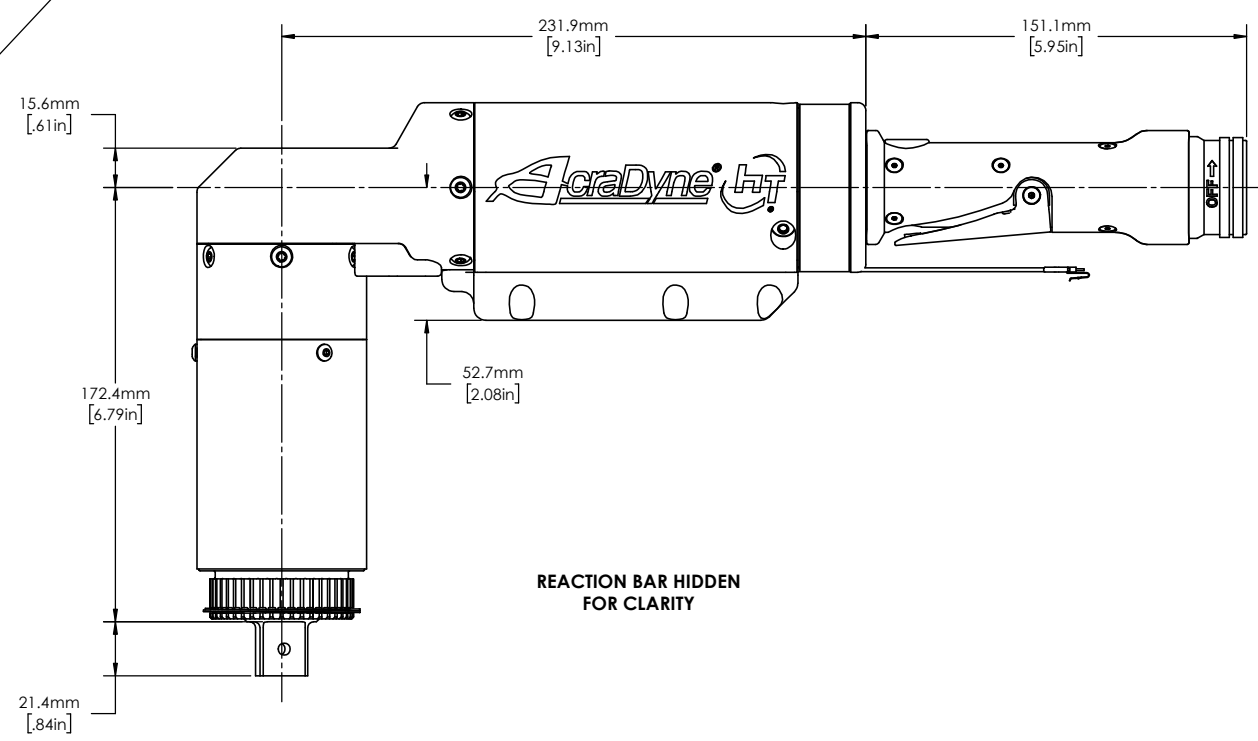

DOCUMENT CONTROL
PRINTED COPIES OF THIS DOCUMENT ARE CONSIDERED TO BE UNCONTROLLED DOCUMENTS. HOLDERS ARE RESPONSIBLE FOR VERIFYING THE CURRENT REVISION LEVEL WITH PURCHASING OR ENGINEERING PRIOR TO USE OR FABRICATION. THE CONTROLLED VERSION OF THIS DOCUMENT IS ELECTRONICALLY MAINTAINED.

PROPRIETARY AND CONFIDENTIAL
THIS DRAWING CONTAINS INFORMATION STRICTLY CONFIDENTIAL TO ACRADYNE/AIMCO. IN THE ABSENCE OF EXPRESSED WRITTEN PERMISSION, ACRADYNE/AIMCO HAS LOANED THIS COPY WITH THE MUTUAL UNDERSTANDING THAT (A) IT WILL NOT BE USED FOR ANY PURPOSE OTHER THAN FOR THAT IN WHICH IT WAS PROVIDED, (B) THE DATA CONTAINED HEREIN WILL NOT BE DISCLOSED TO OTHERS, (C) IT WILL NOT BE REPRODUCED, AND (D) IT WILL BE RETURNED TO ACRADYNE/AIMCO IMMEDIATELY UPON DEMAND.

REVISION LEVEL	REVISION RELEASE DATE	DESCRIPTION OF CHANGES MADE TO PART	ECN #	AUTHOR/ APPROVAL

UNLESS OTHERWISE SPECIFIED, DIMENSIONS ARE IN INCHES
DIMENSIONS AND TOLERANCING PER ANSI Y14.5
SURFACE ROUGHNESS PER ANSI Y14.36

BLOCK TOLERANCING PER DECIMAL:
X = ±.030 XX = ±.010 XXX = ±.005 XXXX = ±.0005
ANGLE = ±0° 30'

REMOVE BURRS AND SHARP EDGES: R.015 MAX
MACHINE SURFACE FINISH: 125 RMS OR BETTER

DRAWINGS AND TECHNICAL DOCUMENTS CONTROLLED BY:
ACRADYNE MECHANICAL ENGINEERING

**ANGLE NUTRUNNER,
SLIPRING CLUTCH
6000-SERIES**

SIZE	PART / DRAWING NUMBER	REVISION
D	AEN4B66 B	A
SCALE: 2:3	DO NOT SCALE DRAWING	SHEET 2 OF 2