

COMMENTS	ITEM NO.	PART NUMBER	QTY.	DESCRIPTION
	1	26481	1	MOTOR ASM.
	2	25574	4	STANDOFF M-F, 4-40x1/4, 3/16 HEX, SS
	3	27727	1	TID BOARD, POPULATED W/AMP
	4	29337	3	STANDOFF, M-F, 4-40 X 1/8, SS
	5	29336	1	TID BOARD WIRE INSULATOR
	6	25573	7	SCREW PHP 4-40 X 3/16 18-8 SS
	7	26487	1	O-RING, LED COVER
	8	26483	1	LED COVER
	9	26493	1	LEVER HANDLE
	10	27401	4	SCREW, BHSC 10-32 X 1.25, STEEL, BLK OXIDE
	11	20534	1	LABEL, SERIAL/MODEL NUMBER
	12	25745	5	SCREW, BHSC 4-40 STEEL, BLACK OXIDE
	13	SEE CHART	1	GEARBOX ASM.
	14	26299	2	O-RING, PINION
	15	31686	1	ANGLEHEAD ASM., HT 6000 SERIES
	16	31568	1	MOTOR COUPLER, HT ANGLE TOOL
	17	29285	12	SCREW, BHSC, 8-32 X .38, TORX HEAD, NYLON PELL-IT, BLK OXIDE
	18	20132	1	THROTTLE SPRING
	19	26532	1	GEN 3 TRIGGER ASSY, CAST
	20	20061	2	SCREW, LEVER
	21	26285	1	LEVER TRIGGER PCB ASM.
NOT SHOWN	22	26526	1	TRIGGER CABLE
	23	27660	1	TOOL CONNECTOR ASM., STRAIGHT
	24	26461	2	SCREW, FHC 4-40 X .50 LG., STEEL, BLACK OXIDE
	25	24679	1	RETAINING RNG
	26	24683	1	SPRING, REV BUTTON
	27	24706	1	REV BUTTON SUB-ASSEMBLY
	28	26084	1	HANDLE COVER, MFB
	29	26083	1	HANDLE COVER
	30	24938	10	SCREW, FHSC 4-40X.188, STEEL, BLACK OXIDE
	31	31410	1	GROUND WIRE ASSEMBLY, 18 AWG, 6000 & 7000 HT SERIES
	32	28211	1	(4) LINE MALE/FEMALE JUMPER ASM.
	33	26297	1	TRAY, WIRE, "D" & LEVER HANDLE
	34	26206	6	SCREW, BHSC 10-32 X .375, STEEL
	35	26495	1	GEAR CASE COVER
	36	26319	3	SCREW, BHSC 6-32 X .188, 18-8 SS
	37	26896	1	CHOOSE REACTION BAR
	38	26514	1	RETAINING RING, SPIRAL, Ø2.441 X Ø2.105 X .078
	39	31685	1	TRANSDUCER WIRE COVER, HT ANGLE TOOL, 6000-SERIES
	40	26167	2	SCREW, SHC, 6-32 X 5/8, STEEL
NOT SHOWN	41	28257	4	CABLE TIE, 1.65MM WIDE X 71MM LG.

MODEL NO.	GEARBOX ASM.
AEN4A66250B	28658
AEN4A66425B	28798
AEN4A66625B	28108
AEN4A66925B	28109

- ◆ ASSEMBLY INSTRUCTIONS
 ◡ SUB-ASSEMBLY
- 1) GEARS & SPLINES: LUBRICATE WITH DOW CORNING MOLYKOTE BR2 PLUS GREASE.
 - 2) BEARINGS: LUBRICATE WITH CHEVRON SR1 GREASE
 - 3) O-RINGS: LUBRICATE WITH O-RING LUBE
 - 4) APPLY LOCTITE 222 (PURPLE) TIGHTEN TO 1.0Nm (9 IN-LBS)



DOCUMENT CONTROL
 PRINTED COPIES OF THIS DOCUMENT ARE CONSIDERED TO BE UNCONTROLLED DOCUMENTS. HOLDERS ARE RESPONSIBLE FOR VERIFYING THE CURRENT REVISION LEVEL WITH PURCHASING OR ENGINEERING PRIOR TO USE OR FABRICATION. THE CONTROLLED VERSION OF THIS DOCUMENT IS ELECTRONICALLY MAINTAINED.

PROPRIETARY AND CONFIDENTIAL
 THIS DRAWING CONTAINS INFORMATION STRICTLY CONFIDENTIAL TO ACRADYNE/AIMCO. IN THE ABSENCE OF EXPRESSED WRITTEN PERMISSION, ACRADYNE/AIMCO HAS LOANED THIS COPY WITH THE MUTUAL UNDERSTANDING THAT (A) IT WILL NOT BE USED FOR ANY PURPOSE OTHER THAN FOR THAT IN WHICH IT WAS PROVIDED, (B) THE DATA CONTAINED HEREIN WILL NOT BE DISCLOSED TO OTHERS, (C) IT WILL NOT BE REPRODUCED, AND (D) IT WILL BE RETURNED TO ACRADYNE/AIMCO IMMEDIATELY UPON DEMAND.

REVISION LEVEL	REVISION RELEASE DATE	DESCRIPTION OF CHANGES MADE TO PART	ECN #	AUTHOR/ APPROVAL

UNLESS OTHERWISE SPECIFIED, DIMENSIONS ARE IN INCHES
 DIMENSIONS AND TOLERANCING PER ANSI Y14.5 SURFACE ROUGHNESS PER ANSI Y14.36

BLOCK TOLERANCING PER DECIMAL:
 .X = ±.030 .XX = ±.010 .XXX = ±.005 .XXXX = ±.0005
 ANGLE = ±.30°

REMOVE BURRS AND SHARP EDGES: R.015 MAX MACHINE SURFACE FINISH: 125 RMS OR BETTER

DRAWINGS AND TECHNICAL DOCUMENTS CONTROLLED BY:
ACRADYNE MECHANICAL ENGINEERING

ANGLE NUTRUNNER, W/O SLIPRING CLUTCH 6000-SERIES

SIZE	PART / DRAWING NUMBER	REVISION
D	AEN4A66 B	A

SCALE 1:2 DO NOT SCALE DRAWING SHEET 1 OF 2

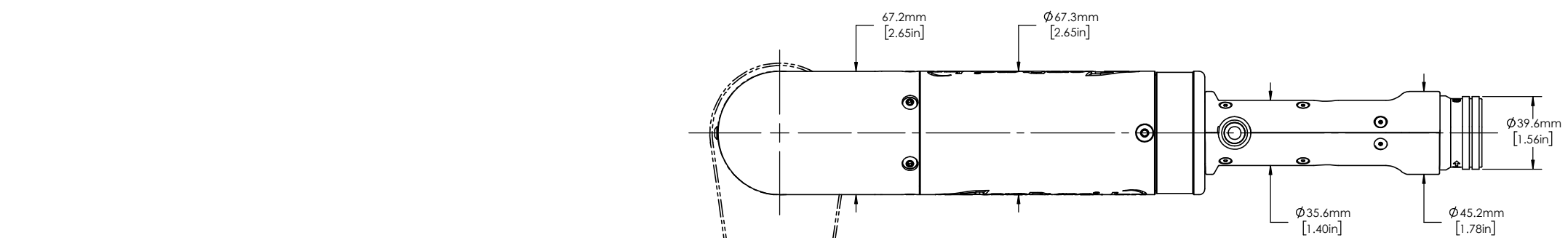

TOOL MODELS
AEN4A66250B
AEN4A66425B
AEN4A66625B
AEN4A66925B

NOTE:
REACTION BAR GEOMETRY
TO CHANGE DEPENDING
ON REACTION BAR CHOSEN.

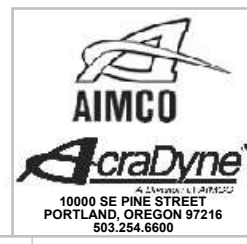
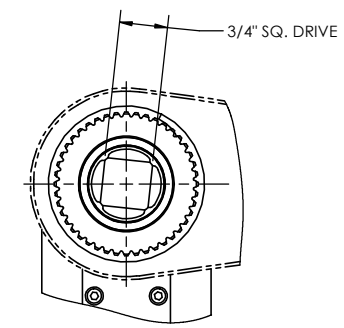
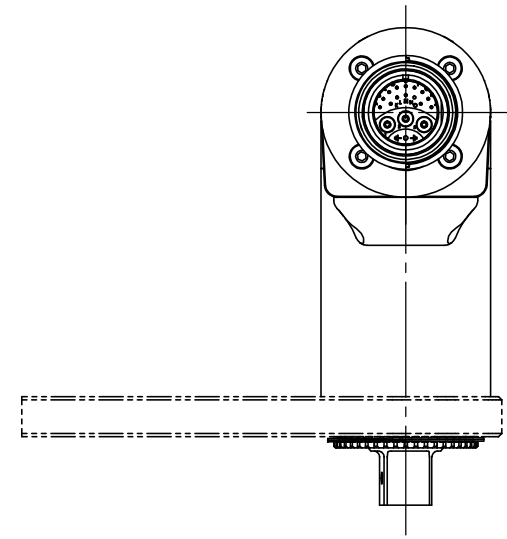
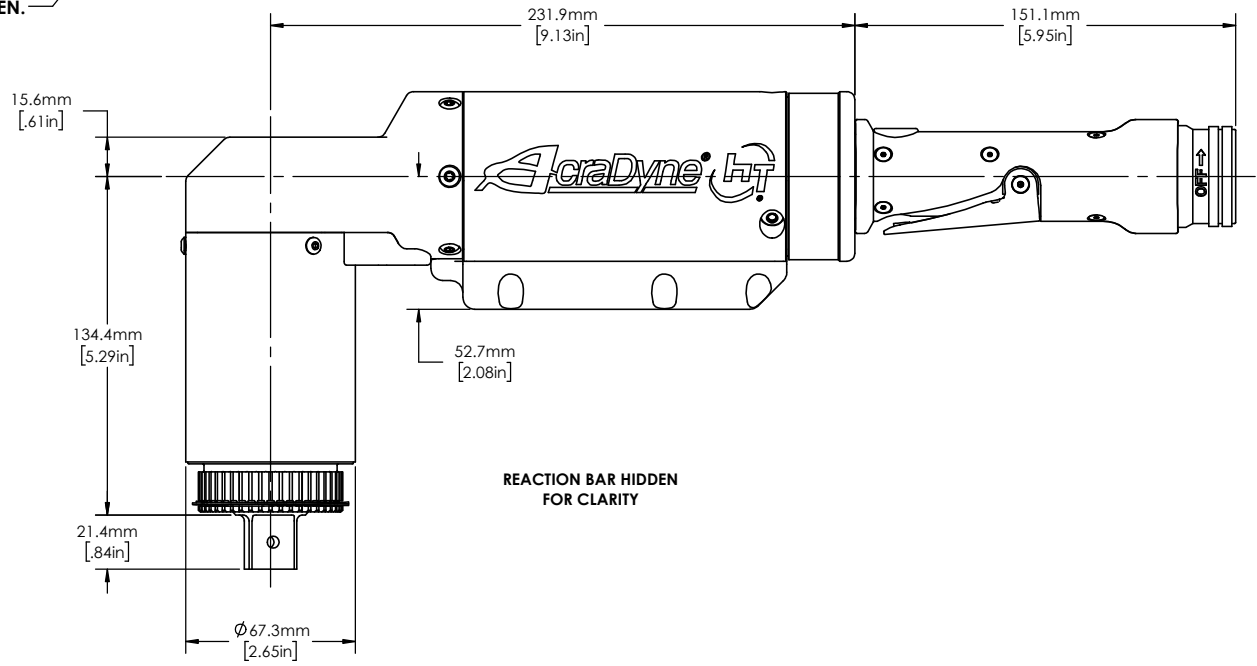
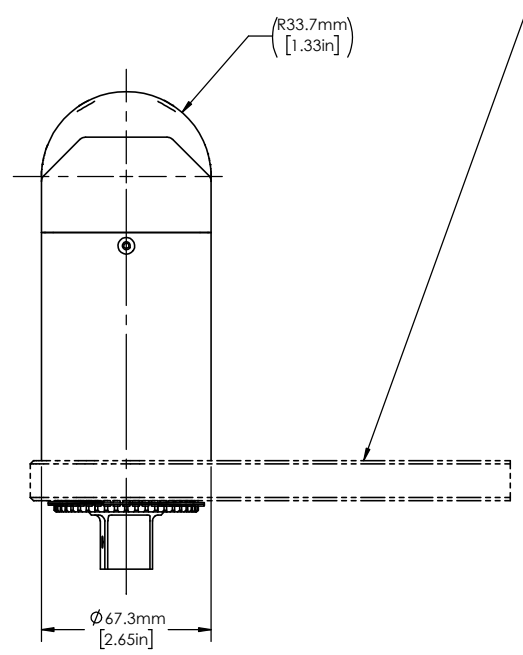

DOCUMENT CONTROL
PRINTED COPIES OF THIS DOCUMENT ARE CONSIDERED TO BE UNCONTROLLED DOCUMENTS. HOLDERS ARE RESPONSIBLE FOR VERIFYING THE CURRENT REVISION LEVEL WITH PURCHASING OR ENGINEERING PRIOR TO USE OR FABRICATION. THE CONTROLLED VERSION OF THIS DOCUMENT IS ELECTRONICALLY MAINTAINED.

PROPRIETARY AND CONFIDENTIAL
THIS DRAWING CONTAINS INFORMATION STRICTLY CONFIDENTIAL TO ACRADYNE/AIMCO. IN THE ABSENCE OF EXPRESSED WRITTEN PERMISSION, ACRADYNE/AIMCO HAS LOANED THIS COPY WITH THE MUTUAL UNDERSTANDING THAT (A) IT WILL NOT BE USED FOR ANY PURPOSE OTHER THAN FOR THAT IN WHICH IT WAS PROVIDED, (B) THE DATA CONTAINED HEREIN WILL NOT BE DISCLOSED TO OTHERS, (C) IT WILL NOT BE REPRODUCED, AND (D) IT WILL BE RETURNED TO ACRADYNE/AIMCO IMMEDIATELY UPON DEMAND.

REVISION LEVEL	REVISION RELEASE DATE	DESCRIPTION OF CHANGES MADE TO PART	ECN #	AUTHOR/ APPROVAL
A				

UNLESS OTHERWISE SPECIFIED, DIMENSIONS ARE IN INCHES
DIMENSIONS AND TOLERANCING PER ANSI Y14.5
SURFACE ROUGHNESS PER ANSI Y14.36

BLOCK TOLERANCING PER DECIMAL:
X = ±.030 XX = ±.010 XXX = ±.005 XXXX = ±.0005
ANGLE = ±0° 30'

REMOVE BURRS AND SHARP EDGES: R.015 MAX
MACHINE SURFACE FINISH: 125 RMS OR BETTER

DRAWINGS AND TECHNICAL DOCUMENTS CONTROLLED BY:
ACRADYNE MECHANICAL ENGINEERING

**ANGLE NUTRUNNER,
W/O SLIPRING CLUTCH
6000-SERIES**

SIZE	PART / DRAWING NUMBER	REVISION
D	AEN4A66 B	A
SCALE: 2:3	DO NOT SCALE DRAWING	SHEET 2 OF 2