

PASS CONNECTOR FROM SLIP-RING ASM. (NOT SHOWN) THRU SLOT AT BOTTOM OF OUTER SLIP RING PLATE. TAPE WIRE TO THE BOTTOM OF THE MOTOR HOUSING, THEN THRU THE HOLE IN THE BOTTOM OF THE MOTOR HOUSING. ATTACH CONNECTOR TO MATING CONNECTOR ON ITEM 3.

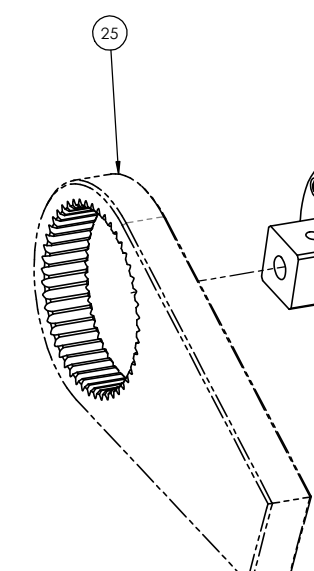

SECURE ALL ELECTRICAL CONNECTIONS WITH ITEM 27 P/N 28257

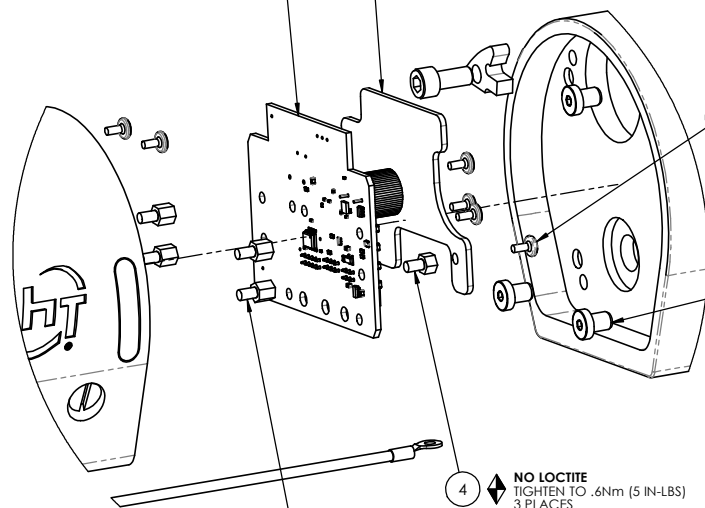

DETAIL B
SCALE 1 : 1

- ◆ ASSEMBLY INSTRUCTIONS
- ◊ SUB-ASSEMBLY
- 1) GEARS & SPLINES: LUBRICATE WITH DOW CORNING MOLYKOTE BR2 PLUS GREASE.
- 2) BEARINGS: LUBRICATE WITH CHEVRON SR1 GREASE
- 3) O-RINGS: LUBRICATE WITH O-RING LUBE

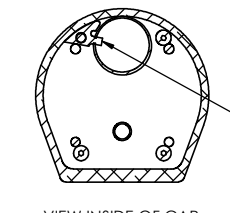

VIEW INSIDE OF CAP

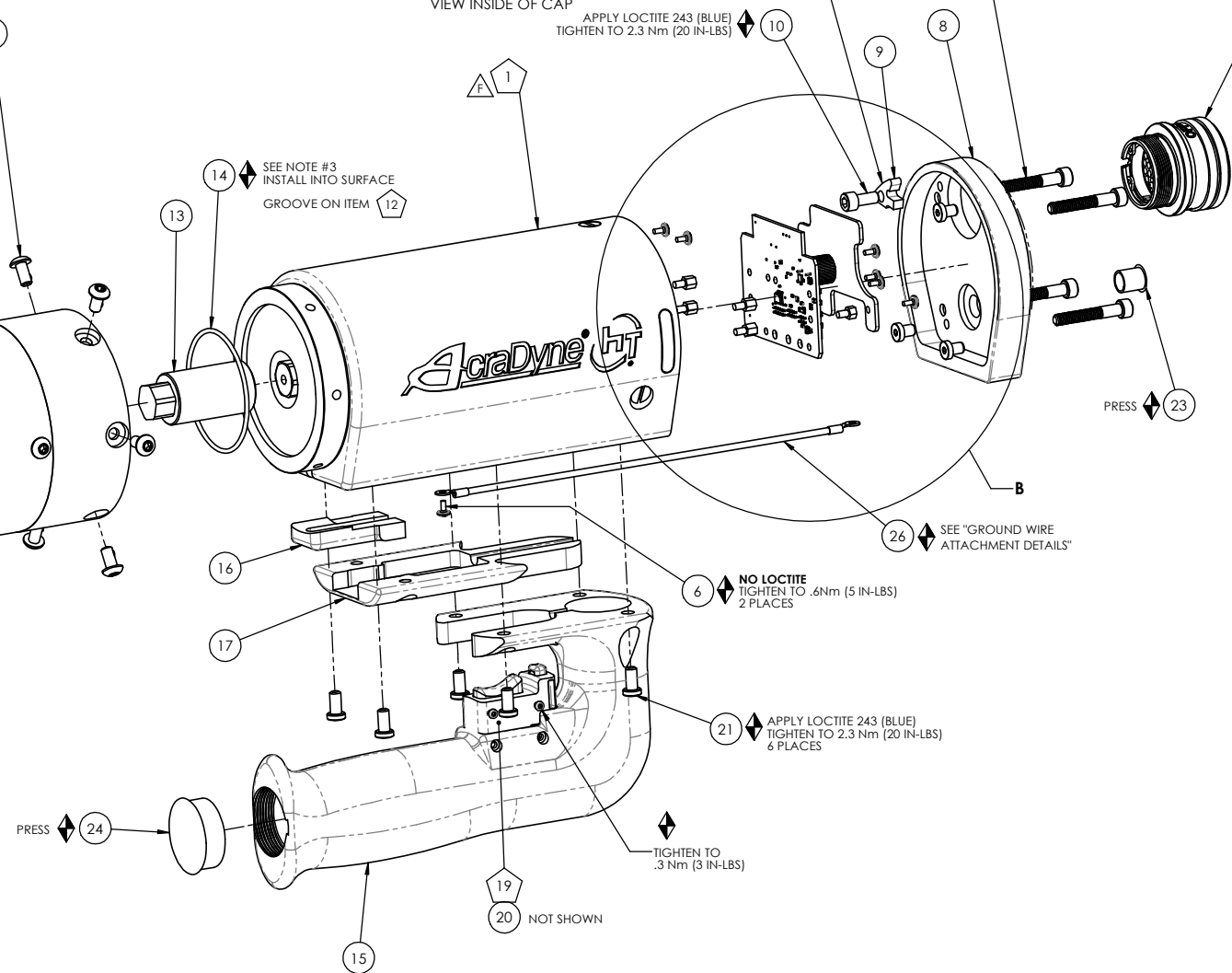

GROUND WIRE ATTACHMENT DETAILS

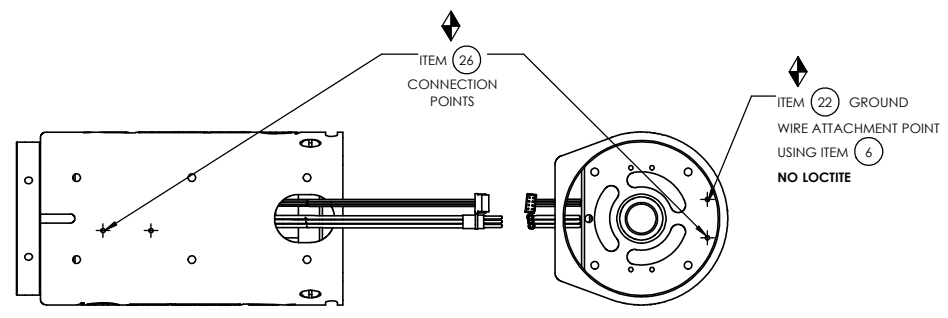

COMMENTS	ITEM NO.	PART NUMBER	QTY.	DESCRIPTION
	1	32429	1	MOTOR ASM. W/LED LENSES & FOIL SEAL
	2	29335	4	STANDOFF, M-F, 4-40 X 3/16, SS
	3	27797	1	TID BOARD, POPULATED W/O AMP CIRCUIT
	4	29337	3	STANDOFF, M-F, 4-40 X 1/8, SS
	5	29338	1	TID WIRE INSULATOR
	6	25573	7	SCREW PHP 4-40 X 3/16 18-8 SS
	7	24859	3	LHSC 10-32 X 1/4 BLK OXIDE
	8	25225	1	END GRIP CAP, HT TOOLS
	9	27063	1	TOOL CONNECTOR CLIP
	10	26458	1	SCREW, SHC 10-32 X .44 LG., STEEL, BLACK OXIDE
	11	25568	4	SHC 10-32 x 1.25 BLK OXIDE
	12	SEE CHART	1	GEARBOX AND CLUTCH ASM.
	13	27980	1	SLIP RING PINION ADAPTER
	14	26080	1	O-RING, LED LIGHT RING COVER
	15	25229	1	AXIAL HANDLE, HT TOOLS
	16	25985	1	TRANSDUCER WIRE COVER FOR MOD 25232
	17	25984	1	TRANSDUCER WIRE TRAY
	18	29279	6	SCREW, BHSC, 10-32 x 3/8, TORX HEAD, NYLON PELL-IT, STEEL
	19	25212	1	SWITCH SUB-ASSEMBLY
NOT SHOWN	20	25582	1	TRIGGER CABLE
	21	25569	6	SCREW LHCS 10-32 X 3/8 18-8 SS
	22	25507	1	TOOL CONNECTOR ASM HERC PISTOL
	23	25579	1	PLUG 3/8"
	24	24858	1	PLUG 1 3/16
	25	26898	1	CHOOSE REACTION BAR
	26	31412	1	GROUND WIRE ASSEMBLY, 18 AWG, 8000 & 9000 HT SERIES
NOT SHOWN	27	28257	4	CABLE TIE, 1.65MM W X 71MM LG
NOT SHOWN	28	24177	A/R	RTV 108 TRANSLUCENT

NOTE: SEE WORK INSTRUCTION DOCUMENT "W2047" FOR COMPLETE ASSEMBLY INSTRUCTIONS

MODEL NO.	GEARBOX/CLUTCH ASM.
AEJ48884200B1	31854.001
AEJ48884200B	31855.001
AEJ48885000B1	31854.002
AEJ48885000B	31855.002
AEJ4W885000B1	32389
AEJ4W885000B	32401

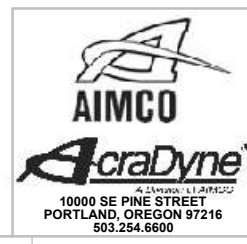

DOCUMENT CONTROL
PRINTED COPIES OF THIS DOCUMENT ARE CONSIDERED TO BE UNCONTROLLED DOCUMENTS. HOLDERS ARE RESPONSIBLE FOR VERIFYING THE CURRENT REVISION LEVEL WITH PURCHASING OR ENGINEERING PRIOR TO USE OR FABRICATION. THE CONTROLLED VERSION OF THIS DOCUMENT IS ELECTRONICALLY MAINTAINED.

PROPRIETARY AND CONFIDENTIAL
THIS DRAWING CONTAINS INFORMATION STRICTLY CONFIDENTIAL TO ACRADYNE/AIMCO. IN THE ABSENCE OF EXPRESSED WRITTEN PERMISSION, ACRADYNE/AIMCO HAS LOANED THIS COPY WITH THE MUTUAL UNDERSTANDING THAT (A) IT WILL NOT BE USED FOR ANY PURPOSE OTHER THAN FOR THAT IN WHICH IT WAS PROVIDED, (B) THE DATA CONTAINED HEREIN WILL NOT BE DISCLOSED TO OTHERS, (C) IT WILL NOT BE REPRODUCED, AND (D) IT WILL BE RETURNED TO ACRADYNE/AIMCO IMMEDIATELY UPON DEMAND.

REVISION LEVEL	REVISION RELEASE DATE	DESCRIPTION OF CHANGES MADE TO PART	ECN #	AUTHOR/ APPROVAL
		CLUTCH/GEARBOX ASSEMBLY IN CHART WAS GEARBOX ASSEMBLY		

UNLESS OTHERWISE SPECIFIED, DIMENSIONS ARE IN INCHES
DIMENSIONS AND TOLERANCING PER ANSI Y14.5 SURFACE ROUGHNESS PER ANSI Y14.36

BLOCK TOLERANCING PER DECIMAL:
X = ±.030 XX = ±.010 XXX = ±.005 XXXX = ±.0005
ANGLE = ±0° 30'

REMOVE BURRS AND SHARP EDGES: R.015 MAX MACHINE SURFACE FINISH: 125 RMS OR BETTER

DRAWINGS AND TECHNICAL DOCUMENTS CONTROLLED BY:
ACRADYNE MECHANICAL ENGINEERING

"J" HANDLE NUTRUNNER W/SLIP RING CLUTCH 8000 SERIES

SIZE	PART / DRAWING NUMBER	REVISION
D	AEJ4 88 B	F

SCALE: 2-3 DO NOT SCALE DRAWING SHEET 1 OF 2

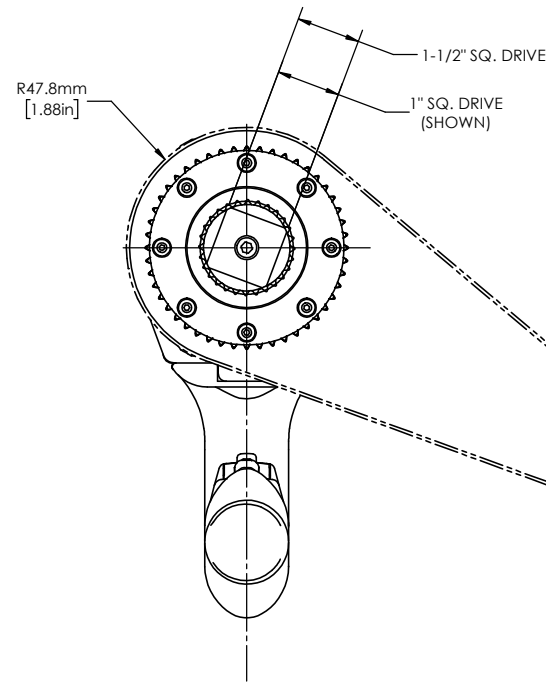
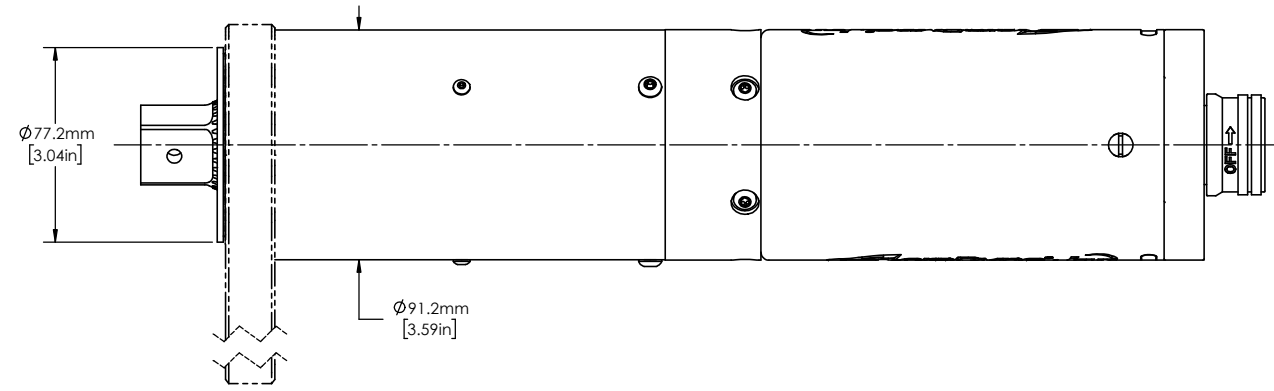

NOTE:
REACTION BAR GEOMETRY
TO CHANGE DEPENDING
ON REACTION BAR CHOSEN

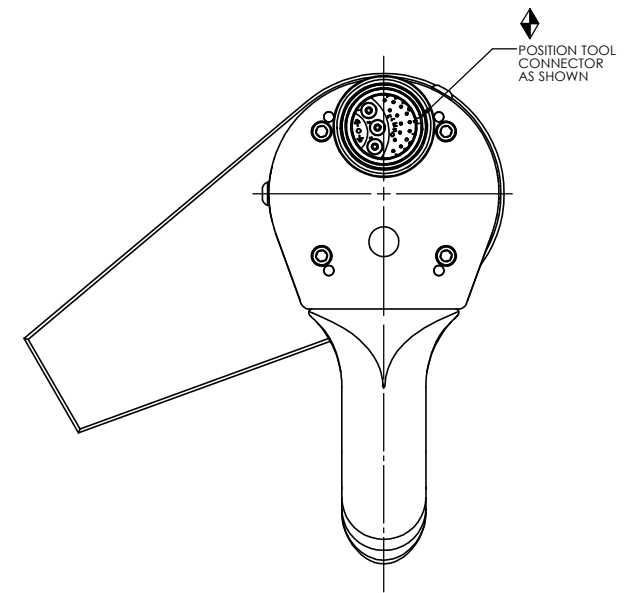
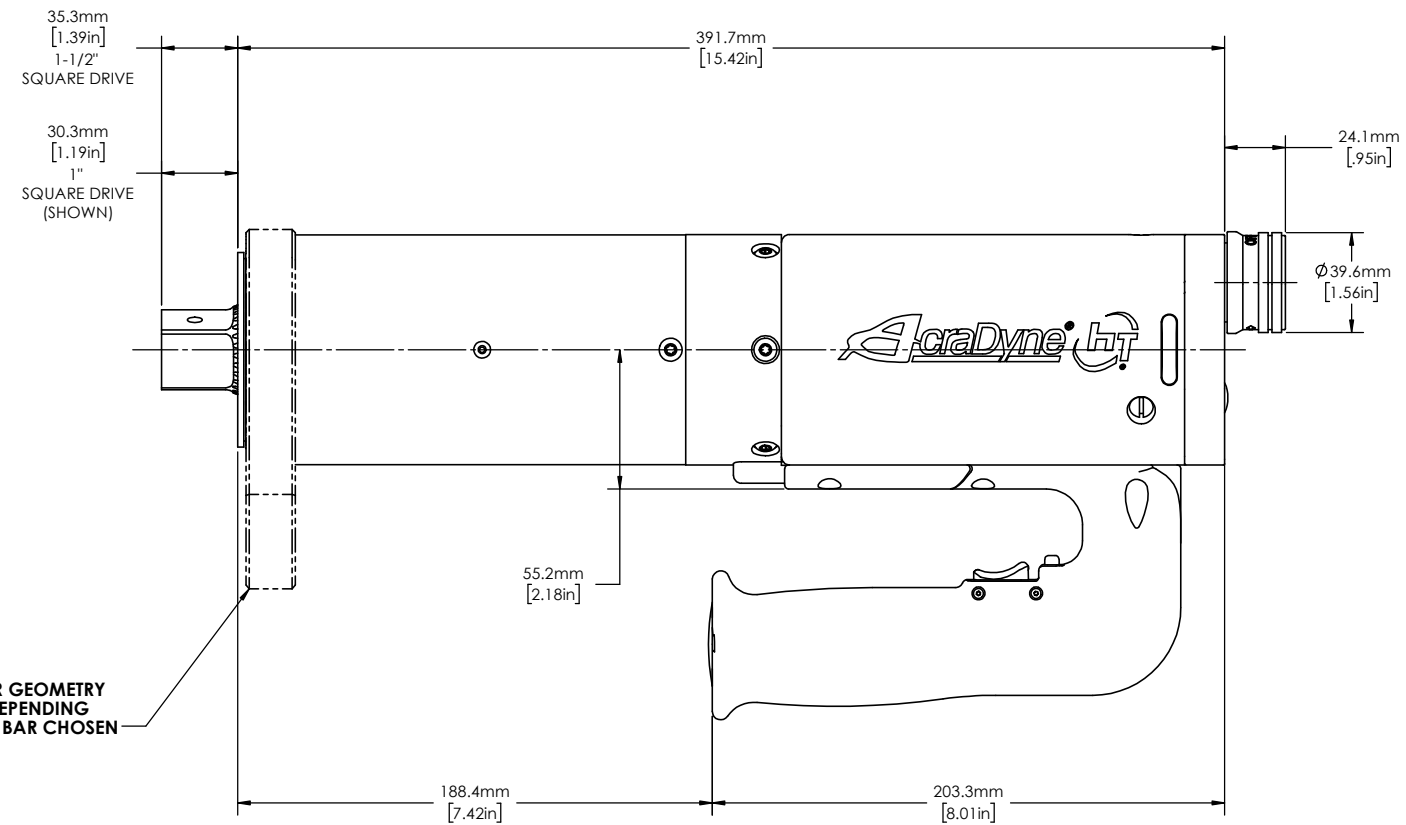

MODEL NO.	SQUARE DRIVE
AEJ4B884200B	1-1/2"
AEJ4B884200B1	1"
AEJ4B885000B	1-1/2"
AEJ4B885000B1	1"
AEJ4W885000B	1-1/2"
AEJ4W885000B1	1"



DOCUMENT CONTROL
PRINTED COPIES OF THIS DOCUMENT ARE CONSIDERED TO BE UNCONTROLLED DOCUMENTS. HOLDERS ARE RESPONSIBLE FOR VERIFYING THE CURRENT REVISION LEVEL WITH PURCHASING OR ENGINEERING PRIOR TO USE OR FABRICATION. THE CONTROLLED VERSION OF THIS DOCUMENT IS ELECTRONICALLY MAINTAINED.

PROPRIETARY AND CONFIDENTIAL
THIS DRAWING CONTAINS INFORMATION STRICTLY CONFIDENTIAL TO ACRADYNE/AIMCO. IN THE ABSENCE OF EXPRESSED WRITTEN PERMISSION, ACRADYNE/AIMCO HAS LOANED THIS COPY WITH THE MUTUAL UNDERSTANDING THAT (A) IT WILL NOT BE USED FOR ANY PURPOSE OTHER THAN FOR THAT IN WHICH IT WAS PROVIDED, (B) THE DATA CONTAINED HEREIN WILL NOT BE DISCLOSED TO OTHERS, (C) IT WILL NOT BE REPRODUCED, AND (D) IT WILL BE RETURNED TO ACRADYNE/AIMCO IMMEDIATELY UPON DEMAND.

REVISION LEVEL	REVISION RELEASE DATE	DESCRIPTION OF CHANGES MADE TO PART	ECN #	AUTHOR/ APPROVAL

UNLESS OTHERWISE SPECIFIED, DIMENSIONS ARE IN INCHES
DIMENSIONS AND TOLERANCING PER ANSI Y14.5
SURFACE ROUGHNESS PER ANSI Y14.36

BLOCK TOLERANCING PER DECIMAL:
X = ±.030 .XX = ±.010 .XXX = ±.005 .XXXX = ±.0005
ANGLE = ±0° 30'

REMOVE BURRS AND SHARP EDGES: R.015 MAX
MACHINE SURFACE FINISH: 125 RMS OR BETTER

DRAWINGS AND TECHNICAL DOCUMENTS CONTROLLED BY:
ACRADYNE MECHANICAL ENGINEERING

**"J" HANDLE NUTRUNNER
W/SLIP RING CLUTCH
8000 SERIES**

SIZE	PART / DRAWING NUMBER	REVISION
D	AEJ4 88	B F
SCALE: 1:8	DO NOT SCALE DRAWING	SHEET 2 OF 2