

MODEL NO.	GEAR BOX ASM.
AEJ4A884200B	28112
AEJ4A884200B1	28113
AEJ4A885000B	28112
AEJ4A885000B1	28113

ITEM	PART NUMBER	QTY.	DESCRIPTION	
1	26160	1	MOTOR ASM.	
2	27714	1	O-RING 3" ID	
3	24840	1	FOIL SEAL 2" DIA	
4	27796	1	TID BOARD, POPULATED W/AMP CIRCUIT	
5	25490	2	LENS, LED, INJECTION MOLDED	
6	29335	4	STANDOFF, M-F, 4-40 X 3/16, SS	
7	29338	1	TID WIRE INSULATOR	
8	25573	8	SCREW PHP 4-40 X 3/16 18-8 SS	
9	29279	3	SCREW, BHSC, 10-32 X 3/8, TORX HEAD, NYLON PELL-IT, STEEL	
10	29337	3	STANDOFF, M-F, 4-40 X 1/8, SS	
11	SEE CHART	1	GEARBOX ASM.	
12	25225	1	END GRIP CAP, HT TOOLS	
13	25507	1	TOOL CONNECTOR ASM HERC PISTOL	
14	27063	1	TOOL CONNECTOR CLIP	
15	26458	1	SCREW, SHC 10-32 X .44 LG., STEEL, BLACK OXIDE	
NOT SHOWN	16	A/R	CABLE TIE, 1.65MM W X 71MM LG.	
17	25229	1	AXIAL HANDLE, HT TOOLS	
18	24858	1	PLUG 1 3/16	
19	25212	1	SWITCH SUB-ASSEMBLY	
NOT SHOWN	20	25582	1	TRIGGER CABLE
21	25569	6	SCREW LHCS 10-32 X 3/8 18-8 SS	
22	25232	1	HT TOOL AXIAL GRIP SPACER	
23	25568	4	SHC 10-32 X 1.25 BLK OXIDE	
24	29284	3	SCREW, BHSC, 10-32 X 1/2 TORX HEAD, NYLON PELL-IT, STEEL	
25	25564	3	WASHER SHIM .093THK .25ID .375OD	
26	28211	1	(4) LINE MALE/FEMALE JUMPER ASM.	
27	25218	3	SCREW, BHSC, 6-32 X 5/16, SS	
28	25579	1	PLUG 3/8"	
29	25284	1	HT TOOL TRANSDUCER SLEEVE	
30	26898	1	CHOOSE REACTION BAR	
31	24859	3	LHSC 10-32 X 1/4 BLK OXIDE	
32	31412	1	GROUND WIRE ASSEMBLY, 18 AWG, 8000 & 9000 HT SERIES	
NOT SHOWN	33	24177	A/R	RTV 108, TRANSLUCENT

◆ ASSEMBLY INSTRUCTIONS  
 ◻ SUB-ASSEMBLY

- 1) GEARS & SPLINES: LUBRICATE WITH DOW CORNING MOLYKOTE BR2 PLUS GREASE.
- 2) BEARINGS: LUBRICATE WITH CHEVRON SR1 GREASE
- 3) O-RINGS: LUBRICATE WITH O-RING LUBE



**DOCUMENT CONTROL**  
 PRINTED COPIES OF THIS DOCUMENT ARE CONSIDERED TO BE UNCONTROLLED DOCUMENTS. HOLDERS ARE RESPONSIBLE FOR VERIFYING THE CURRENT REVISION LEVEL WITH PURCHASING OR ENGINEERING PRIOR TO USE OR FABRICATION. THE CONTROLLED VERSION OF THIS DOCUMENT IS ELECTRONICALLY MAINTAINED.

**PROPRIETARY AND CONFIDENTIAL**  
 THIS DRAWING CONTAINS INFORMATION STRICTLY CONFIDENTIAL TO ACRADYNE/AIMCO. IN THE ABSENCE OF EXPRESSED WRITTEN PERMISSION, ACRADYNE/AIMCO HAS LOANED THIS COPY WITH THE MUTUAL UNDERSTANDING THAT (A) IT WILL NOT BE USED FOR ANY PURPOSE OTHER THAN FOR THAT IN WHICH IT WAS PROVIDED, (B) THE DATA CONTAINED HEREIN WILL NOT BE DISCLOSED TO OTHERS, (C) IT WILL NOT BE REPRODUCED, AND (D) IT WILL BE RETURNED TO ACRADYNE/AIMCO IMMEDIATELY UPON DEMAND.

REVISION LEVEL	RELEASE DATE	DESCRIPTION OF CHANGES MADE TO PART	ECN #	APPROVAL

**UNLESS OTHERWISE SPECIFIED, DIMENSIONS ARE IN INCHES**  
 DIMENSIONS AND TOLERANCING PER ANSI Y14.5 SURFACE ROUGHNESS PER ANSI Y14.36

**BLOCK TOLERANCING PER DECIMAL:**  
 .X = ±.030 .XX = ±.010 .XXX = ±.005 .XXXX = ±.0005  
 ANGLE = ±0°30'

REMOVE BURRS AND SHARP EDGES: R.015 MAX MACHINE SURFACE FINISH: 125 RMS OR BETTER

DRAWINGS AND TECHNICAL DOCUMENTS CONTROLLED BY:  
**ACRADYNE MECHANICAL ENGINEERING**

**AEJ4A88 B**  
**"J" HANDLE NUTRUNNER**  
 8000 SERIES

SIZE	PART / DRAWING NUMBER	REVISION
D	AEJ4A88 B	D

SCALE 2:3 DO NOT SCALE DRAWING SHEET 1 OF 2

**NOTE:  
REACTION BAR GEOMETRY  
TO CHANGE DEPENDING  
ON REACTION BAR CHOSEN.**

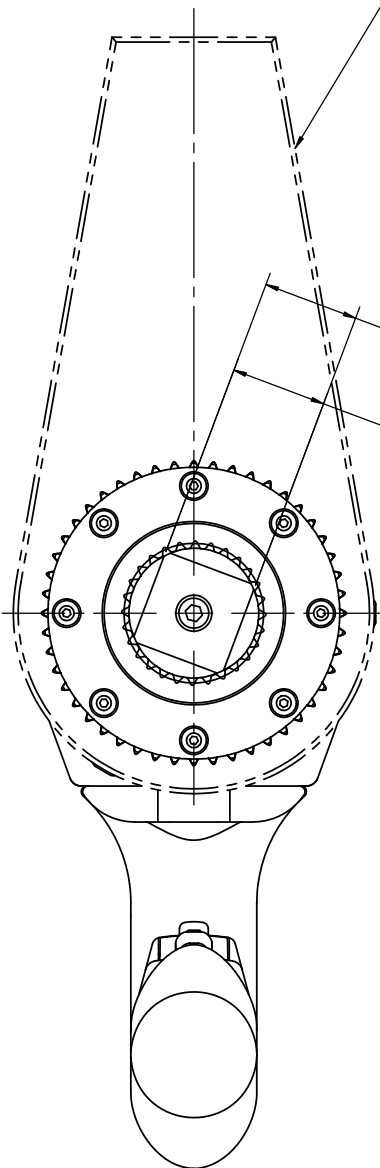

1-1/2"  
SQUARE DRIVE

1"  
SQUARE DRIVE  
(SHOWN)

146.6mm  
[5.77in]

30.3mm  
[1.19in]  
1" SQUARE  
DRIVE  
(SHOWN)

30.3mm  
[1.19in]  
1-1/2" SQUARE  
DRIVE

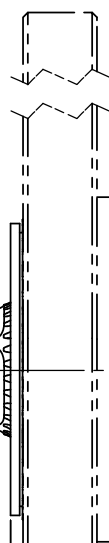

Ø91.2mm  
[3.59in]

150.75mm  
[5.9in]

354.08mm  
[13.9in]

*AcraDyne* HT

25.7mm  
[1.01in]

Ø39.6mm  
[1.56in]

POSITION TOOL CONNECTOR  
AS SHOWN

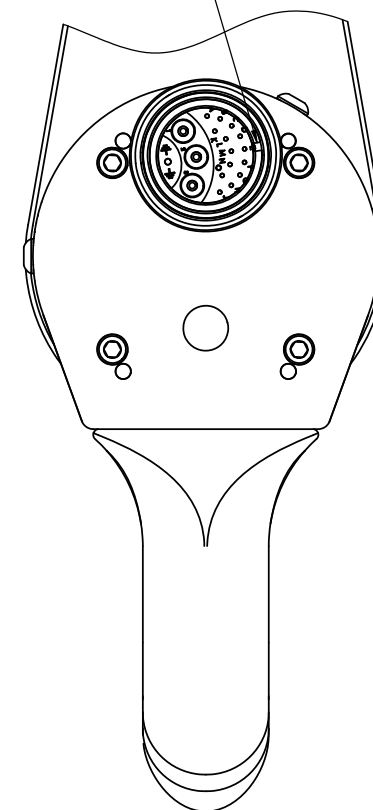

MODEL NO.	SQUARE DRIVE
AEJ4A884200B	1-1/2"
AEJ4A884200B1	1"
AEJ4A885000B	1-1/2"
AEJ4A885000B1	1"



**DOCUMENT CONTROL**  
PRINTED COPIES OF THIS DOCUMENT ARE CONSIDERED TO BE UNCONTROLLED DOCUMENTS. HOLDERS ARE RESPONSIBLE FOR VERIFYING THE CURRENT REVISION LEVEL WITH PURCHASING OR ENGINEERING PRIOR TO USE OR FABRICATION. THE CONTROLLED VERSION OF THIS DOCUMENT IS ELECTRONICALLY MAINTAINED.

**PROPRIETARY AND CONFIDENTIAL**  
THIS DRAWING CONTAINS INFORMATION STRICTLY CONFIDENTIAL TO ACRADYNE/AIMCO. IN THE ABSENCE OF EXPRESSED WRITTEN PERMISSION, ACRADYNE/AIMCO HAS LOANED THIS COPY WITH THE MUTUAL UNDERSTANDING THAT (A) IT WILL NOT BE USED FOR ANY PURPOSE OTHER THAN FOR THAT IN WHICH IT WAS PROVIDED, (B) THE DATA CONTAINED HEREIN WILL NOT BE DISCLOSED TO OTHERS, (C) IT WILL NOT BE REPRODUCED, AND (D) IT WILL BE RETURNED TO ACRADYNE/AIMCO IMMEDIATELY UPON DEMAND.

REVISION LEVEL	REVISION RELEASE DATE	DESCRIPTION OF CHANGES MADE TO PART	ECN #	AUTHOR/ APPROVAL

**UNLESS OTHERWISE SPECIFIED,  
DIMENSIONS ARE IN INCHES**  
DIMENSIONS AND TOLERANCING PER ANSI Y14.5  
SURFACE ROUGHNESS PER ANSI Y14.36

**BLOCK TOLERANCING PER DECIMAL:**  
.X = ±.030 .XX = ±.010 .XXX = ±.005 .XXXX = ±.0005  
ANGLE = ±0° 30'

REMOVE BURRS AND SHARP EDGES: R.015 MAX  
MACHINE SURFACE FINISH: 125 RMS OR BETTER

DRAWINGS AND TECHNICAL DOCUMENTS CONTROLLED BY:  
**ACRADYNE MECHANICAL ENGINEERING**

**"J" HANDLE NUTRUNNER  
8000 SERIES**

SIZE	PART / DRAWING NUMBER	REVISION
D	AEJ4A88 B	D

SCALE: 1:1 DO NOT SCALE DRAWING SHEET 2 OF 2