

GROUND WIRE ATTACHMENT DETAILS

MODEL NO.	GEARBOX ASM.
AEF4A896500BB	28114
AEF4A898100BB	28115

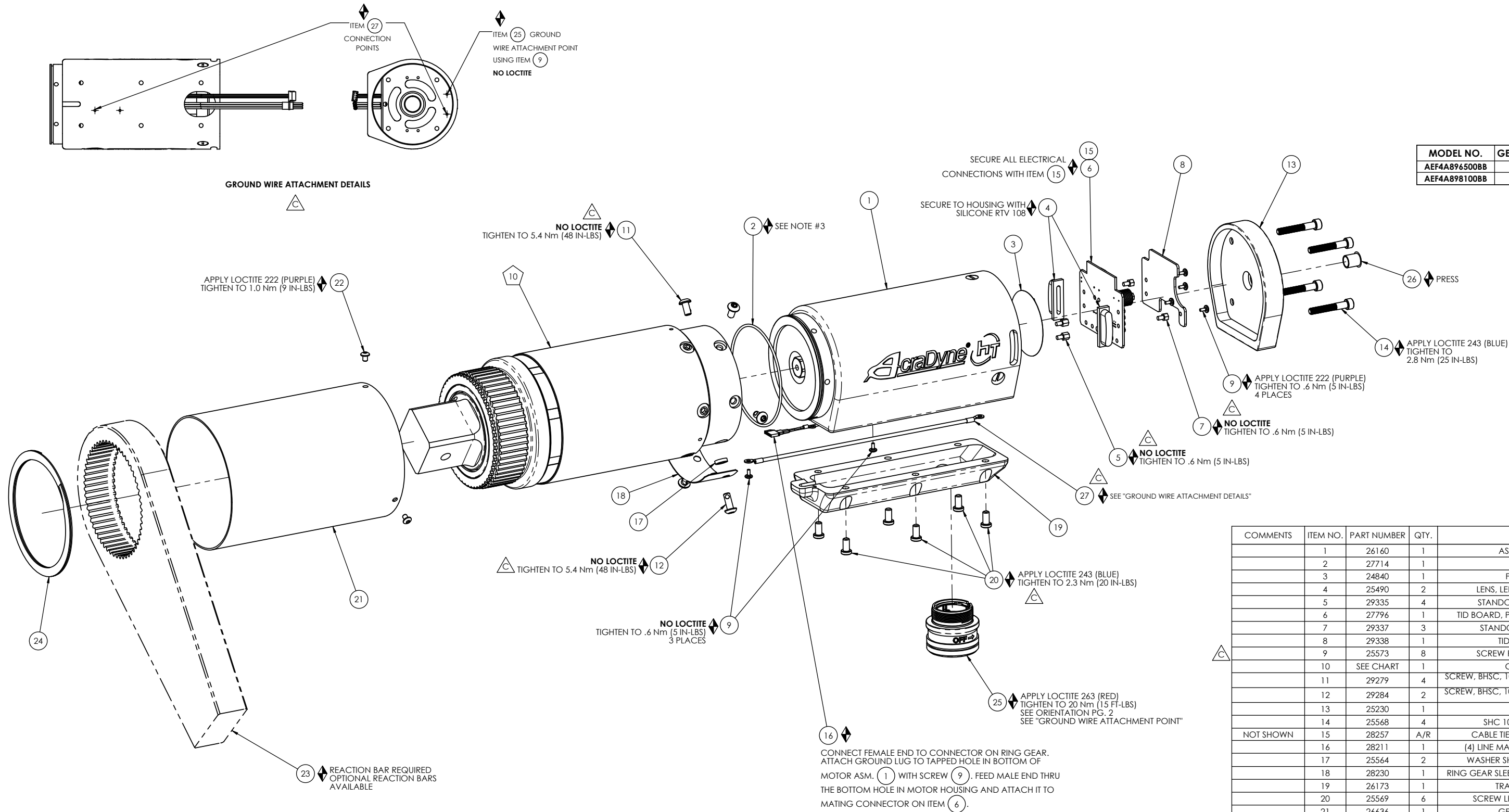

COMMENTS	ITEM NO.	PART NUMBER	QTY.	DESCRIPTION
	1	26160	1	ASSY, MOTOR, 4650
	2	27714	1	O-RING 3" ID
	3	24840	1	FOIL SEAL 2" DIA
	4	25490	2	LENS, LED, INJECTION MOLDED
	5	29335	4	STANDOFF, M-F, 4-40 X 3/16, SS
	6	27796	1	TID BOARD, POPULATED W/AMP CIRCUIT
	7	29337	3	STANDOFF, M-F, 4-40 X 1/8, SS
	8	29338	1	TID WIRE INSULATOR
	9	25573	8	SCREW PHP 4-40 X 3/16 18-8 SS
	10	SEE CHART	1	GEAR BOX ASM.
	11	29279	4	SCREW, BHSC, 10-32 x 3/8, TORX HEAD, NYLON PELL-IT, STEEL
	12	29284	2	SCREW, BHSC, 10-32 x 1/2, TORX HEAD, NYLON PELL-IT, STEEL
	13	25230	1	END CAP
	14	25568	4	SHC 10-32 x 1.25 BLK OXIDE
NOT SHOWN	15	28257	A/R	CABLE TIE, 1.65MM W X 71MM LG
	16	28211	1	(4) LINE MALE/FEMALE JUMPER ASM.
	17	25564	2	WASHER SHIM .093THK .25ID .375OD
	18	28230	1	RING GEAR SLEEVE, NON-CLUTCHED, 8100Nm
	19	26173	1	TRAY, WIRE, FIXTURED
	20	25569	6	SCREW LHCS 10-32 X 3/8 18-8 SS
	21	26636	1	GEAR CASE COVER
	22	26319	3	SCREW, BHSC 6-32 X .188, 18-8 SS
	23	26899	1	CHOOSE REACTION BAR
	24	26436	1	RETAINING RING, SPIRAL, Ø3.833 X Ø3.293 X .111
	25	25507	1	TOOL CONNECTOR ASM HERC PISTOL
	26	25579	1	PLUG 3/8"
	27	31412	1	GROUND WIRE ASSEMBLY, 18 AWG, 8000 & 9000 HT SERIES

- ASSEMBLY INSTRUCTIONS
- SUB-ASSEMBLY

- GEARS & SPLINES: LUBRICATE WITH DOW CORNING MOLYKOTE BR2 PLUS GREASE.
- BEARINGS: LUBRICATE WITH CHEVRON SR1 GREASE
- O-RINGS: LUBRICATE WITH O-RING LUBE



DOCUMENT CONTROL
PRINTED COPIES OF THIS DOCUMENT ARE CONSIDERED TO BE UNCONTROLLED DOCUMENTS. HOLDERS ARE RESPONSIBLE FOR VERIFYING THE CURRENT REVISION LEVEL WITH PURCHASING OR ENGINEERING PRIOR TO USE OR FABRICATION. THE CONTROLLED VERSION OF THIS DOCUMENT IS ELECTRONICALLY MAINTAINED.

PROPRIETARY AND CONFIDENTIAL
THIS DRAWING CONTAINS INFORMATION STRICTLY CONFIDENTIAL TO ACRADYNE/AIMCO. IN THE ABSENCE OF EXPRESSED WRITTEN PERMISSION, ACRADYNE/AIMCO HAS LOANED THIS COPY WITH THE MUTUAL UNDERSTANDING THAT (A) IT WILL NOT BE USED FOR ANY PURPOSE OTHER THAN FOR THAT IN WHICH IT WAS PROVIDED, (B) THE DATA CONTAINED HEREIN WILL NOT BE DISCLOSED TO OTHERS, (C) IT WILL NOT BE REPRODUCED, AND (D) IT WILL BE RETURNED TO ACRADYNE/AIMCO IMMEDIATELY UPON DEMAND.

REVISION LEVEL	REVISION RELEASE DATE	DESCRIPTION OF CHANGES MADE TO PART	ECN #	AUTHOR/ APPROVAL

UNLESS OTHERWISE SPECIFIED, DIMENSIONS ARE IN INCHES
DIMENSIONS AND TOLERANCING PER ANSI Y14.5
SURFACE ROUGHNESS PER ANSI Y14.36

BLOCK TOLERANCING PER DECIMAL:
.X = ±.030 .XX = ±.010 .XXX = ±.005 .XXXX = ±.0005
ANGLE = ±0°30'

REMOVE BURRS AND SHARP EDGES: R.015 MAX
MACHINE SURFACE FINISH: 125 RMS OR BETTER

DRAWINGS AND TECHNICAL DOCUMENTS CONTROLLED BY:
ACRADYNE MECHANICAL ENGINEERING

**FIXTURED NUTRUNNER
BOTTOM EXIT
8000 SERIES**

SIZE	PART / DRAWING NUMBER	REVISION
D	AEF4A89_00BB	C

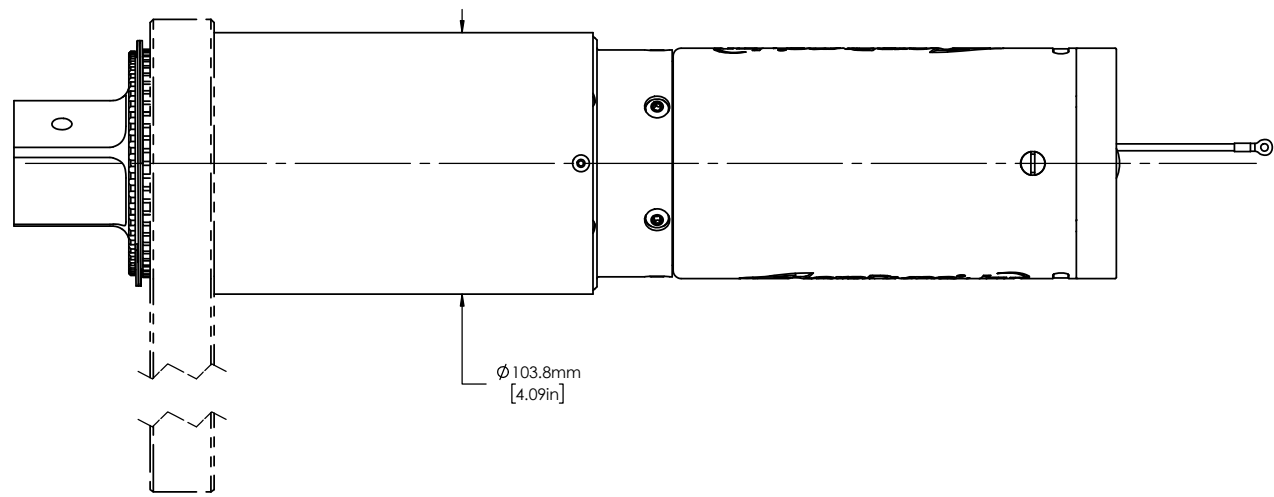

MODEL NO.
AEF4A896500BB
AEF4A898100BB

REACTION BAR GEOMETRY TO CHANGE DEPENDING ON REACTION BAR CHOSEN

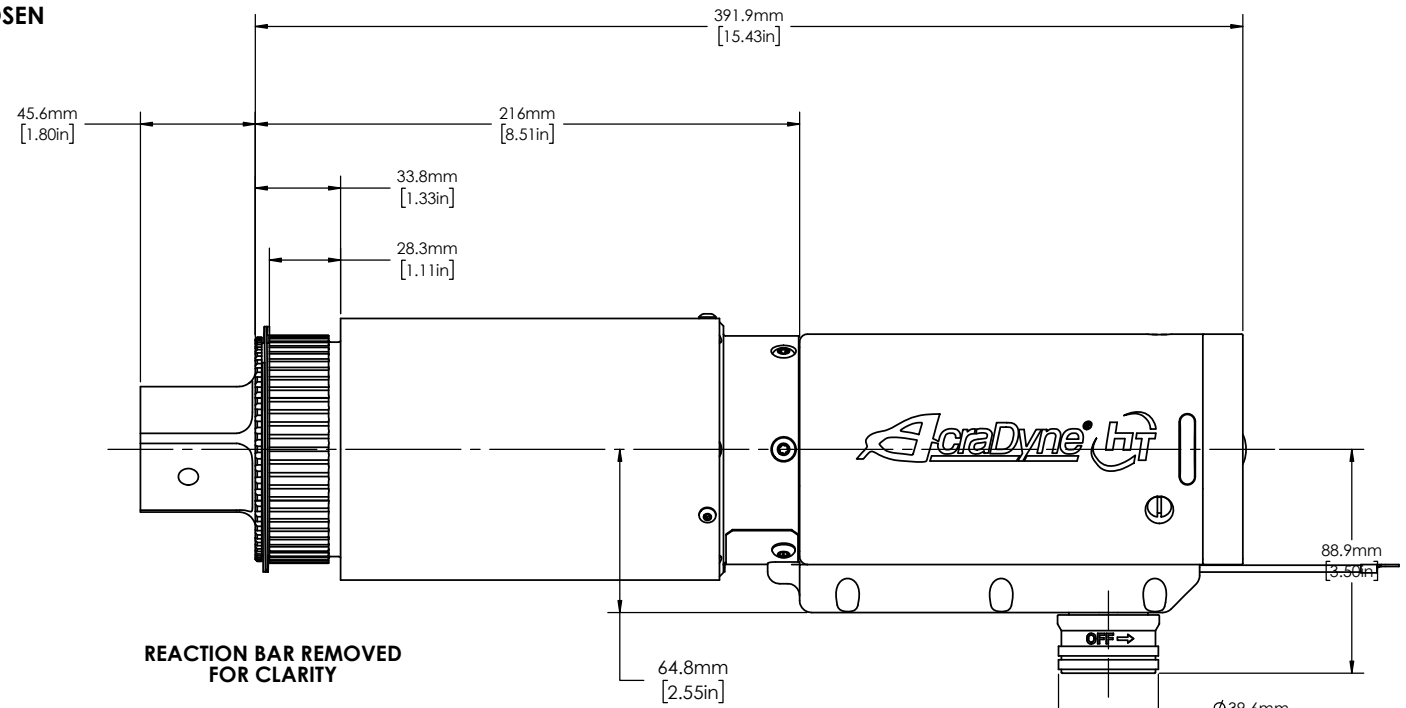
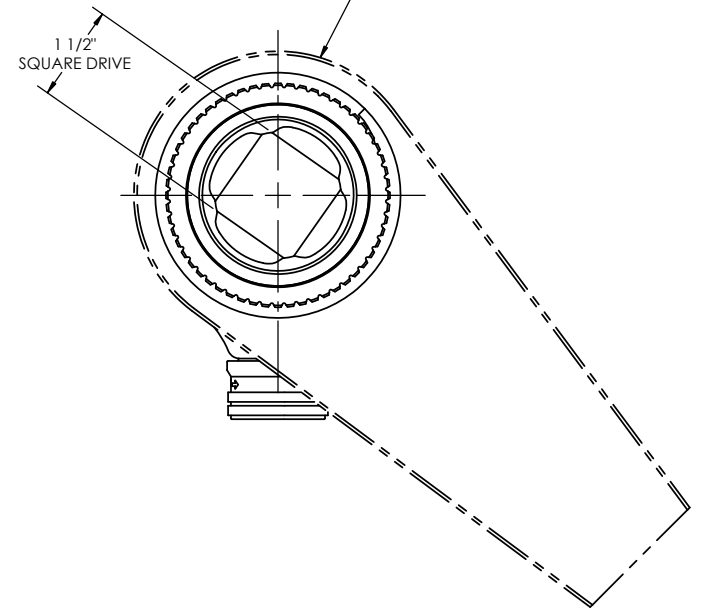

REACTION BAR REMOVED FOR CLARITY

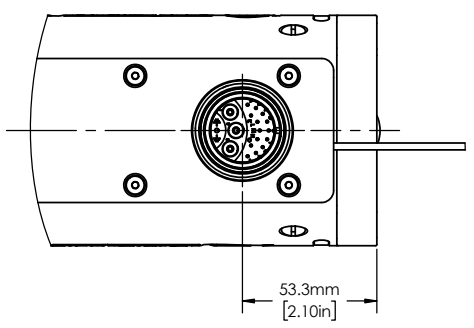
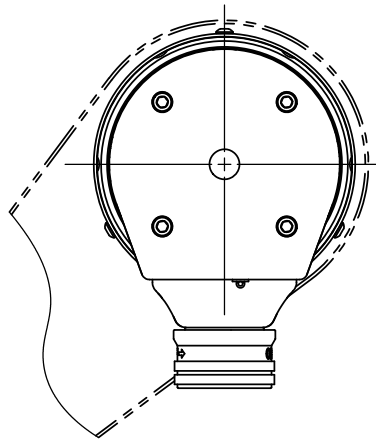

DOCUMENT CONTROL
 PRINTED COPIES OF THIS DOCUMENT ARE CONSIDERED TO BE UNCONTROLLED DOCUMENTS. HOLDERS ARE RESPONSIBLE FOR VERIFYING THE CURRENT REVISION LEVEL WITH PURCHASING OR ENGINEERING PRIOR TO USE OR FABRICATION. THE CONTROLLED VERSION OF THIS DOCUMENT IS ELECTRONICALLY MAINTAINED.

PROPRIETARY AND CONFIDENTIAL
 THIS DRAWING CONTAINS INFORMATION STRICTLY CONFIDENTIAL TO ACRADYNE/AIMCO. IN THE ABSENCE OF EXPRESSED WRITTEN PERMISSION, ACRADYNE/AIMCO HAS LOANED THIS COPY WITH THE MUTUAL UNDERSTANDING THAT (A) IT WILL NOT BE USED FOR ANY PURPOSE OTHER THAN FOR THAT IN WHICH IT WAS PROVIDED, (B) THE DATA CONTAINED HEREIN WILL NOT BE DISCLOSED TO OTHERS, (C) IT WILL NOT BE REPRODUCED, AND (D) IT WILL BE RETURNED TO ACRADYNE/AIMCO IMMEDIATELY UPON DEMAND.

REVISION LEVEL	REVISION RELEASE DATE	DESCRIPTION OF CHANGES MADE TO PART	ECN #	AUTHOR/ APPROVAL

UNLESS OTHERWISE SPECIFIED, DIMENSIONS ARE IN INCHES
 DIMENSIONS AND TOLERANCING PER ANSI Y14.5
 SURFACE ROUGHNESS PER ANSI Y14.36

BLOCK TOLERANCING PER DECIMAL:
 .X = ±.030 .XX = ±.010 .XXX = ±.005 .XXXX = ±.0005
 ANGLE = ±0° 30'

REMOVE BURRS AND SHARP EDGES: R.015 MAX
 MACHINE SURFACE FINISH: 125 RMS OR BETTER

DRAWINGS AND TECHNICAL DOCUMENTS CONTROLLED BY:
ACRADYNE MECHANICAL ENGINEERING

FIXTURED NUTRUNNER BOTTOM EXIT 8000 SERIES		
SIZE	PART / DRAWING NUMBER	REVISION
D	AEF4A89_00BB	C
SCALE: 2:3	DO NOT SCALE DRAWING	SHEET 2 OF 2