

GROUND WIRE ATTACHMENT DETAILS

TOOL MODEL	GEAR BOX ASM.
AEF4A66250B	28658
AEF4A66425B	28798
AEF4A66625B	28108
AEF4A66925B	28109

COMMENTS	ITEM NO.	PART NUMBER	QTY.	DESCRIPTION
	1	26481	1	MOTOR ASM.
	2	26297	1	TRAY, WIRE, "D" & LEVER HANDLE
	3	25574	4	STANDOFF M-F, 4-40x1/4, 3/16 HEX, SS
	4	27727	1	TID BOARD, POPULATED W/AMP
	5	25573	8	SCREW PHP 4-40 X 3/16 18-8 SS
	6	26487	1	O-RING, LED COVER
	7	26483	1	LED COVER
	8	26462	1	END CAP, "J" HANDLE
	9	26206	6	SCREW, BHSC 10-32 X .375, STEEL
	10	26280	1	TOOL CONNECTOR ASM., "J" HANDLE
	11	20534	1	SERIAL/MODEL LABEL
	12	25745	4	SCREW, BHSC 4-40 STEEL, BLACK OXIDE
	13	26299	1	O-RING, PINION
	14	26488	1	O-RING, MOTOR HOUSING
	15	SEE CHART	1	GEAR BOX ASM.
	16	28211	1	(4) LINE MALE/FEMALE JUMPER ASM.
NOT SHOWN	17	27464	A/R	TWISTED WAXED LINEN TWINE
	18	26495	1	GEAR CASE COVER
	19	26319	3	SCREW, BHSC 6-32 X .188, 18-8 SS
	21	26896	1	CHOOSE REACTION BAR
	22	26514	1	RETAINING RING, SPIRAL, Ø2.441 X Ø2.105 X .078
	23	27401	4	SCREW, BHSC 10-32 X 1.25 STEEL, BLACK OXIDE
	24	29337	3	STANDOFF, M-F, 4-40 X 1/8, SS
	25	29336	1	TID BOARD WIRE INSULATOR
	30	29285	6	SCREW, BHSC, 8-32 x .38, TORX HEAD, NYLON PELL-IT, BLK OXIDE
	31	31410	1	GROUND WIRE ASSEMBLY, 18 AWG, 6000 & 7000 HT SERIES

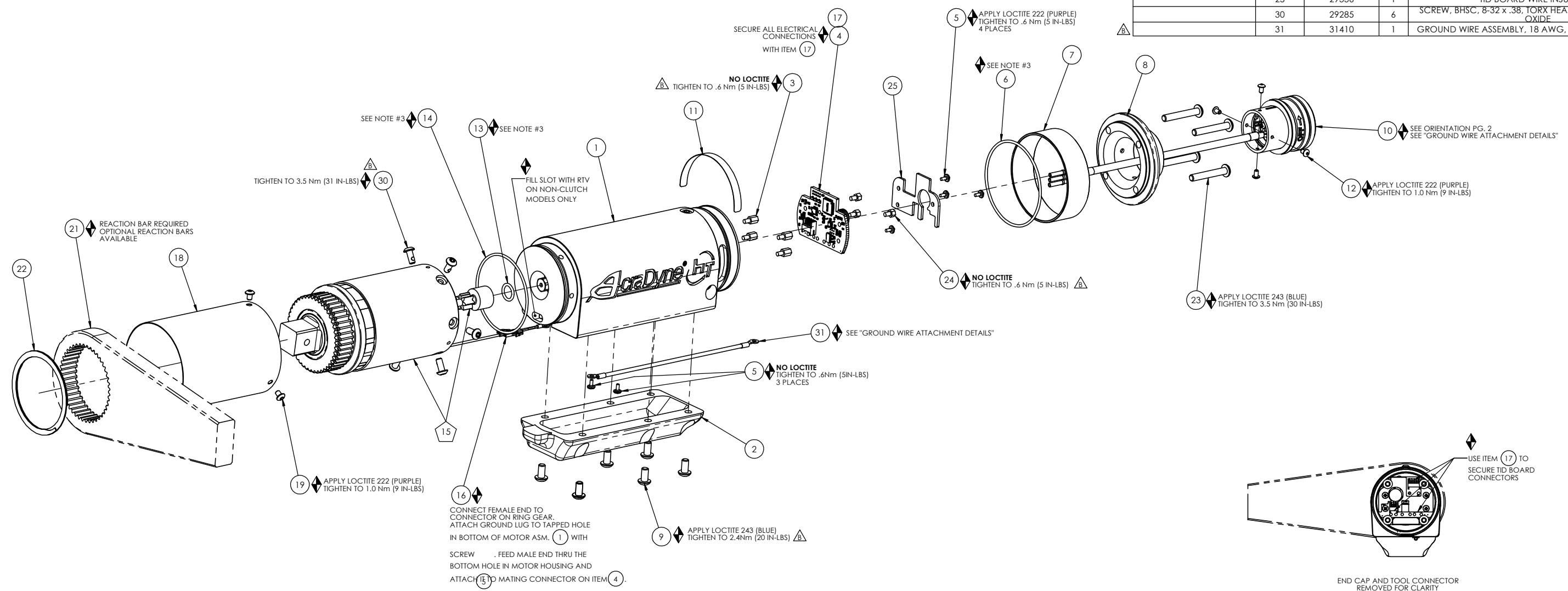

- ◆ ASSEMBLY INSTRUCTIONS
- ◻ SUB-ASSEMBLY

- GEARS & SPLINES: LUBRICATE WITH DOW CORNING MOLYKOTE BR2 PLUS GREASE.
- BEARINGS: LUBRICATE WITH CHEVRON SR1 GREASE
- O-RINGS: LUBRICATE WITH O-RING LUBE



DOCUMENT CONTROL
 PRINTED COPIES OF THIS DOCUMENT ARE CONSIDERED TO BE UNCONTROLLED DOCUMENTS. HOLDERS ARE RESPONSIBLE FOR VERIFYING THE CURRENT REVISION LEVEL WITH PURCHASING OR ENGINEERING PRIOR TO USE OR FABRICATION. THE CONTROLLED VERSION OF THIS DOCUMENT IS ELECTRONICALLY MAINTAINED.

PROPRIETARY AND CONFIDENTIAL
 THIS DRAWING CONTAINS INFORMATION STRICTLY CONFIDENTIAL TO ACRADYNE/AMCO. IN THE ABSENCE OF EXPRESSED WRITTEN PERMISSION, ACRADYNE/AMCO HAS LOANED THIS COPY WITH THE MUTUAL UNDERSTANDING THAT (A) IT WILL NOT BE USED FOR ANY PURPOSE OTHER THAN FOR THAT IN WHICH IT WAS PROVIDED, (B) THE DATA CONTAINED HEREIN WILL NOT BE DISCLOSED TO OTHERS, (C) IT WILL NOT BE REPRODUCED, AND (D) IT WILL BE RETURNED TO ACRADYNE/AMCO IMMEDIATELY UPON DEMAND.

REVISION LEVEL	REVISION RELEASE DATE	DESCRIPTION OF CHANGES MADE TO PART	ECN #	AUTHOR/ APPROVAL

UNLESS OTHERWISE SPECIFIED, DIMENSIONS ARE IN INCHES
 DIMENSIONS AND TOLERANCING PER ANSI Y14.5
 SURFACE ROUGHNESS PER ANSI Y14.36

BLOCK TOLERANCING PER DECIMAL:
 .X = ±.030 .XX = ±.010 .XXX = ±.005 .XXXX = ±.0005
 ANGLE = ±0° 30'

REMOVE BURRS AND SHARP EDGES: R.015 MAX
 MACHINE SURFACE FINISH: 125 RMS OR BETTER

DRAWINGS AND TECHNICAL DOCUMENTS CONTROLLED BY:
ACRADYNE MECHANICAL ENGINEERING

FIXTURED NUTRUNNER 6000-SERIES

SIZE	PART / DRAWING NUMBER	REVISION
D	AEF4A66 B	B

SCALE: 2:3 DO NOT SCALE DRAWING SHEET 1 OF 2

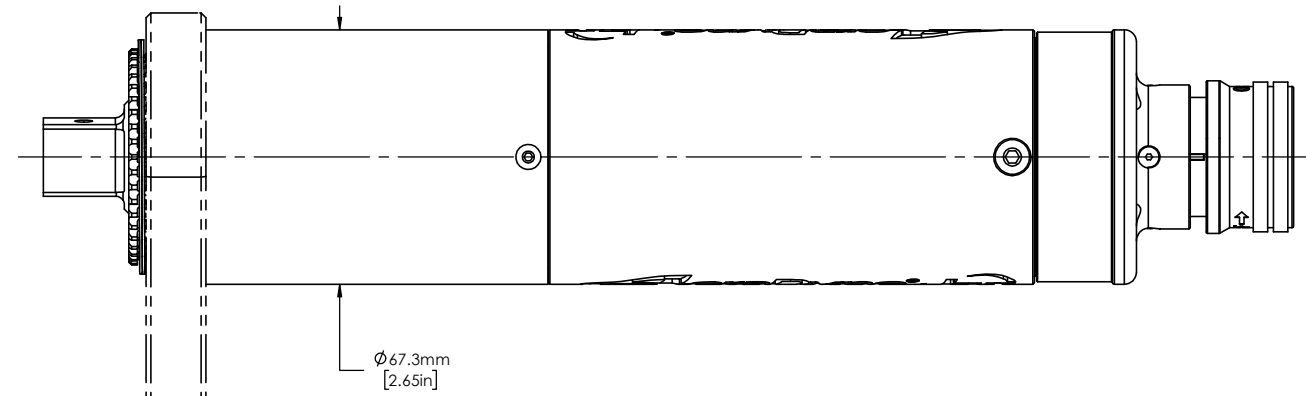

NOTE:
REACTION BAR GENOMETRY
TO CHANGE DEPENDING
ON REACTION BAR CHOSEN

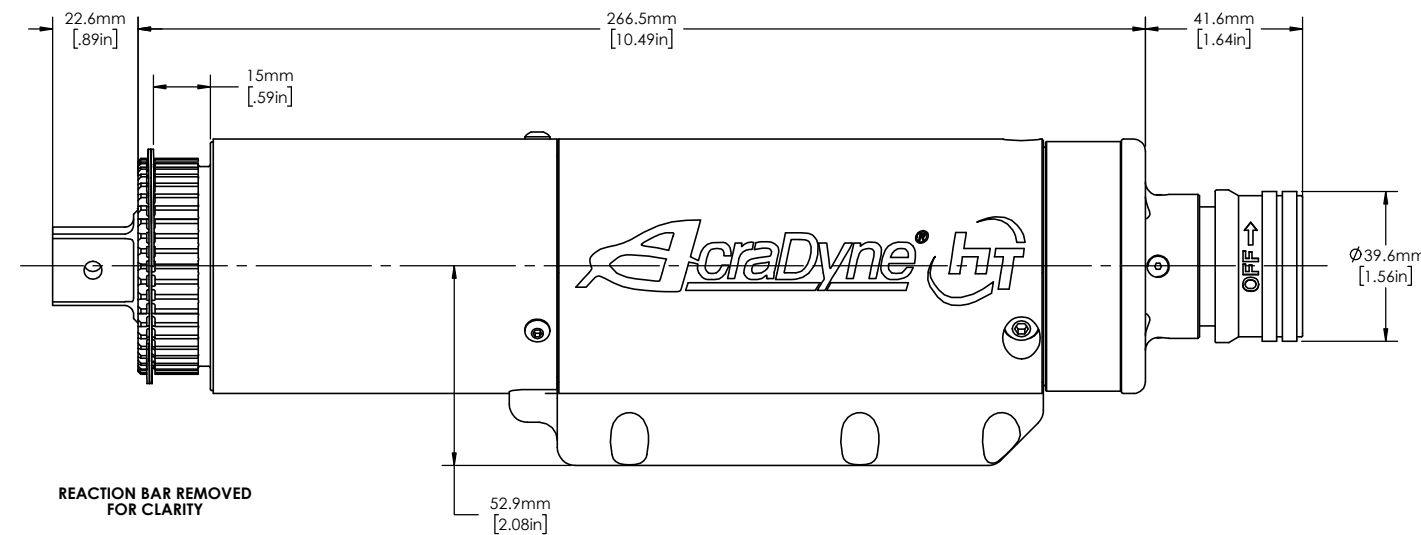
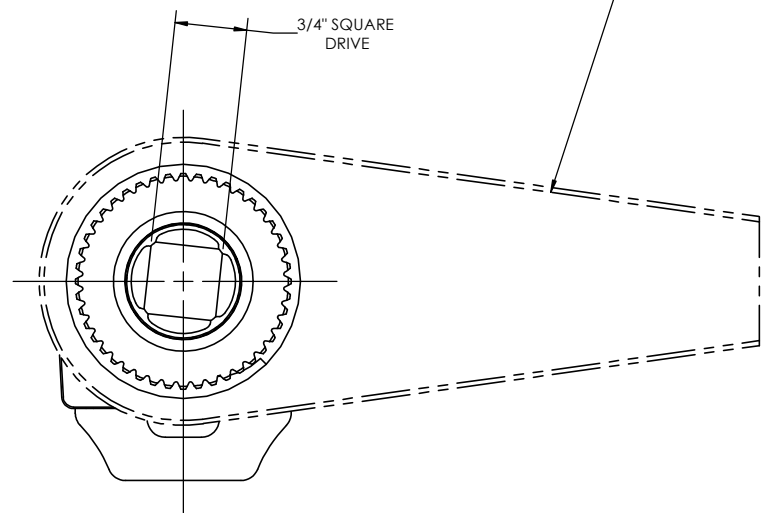

REACTION BAR REMOVED
FOR CLARITY

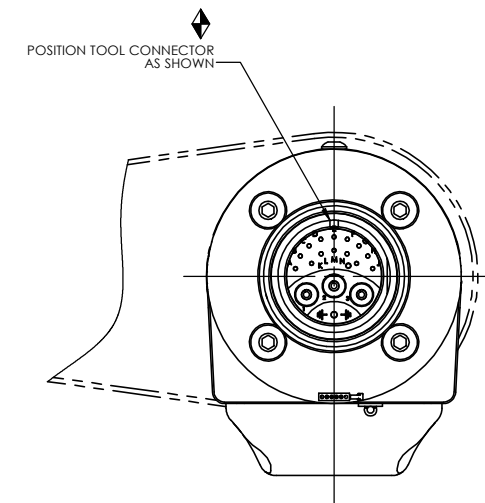

- ASSEMBLY INSTRUCTIONS
- SUB-ASSEMBLY

- 1) GEARS & SPLINES: LUBRICATE WITH DOW CORNING MOLYKOTE BR2 PLUS GREASE.
- 2) BEARINGS: LUBRICATE WITH CHEVRON SR1 GREASE
- 3) O-RINGS: LUBRICATE WITH O-RING LUBE

MODEL NO.
AEF4A66250B
AEF4A66425B
AEF4A66625B
AEF4A66925B



DOCUMENT CONTROL
PRINTED COPIES OF THIS DOCUMENT ARE CONSIDERED TO BE UNCONTROLLED DOCUMENTS. HOLDERS ARE RESPONSIBLE FOR VERIFYING THE CURRENT REVISION LEVEL WITH PURCHASING OR ENGINEERING PRIOR TO USE OR FABRICATION. THE CONTROLLED VERSION OF THIS DOCUMENT IS ELECTRONICALLY MAINTAINED.

PROPRIETARY AND CONFIDENTIAL
THIS DRAWING CONTAINS INFORMATION STRICTLY CONFIDENTIAL TO ACRADYNE/AMCO. IN THE ABSENCE OF EXPRESSED WRITTEN PERMISSION, ACRADYNE/AMCO HAS LOANED THIS COPY WITH THE MUTUAL UNDERSTANDING THAT (A) IT WILL NOT BE USED FOR ANY PURPOSE OTHER THAN FOR THAT IN WHICH IT WAS PROVIDED, (B) THE DATA CONTAINED HEREIN WILL NOT BE DISCLOSED TO OTHERS, (C) IT WILL NOT BE REPRODUCED, AND (D) IT WILL BE RETURNED TO ACRADYNE/AMCO IMMEDIATELY UPON DEMAND.

REVISION LEVEL	REVISION RELEASE DATE	DESCRIPTION OF CHANGES MADE TO PART	ECN #	AUTHOR/ APPROVAL

UNLESS OTHERWISE SPECIFIED, DIMENSIONS ARE IN INCHES
DIMENSIONS AND TOLERANCING PER ANSI Y14.5
SURFACE ROUGHNESS PER ANSI Y14.36

BLOCK TOLERANCING PER DECIMAL:
.X = ±.030 .XX = ±.010 .XXX = ±.005 .XXXX = ±.0005
ANGLE = ±0° 30'

REMOVE BURRS AND SHARP EDGES: R.015 MAX
MACHINE SURFACE FINISH: 125 RMS OR BETTER

DRAWINGS AND TECHNICAL DOCUMENTS CONTROLLED BY:
ACRADYNE MECHANICAL ENGINEERING

**FIXTURED NUTRUNNER
6000-SERIES**

SIZE	PART / DRAWING NUMBER	REVISION
D	AEF4A66_B	B
SCALE 1:2	DO NOT SCALE DRAWING	SHEET 2 OF 2