

MOTOR PINION IS PART OF GEAR TRAIN ASSEMBLY (SHOWN FOR CLARITY)  
LUBRICATE INTERNAL O-RING PER NOTE #3  
AND SLIDE PINION ONTO MOTOR SHAFT  
UNTIL O-RING SEATS IN GROOVE

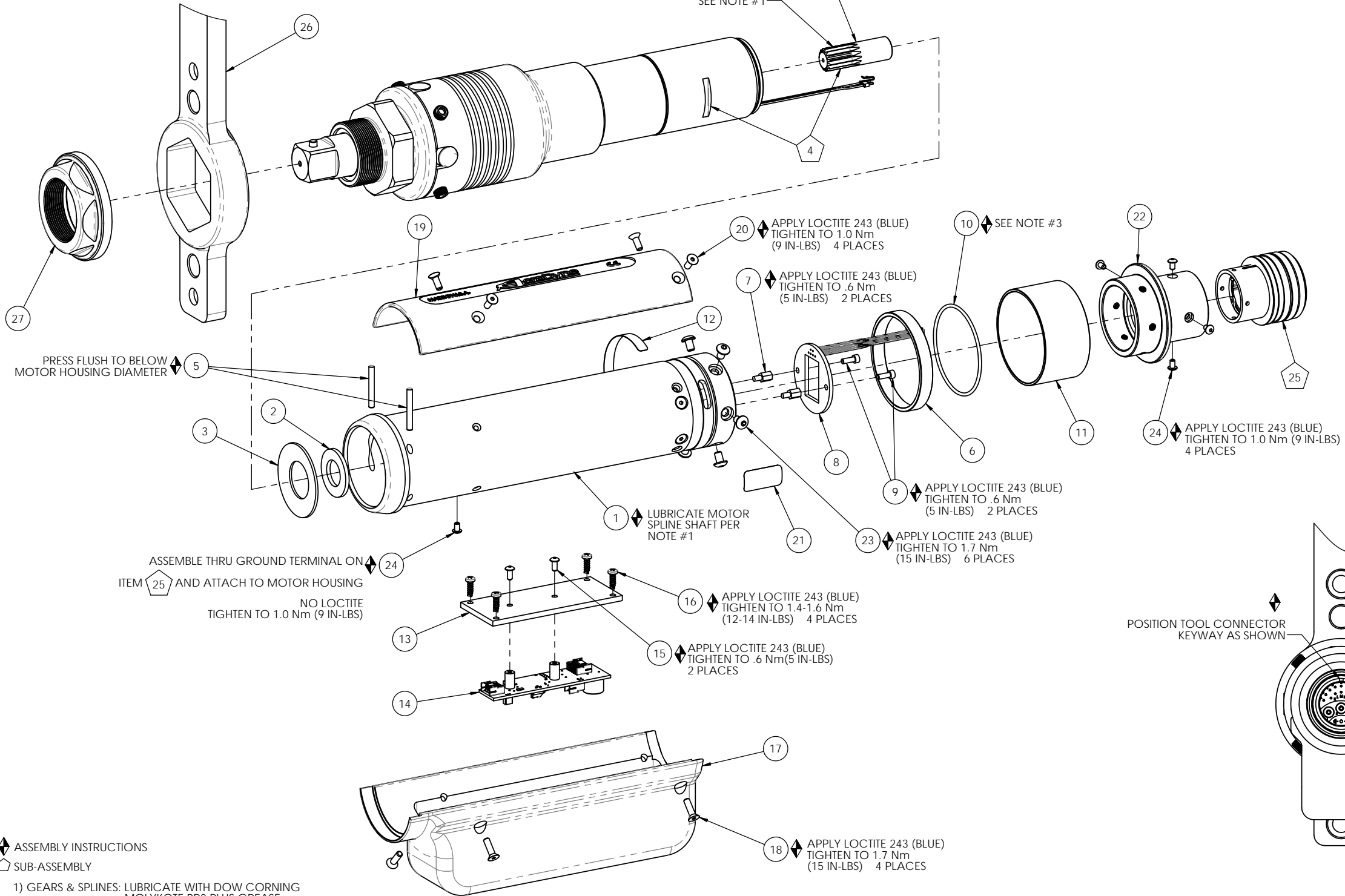

◆ ASSEMBLY INSTRUCTIONS  
◻ SUB-ASSEMBLY

- 1) GEARS & SPLINES: LUBRICATE WITH DOW CORNING MOLYKOTE BR2 PLUS GREASE.
- 2) BEARINGS: LUBRICATE WITH CHEVRON SR1 GREASE
- 3) O-RINGS: LUBRICATE WITH O-RING LUBE

REQUIRED TOOLING
LOCTITE 243 (BLUE)
1/16 HEX WRENCH
5/64 HEX WRENCH
3/32 HEX WRENCH
7/32 HEX WRENCH
#1 PHILLIPS DRIVER

COMMENTS	ITEM NO.	PART NUMBER	QTY.	DESCRIPTION
	1	26213	1	PISTON MOTOR ASSEMBLY
	2	26198	1	THRUST WASHER
	3	26074	1	BELLEVILLE WASHER
	4	SEE CHART	1	GEARBOX ASM. - TRIPLE STEP
	5	26530	2	DOWEL PIN, Ø1/8 x 1.00, STEEL
	6	27391	1	PIN RETAINER RING
	7	25574	2	STANDOFF M-F, 4-40x1/4, 3/16 HEX, SS
	8	26359	1	FIXTURE TOOL LED BOARD ASM.
	9	26078	2	SHC SCREW, 4-40, BLACK OXIDE
	10	26080	1	O-RING, LED LIGHT RING COVER
	11	26079	1	LIGHT RING COVER, LED
	12	20534	1	3000 SERIAL/MODEL LABEL
	13	26397	1	SUPPORT, CIRCUIT BOARD
	14	25847	1	TID BOARD ASM.
	15	26404	2	SCREW, BHSC, 4-40 X 1/4, STEEL
	16	24917	4	BHCS, #4 x .38 LG TAP-TITE
	17	26396	1	HOUSING, CIRCUIT BOARD
	18	26439	4	SCREW, FHSC, 6-32 x .500, STEEL, BLACK OXIDE
	19	26081	1	MOTOR HOUSING COVER
	20	25385	4	SCREW, FHSC 6-32 X .375, STEEL
	21	22141	1	SAFETY LABEL
	22	26398	1	STRAIGHT ADAPTER
	23	26088	6	SCREW, BHCS 8-32X.25, STEEL, BLACK OXIDE
	24	25745	5	SCREW, BHSC 4-40 STEEL, BLACK OXIDE
	25	26407	1	TOOL CONNECTOR ASM., FIXTURED
	26	23793	1	REACTION BAR
	27	23792	1	RETAINING NUT, HEX

MODEL NO.	GEARBOX ASM.
AEF35280A	26202
AEF35350A	26203
AEF35420A	26201
AEF35515A	26200
AEF35635A	26129

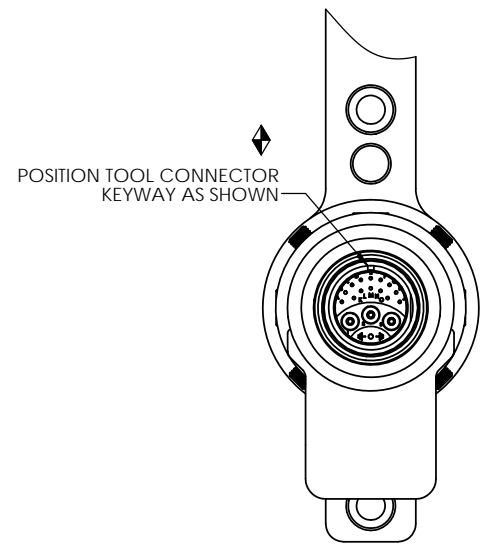

**DOCUMENT CONTROL**  
PRINTED COPIES OF THIS DOCUMENT ARE CONSIDERED TO BE UNCONTROLLED DOCUMENTS. HOLDERS ARE RESPONSIBLE FOR VERIFYING THE CURRENT REVISION LEVEL WITH PURCHASING OR ENGINEERING PRIOR TO USE OR FABRICATION. THE CONTROLLED VERSION OF THIS DOCUMENT IS ELECTRONICALLY MAINTAINED.

**PROPRIETARY AND CONFIDENTIAL**  
THIS DRAWING CONTAINS INFORMATION STRICTLY CONFIDENTIAL TO ACRADYNE/AIMCO. IN THE ABSENCE OF EXPRESSED WRITTEN PERMISSION, ACRADYNE/AIMCO HAS LOANED THIS COPY WITH THE MUTUAL UNDERSTANDING THAT (A) IT WILL NOT BE USED FOR ANY PURPOSE OTHER THAN FOR THAT IN WHICH IT WAS PROVIDED, (B) THE DATA CONTAINED HEREIN WILL NOT BE DISCLOSED TO OTHERS, (C) IT WILL NOT BE REPRODUCED, AND (D) IT WILL BE RETURNED TO ACRADYNE/AIMCO IMMEDIATELY UPON DEMAND.

REVISION LEVEL	REVISION RELEASE DATE	DESCRIPTION OF CHANGES MADE TO PART	ECN #	AUTHOR/ APPROVAL

**UNLESS OTHERWISE SPECIFIED, DIMENSIONS ARE IN INCHES**  
DIMENSIONS AND TOLERANCING PER ANSI Y14.5  
SURFACE ROUGHNESS PER ANSI Y14.36

**BLOCK TOLERANCING PER DECIMAL:**  
.X = ±.030 .XX = ±.010 .XXX = ±.005 .XXXX = ±.0005  
ANGLE = 80°/30°

REMOVE BURRS AND SHARP EDGES: R.015 MAX  
MACHINE SURFACE FINISH: 125 RMS OR BETTER

DRAWINGS AND TECHNICAL DOCUMENTS CONTROLLED BY:  
**ACRADYNE MECHANICAL ENGINEERING**

SIZE	PART / DRAWING NUMBER	REVISION
D	AEF35__ _A	A

SCALE 3:4 DO NOT SCALE DRAWING SHEET 1 OF 2

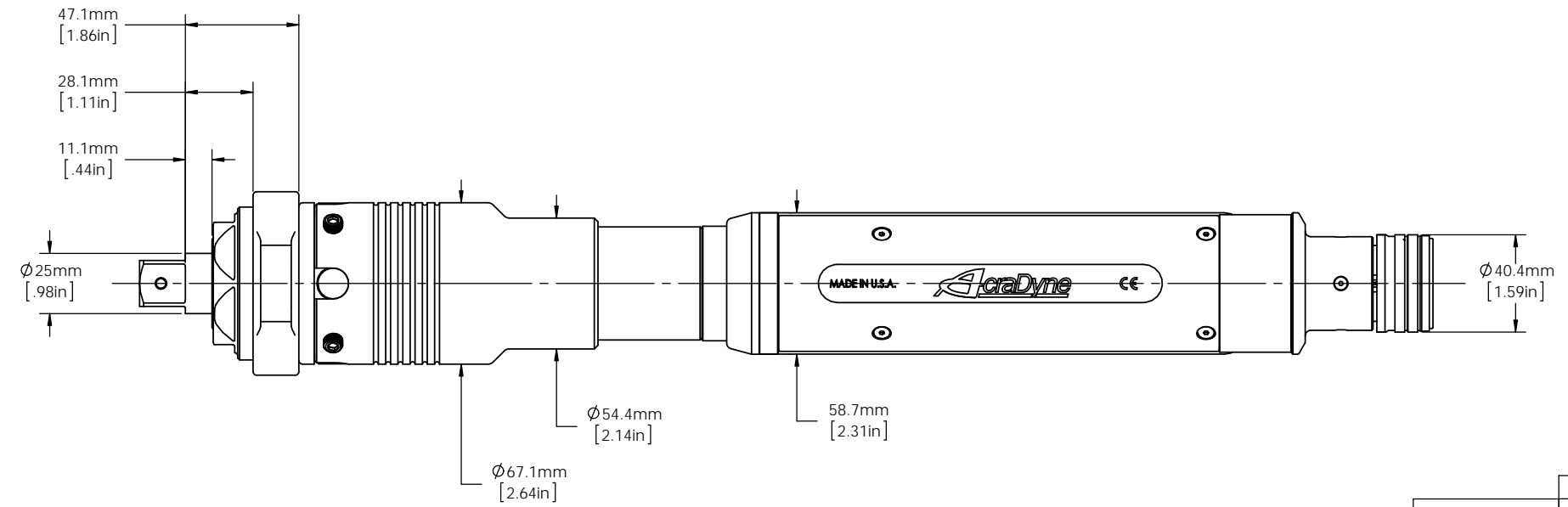
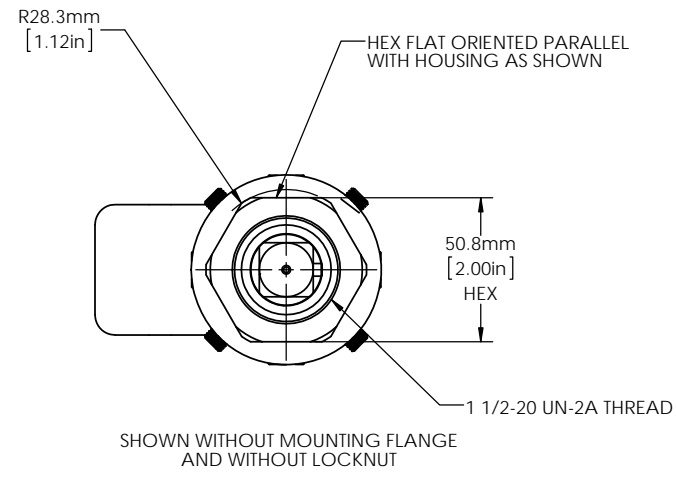

CATALOG NO.	MODEL NO.
	AEF35280A
	AEF35350A
	AEF35420A
	AEF35515A
	AEF35635A

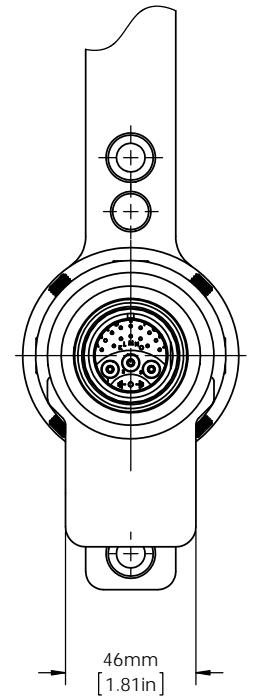
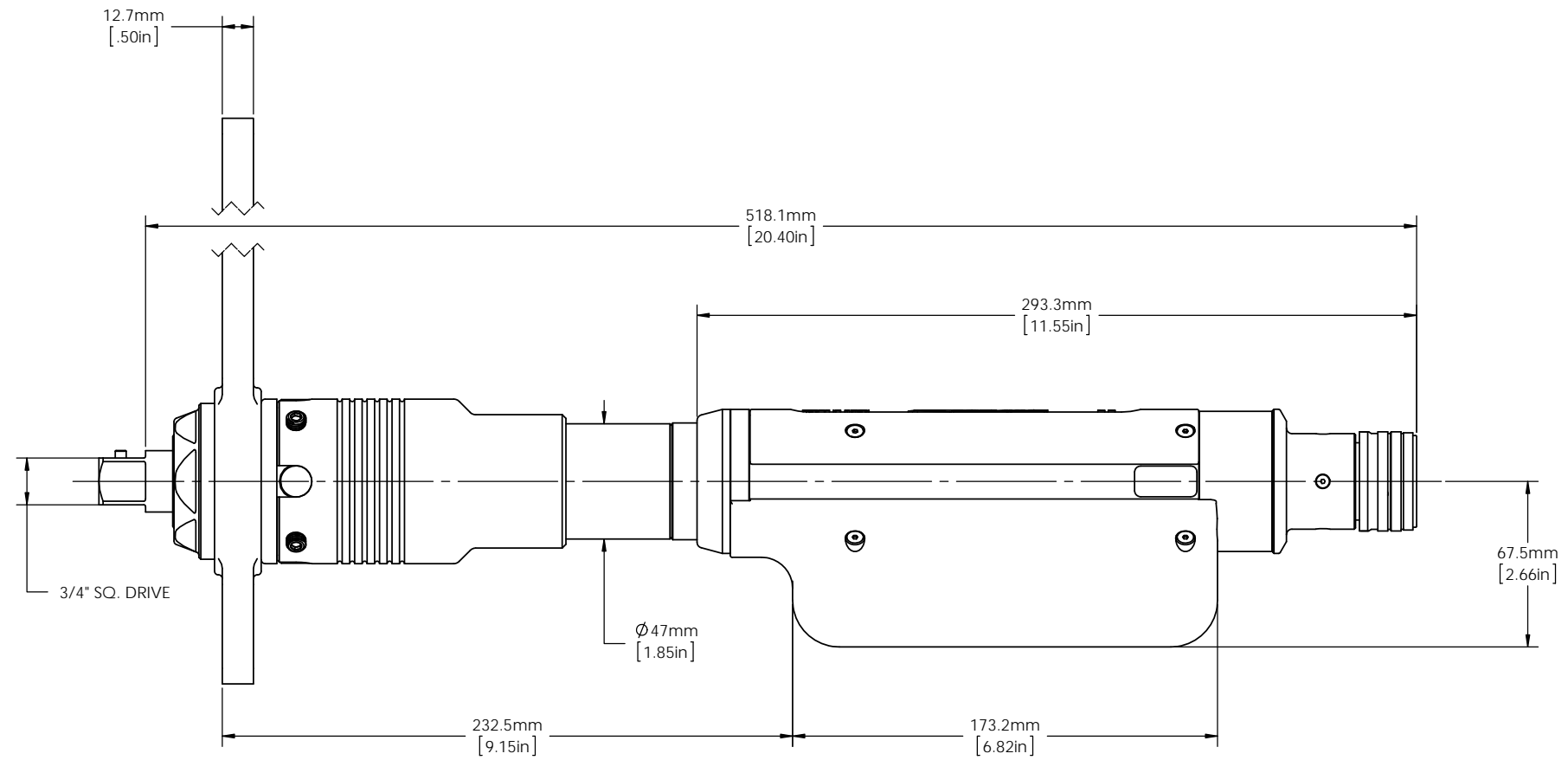
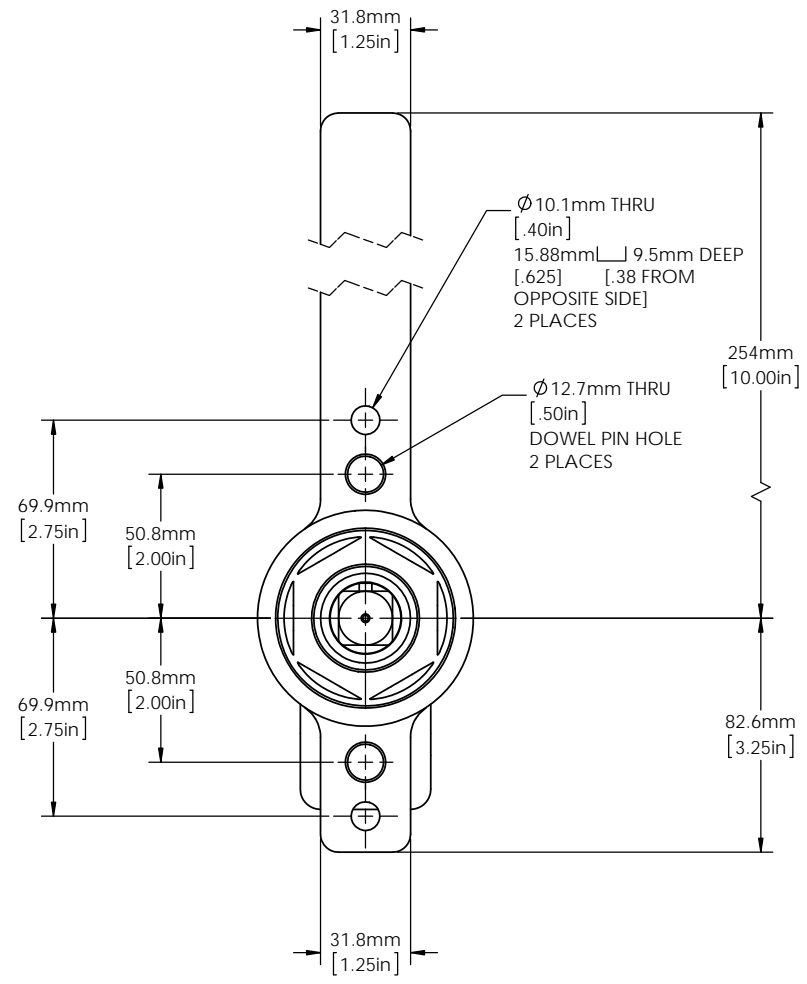

**DOCUMENT CONTROL**  
 PRINTED COPIES OF THIS DOCUMENT ARE CONSIDERED TO BE UNCONTROLLED DOCUMENTS. HOLDERS ARE RESPONSIBLE FOR VERIFYING THE CURRENT REVISION LEVEL WITH PURCHASING OR ENGINEERING PRIOR TO USE OR FABRICATION. THE CONTROLLED VERSION OF THIS DOCUMENT IS ELECTRONICALLY MAINTAINED.

**PROPRIETARY AND CONFIDENTIAL**  
 THIS DRAWING CONTAINS INFORMATION STRICTLY CONFIDENTIAL TO ACRADYNE/AIMCO. IN THE ABSENCE OF EXPRESSED WRITTEN PERMISSION, ACRADYNE/AIMCO HAS LOANED THIS COPY WITH THE MUTUAL UNDERSTANDING THAT (A) IT WILL NOT BE USED FOR ANY PURPOSE OTHER THAN FOR THAT IN WHICH IT WAS PROVIDED, (B) THE DATA CONTAINED HEREIN WILL NOT BE DISCLOSED TO OTHERS, (C) IT WILL NOT BE REPRODUCED, AND (D) IT WILL BE RETURNED TO ACRADYNE/AIMCO IMMEDIATELY UPON DEMAND.

REVISION LEVEL	REVISION RELEASE DATE	DESCRIPTION OF CHANGES MADE TO PART	ECN #	AUTHOR/ APPROVAL
REVISION BLOCK				

**UNLESS OTHERWISE SPECIFIED, DIMENSIONS ARE IN INCHES**  
 DIMENSIONS AND TOLERANCING PER ANSI Y14.5  
 SURFACE ROUGHNESS PER ANSI Y14.36

**BLOCK TOLERANCING PER DECIMAL:**  
 .X = ±.030 .XX = ±.010 .XXX = ±.005 .XXXX = ±.0005  
 ANGLE = 50° 30'

REMOVE BURRS AND SHARP EDGES: R.015 MAX  
 MACHINE SURFACE FINISH: 125 RMS OR BETTER

DRAWINGS AND TECHNICAL DOCUMENTS CONTROLLED BY:  
**ACRADYNE MECHANICAL ENGINEERING**

<b>FIXTURED NUTRUNNER 5000 SERIES, GEN 3</b>		
SIZE <b>D</b>	PART / DRAWING NUMBER <b>AEF35__ _A</b>	REVISION <b>A</b>
SCALE 3:4	DO NOT SCALE DRAWING	SHEET 2 OF 2