

COMMENTS	ITEM NO.	PART NUMBER	QTY.	DESCRIPTION
	1	32429	1	MOTOR ASM.
	2	29335	4	STANDOFF, M-F, 4-40 X 3/16, SS
	3	27797	1	TID BOARD, POPULATED W/O AMP CIRCUIT
	4	29337	3	STANDOFF, M-F, 4-40 X 1/8, SS
	5	29338	1	TID WIRE INSULATOR
	6	25573	7	SCREW PHP 4-40 X 3/16 18-8 SS
	7	25225	1	END GRIP CAP, HT TOOLS
	8	25568	4	SHC 10-32 x 1.25 BLK OXIDE
	9	25229	1	AXIAL HANDLE, HT TOOLS
	10	SEE CHART	1	GEARBOX AND CLUTCH ASM.
	11	27980	1	SLIP RING PINION ADAPTER
	12	26080	1	O-RING, LED LIGHT RING COVER
	13	25212	1	SWITCH SUB-ASSEMBLY
NOT SHOWN	14	25582	1	TRIGGER CABLE
	15	25505	1	TOOL CONNECTOR ASM HERC PISTOL
	16	25231	1	TRAY, WIRE, END GRIP
	17	25569	10	SCREW LHCS 10-32 X 3/8 18-8 SS
	18	29279	6	SCREW, BHSC, 10-32 x 3/8, TORX HEAD, NYLON PELL-IT, STEEL
	19	26898	1	CHOOSE REACTION BAR
	20	25579	1	PLUG 3/8"
	21	31412	1	GROUND WIRE ASSEMBLY, 18 AWG, 8000 & 9000 HT SERIES
NOT SHOWN	22	28257	1	CABLE TIE, 1.65MM W X 71MM LG
	23	25271	1	SHIM. - .002
	24	25272	1	SHIM. - .005
	25	25273	1	SHIM. - .010
NOT SHOWN	26	24177	A/R	RTV 108, TRANSLUCENT

**NOTE:**  
SEE WORK INSTRUCTION DOCUMENT "W2047"  
FOR COMPLETE ASSEMBLY INSTRUCTIONS.

MODEL NO.	GEARBOX/CLUTCH ASM.
AED4B884200B1	31854.001
AED4B884200B	31855.001
AED4B885000B1	31854.002
AED4B885000B	31855.002
AED4W885000B1	32389
AED4W885000B	32401

- ◆ ASSEMBLY INSTRUCTIONS
- ◻ SUB-ASSEMBLY

- 1) GEARS & SPLINES: LUBRICATE WITH DOW CORNING MOLYKOTE BR2 PLUS GREASE.
- 2) BEARINGS: LUBRICATE WITH CHEVRON SR1 GREASE
- 3) O-RINGS: LUBRICATE WITH O-RING LUBE

**DETAIL B**  
SCALE 1 : 1

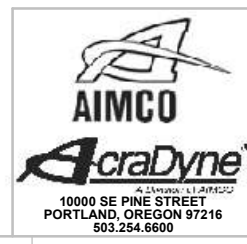

**DOCUMENT CONTROL**  
PRINTED COPIES OF THIS DOCUMENT ARE CONSIDERED TO BE UNCONTROLLED DOCUMENTS. HOLDERS ARE RESPONSIBLE FOR VERIFYING THE CURRENT REVISION LEVEL WITH PURCHASING OR ENGINEERING PRIOR TO USE OR FABRICATION. THE CONTROLLED VERSION OF THIS DOCUMENT IS ELECTRONICALLY MAINTAINED.

**PROPRIETARY AND CONFIDENTIAL**  
THIS DRAWING CONTAINS INFORMATION STRICTLY CONFIDENTIAL TO ACRADYNE/AIMCO. IN THE ABSENCE OF EXPRESSED WRITTEN PERMISSION, ACRADYNE/AIMCO HAS LOANED THIS COPY WITH THE MUTUAL UNDERSTANDING THAT (A) IT WILL NOT BE USED FOR ANY PURPOSE OTHER THAN FOR THAT IN WHICH IT WAS PROVIDED, (B) THE DATA CONTAINED HEREIN WILL NOT BE DISCLOSED TO OTHERS, (C) IT WILL NOT BE REPRODUCED, AND (D) IT WILL BE RETURNED TO ACRADYNE/AIMCO IMMEDIATELY UPON DEMAND.

REVISION LEVEL	REVISION RELEASE DATE	DESCRIPTION OF CHANGES MADE TO PART	ECN #	AUTHOR/ APPROVAL
E	04/05/24	CLUTCH/GEARBOX ASSEMBLY IN CHART WAS GEARBOX ASSEMBLY. DELETED SLIP RING SET FROM CHART AND ALL SLIP RING CLUTCH COMPONENTS. MOTOR ASM 26160 WAS 26160. DELETED 2680, 2680, 2714 ADDED SHIMS 2017, 2017, 2017. DELETED 4888A TOOL MODELS.	6407	T. BURNETT
D	09/04/20	MOTOR 26160 WAS "SEE CHART". 26160 WAS 25224 IN 4200MM TOOL MODELS. ADDED TOOL MODELS AED4W885000B & AED4W885000B1.	4874	T. BURNETT
C	01/28/20	ADDED 31412 GROUND WIRE ATTACHMENT DETAILS. NO LOCTITE (21) WAS #222 (21) WAS #6. DELETED LOCTITE (21) FROM ITEM 15. DELETED 2584, 2584 517Y 7 WAS 517Y 4. DELETED CLUTCH CLUTCH VIEW. 3.4MM 25 IN-LBS WAS 3.2MM 25 IN-LBS OR FEEL IN-LBS WAS 3.4MM 25 IN-LBS. W2047 WAS EW-611. ADDED 2417 RTV TO BOM.	3797	B. BELLI
B	03/24/16	ADDED 29337 & 29338. 29335 WAS 25574. 29284 WAS 25583. 29279 WAS 24016 & 24206. TIGHTENING TORQUE 5.4 Nm WAS 3.4 Nm. LOCTITE 222 (PURPLE) WAS LOCTITE 243 (BLUE).	1822	T. BURNETT
A	10/09/14	PRODUCTION RELEASE	1295	T. BURNETT

**UNLESS OTHERWISE SPECIFIED, DIMENSIONS ARE IN INCHES**  
DIMENSIONS AND TOLERANCING PER ANSI Y14.5 SURFACE ROUGHNESS PER ANSI Y14.36

**BLOCK TOLERANCING PER DECIMAL:**  
.X = ±.030 .XX = ±.010 .XXX = ±.005 .XXXX = ±.0005  
ANGLE = ±0° 30'

REMOVE BURRS AND SHARP EDGES: R.015 MAX MACHINE SURFACE FINISH: 125 RMS OR BETTER

DRAWINGS AND TECHNICAL DOCUMENTS CONTROLLED BY:  
**ACRADYNE MECHANICAL ENGINEERING**

<b>"D" HANDLE NUTRUNNER W/SLIP RING CLUTCH 8000 SERIES</b>		
SIZE	PART / DRAWING NUMBER	REVISION
<b>D</b>	<b>AED4 88</b>	<b>B E</b>
SCALE: 2:3	DO NOT SCALE DRAWING	SHEET 1 OF 2

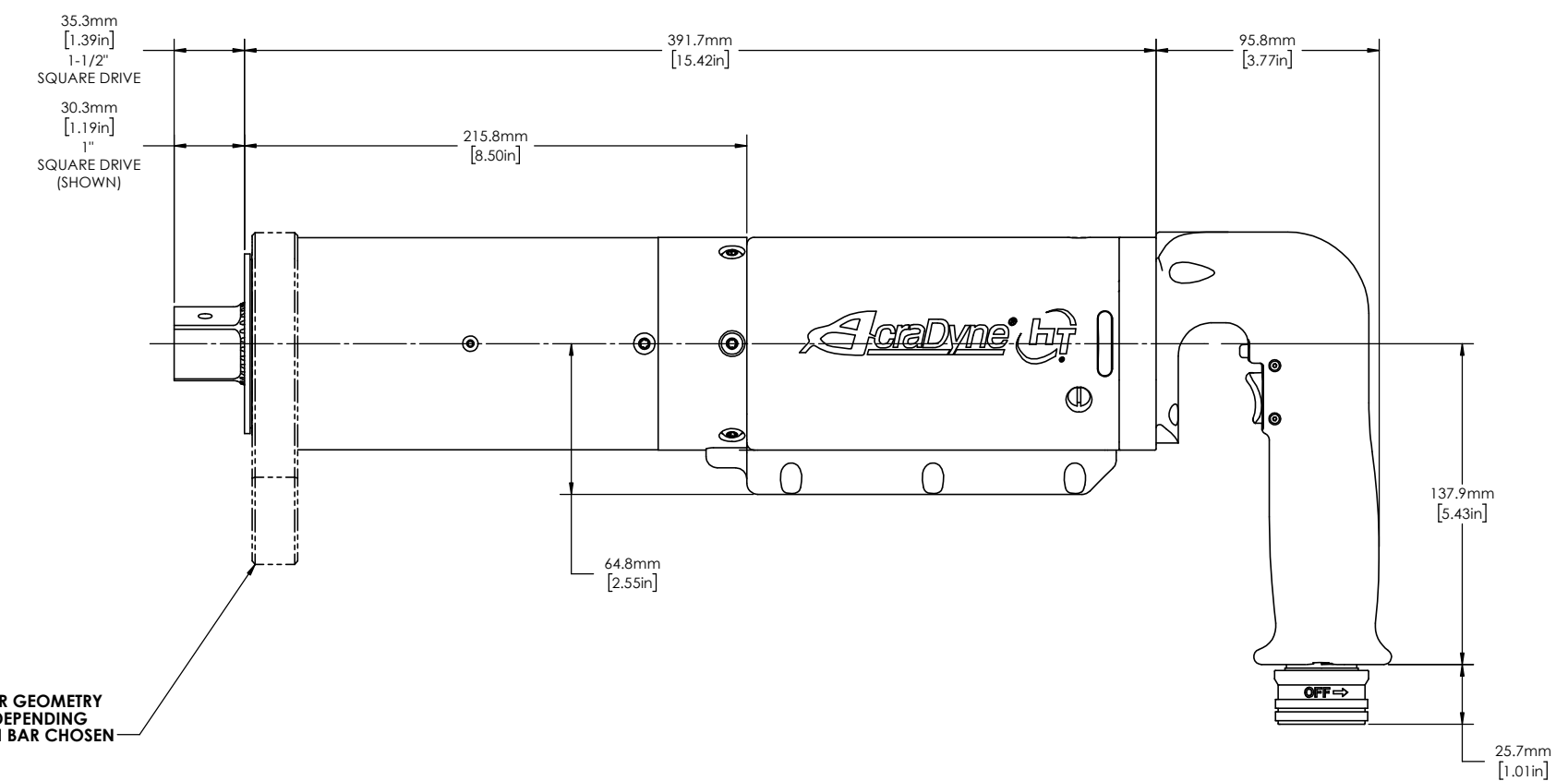
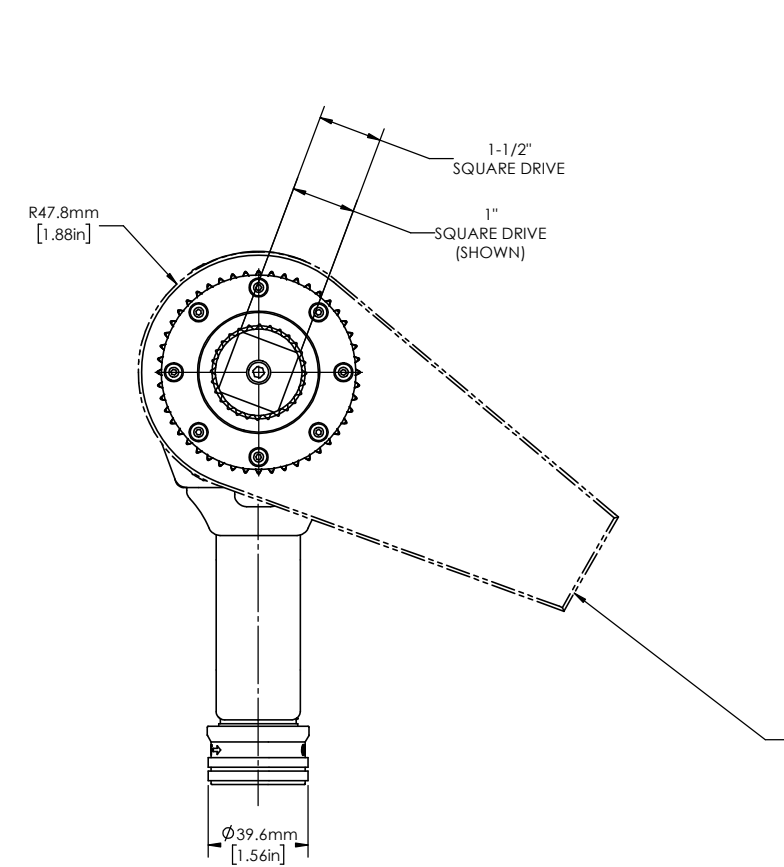
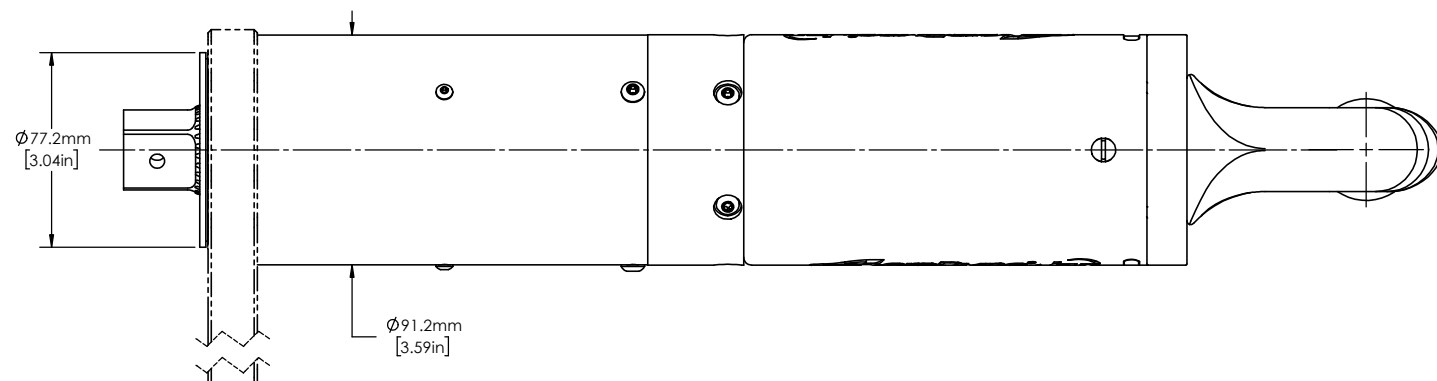

NOTE:  
REACTION BAR GEOMETRY  
TO CHANGE DEPENDING  
ON REACTION BAR CHOSEN

MODEL NO.	SQUARE DRIVE
AED4B884200B	1-1/2"
AED4B884200B1	1"
AED4B885000B	1-1/2"
AED4B885000B1	1"
AED4W885000B	1-1/2"
AED4W885000B1	1"

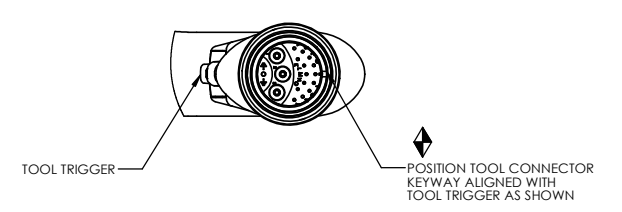

**DOCUMENT CONTROL**  
PRINTED COPIES OF THIS DOCUMENT ARE CONSIDERED TO BE UNCONTROLLED DOCUMENTS. HOLDERS ARE RESPONSIBLE FOR VERIFYING THE CURRENT REVISION LEVEL WITH PURCHASING OR ENGINEERING PRIOR TO USE OR FABRICATION. THE CONTROLLED VERSION OF THIS DOCUMENT IS ELECTRONICALLY MAINTAINED.

**PROPRIETARY AND CONFIDENTIAL**  
THIS DRAWING CONTAINS INFORMATION STRICTLY CONFIDENTIAL TO ACRADYNE/AIMCO. IN THE ABSENCE OF EXPRESSED WRITTEN PERMISSION, ACRADYNE/AIMCO HAS LOANED THIS COPY WITH THE MUTUAL UNDERSTANDING THAT (A) IT WILL NOT BE USED FOR ANY PURPOSE OTHER THAN FOR THAT IN WHICH IT WAS PROVIDED, (B) THE DATA CONTAINED HEREIN WILL NOT BE DISCLOSED TO OTHERS, (C) IT WILL NOT BE REPRODUCED, AND (D) IT WILL BE RETURNED TO ACRADYNE/AIMCO IMMEDIATELY UPON DEMAND.

REVISION LEVEL	REVISION RELEASE DATE	DESCRIPTION OF CHANGES MADE TO PART	ECN #	AUTHOR/ APPROVAL
E	04/05/24	CLUTCH/GEARBOX ASSEMBLY IN CHART WAS GEARBOX ASSEMBLY DELETED. SLIP RING SET FROM CHART AND ALL SLIP RING CLUTCH COMPONENTS MOTOR ASST. 25420 WAS 25100 DELETED. 2480, 2540, 2774 ADDED SHAS 2071, 2072, 2073 DELETED 40000 TOOL MODELS.	6407	T. BURNETT
D	09/04/20	MOTOR 26160 WAS "SEE CHART". 26160 WAS 25224 IN 4200Nm TOOL MODELS. ADDED TOOL MODELS AED4W885000B & AED4W885000B1.	4874	T. BURNETT
C	01/28/20	ADDED 3145 GRINDING WIRE ATTACHMENT DETAILS. NO LOCITE 222 WAS 2222 OR 1180. 1A CLUTCH LOCITE 222 WAS 2222 OR 1180. 2222 2574 2575 QTY. 7 WAS QTY. 4. DELETED CLUTCH CUTAWAY VIEW. 3.4mm (0.134 IN) WAS 3.2mm (0.126 IN) 2575 2576 2577 2578 2579 2580 2581 2582 2583 2584 2585 2586 2587 2588 2589 2590 2591 2592 2593 2594 2595 2596 2597 2598 2599 2600 2601 2602 2603 2604 2605 2606 2607 2608 2609 2610 2611 2612 2613 2614 2615 2616 2617 2618 2619 2620 2621 2622 2623 2624 2625 2626 2627 2628 2629 2630 2631 2632 2633 2634 2635 2636 2637 2638 2639 2640 2641 2642 2643 2644 2645 2646 2647 2648 2649 2650 2651 2652 2653 2654 2655 2656 2657 2658 2659 2660 2661 2662 2663 2664 2665 2666 2667 2668 2669 2670 2671 2672 2673 2674 2675 2676 2677 2678 2679 2680 2681 2682 2683 2684 2685 2686 2687 2688 2689 2690 2691 2692 2693 2694 2695 2696 2697 2698 2699 2700 2701 2702 2703 2704 2705 2706 2707 2708 2709 2710 2711 2712 2713 2714 2715 2716 2717 2718 2719 2720 2721 2722 2723 2724 2725 2726 2727 2728 2729 2730 2731 2732 2733 2734 2735 2736 2737 2738 2739 2740 2741 2742 2743 2744 2745 2746 2747 2748 2749 2750 2751 2752 2753 2754 2755 2756 2757 2758 2759 2760 2761 2762 2763 2764 2765 2766 2767 2768 2769 2770 2771 2772 2773 2774 2775 2776 2777 2778 2779 2780 2781 2782 2783 2784 2785 2786 2787 2788 2789 2790 2791 2792 2793 2794 2795 2796 2797 2798 2799 2800 2801 2802 2803 2804 2805 2806 2807 2808 2809 2810 2811 2812 2813 2814 2815 2816 2817 2818 2819 2820 2821 2822 2823 2824 2825 2826 2827 2828 2829 2830 2831 2832 2833 2834 2835 2836 2837 2838 2839 2840 2841 2842 2843 2844 2845 2846 2847 2848 2849 2850 2851 2852 2853 2854 2855 2856 2857 2858 2859 2860 2861 2862 2863 2864 2865 2866 2867 2868 2869 2870 2871 2872 2873 2874 2875 2876 2877 2878 2879 2880 2881 2882 2883 2884 2885 2886 2887 2888 2889 2890 2891 2892 2893 2894 2895 2896 2897 2898 2899 2900 2901 2902 2903 2904 2905 2906 2907 2908 2909 2910 2911 2912 2913 2914 2915 2916 2917 2918 2919 2920 2921 2922 2923 2924 2925 2926 2927 2928 2929 2930 2931 2932 2933 2934 2935 2936 2937 2938 2939 2940 2941 2942 2943 2944 2945 2946 2947 2948 2949 2950 2951 2952 2953 2954 2955 2956 2957 2958 2959 2960 2961 2962 2963 2964 2965 2966 2967 2968 2969 2970 2971 2972 2973 2974 2975 2976 2977 2978 2979 2980 2981 2982 2983 2984 2985 2986 2987 2988 2989 2990 2991 2992 2993 2994 2995 2996 2997 2998 2999 3000	3797	B. BELLI
B	03/24/16	ADDED 29237 & 29238. 29235 WAS 2574. 29284 WAS 2583. 29279 WAS 24014 & 24206. TIGHTENING TORQUE 5.4 Nm WAS 3.4 Nm. LOCITE 222 (PURPLE) WAS LOCITE 243 (BLUE).	1822	T. BURNETT
A	10/09/14	PRODUCTION RELEASE	1295	T. BURNETT

**UNLESS OTHERWISE SPECIFIED, DIMENSIONS ARE IN INCHES**  
DIMENSIONS AND TOLERANCING PER ANSI Y14.5  
SURFACE ROUGHNESS PER ANSI Y14.36

**BLOCK TOLERANCING PER DECIMAL:**  
X = ±.030 .XX = ±.010 .XXX = ±.005 .XXXX = ±.0005  
ANGLE = ±0° 30'

REMOVE BURRS AND SHARP EDGES: R.015 MAX  
MACHINE SURFACE FINISH: 125 RMS OR BETTER

DRAWINGS AND TECHNICAL DOCUMENTS CONTROLLED BY:  
**ACRADYNE MECHANICAL ENGINEERING**

**"D" HANDLE NUTRUNNER  
W/SLIP RING CLUTCH  
8000 SERIES**

SIZE	PART / DRAWING NUMBER	REVISION
<b>D</b>	<b>AED4 88</b>	<b>B E</b>
SCALE 1:8	DO NOT SCALE DRAWING	SHEET 2 OF 2