

TOOL MODEL	PISTOL NUTRUNNER
ABP-CTA5000	ABP-CTA12-HT
ABP-CTA5000W	ABP-CTA12W-HT

NOTE:
PROGRAM TOOL WITHIN RANGE OF 12-12.5Nm
FOR 5100+Nm OUTPUT TORQUE
SEE WORK INSTRUCTION W2070 SECTION 4.8 TOOL SET-UP FOR HT
GEARING

COMMENTS	ITEM NO.	PART NUMBER	QTY.	DESCRIPTION
	1	SEE CHART	1	CORDLESS PISTOL NUTRUNNER W/HT ADAPTER, 12Nm. CORDLESS SERIES
	2	31191	1	TRANSDUCER/MOTOR TO CLUTCH ADAPTER
	3	25111	4	SCREW, SHC, M4 X 16MM, SS
	4	31194	1	GEARBOX COUPLER SHAFT, 8000 SERIES
	5	25533	2	BEARING, BALL, Ø19mm X Ø10mm X 5mm
	6	31321	1	SNAP RING, EXTERNAL, Ø.375
	7	31193	1	GEARBOX CLUTCH ADAPTER
	8	31648	4	SCREW, SHC 8-32X.5, STEEL, BLACK OXIDE
	9	28295	1	CLUTCH PLATE ASSY, HT AIR TOOLS
	10	28174	4	SPRING, COMPRESSION
	11	20105	4	DETENT BALL
	12	27751	1	CLUTCH DETENT PLATE, HT AIR TOOLS
	13	26162	4	SCREW, SHC, 6-32 X 9/16, STEEL
	14	27754	1	CLUTCH ADAPTER RING, HT AIR TOOLS
	15	27775	1	GEARBOX ASSY, 626.4:1, HT AIR TOOLS, 1" OUTPUT
	16	29279	9	SCREW, BHSC, 10-32 x 3/8, TORX HEAD, NYLON PELL-IT, STEEL
	17	29284	3	SCREW, BHSC, 10-32 X 1/2, TORX HEAD, NYLON PELL-IT, STEEL
	18	25564	3	WASHER SHIM .093THK .25ID .375OD
	19	25284	1	HT TOOL TRANSDUCER SLEEVE
	20	26319	3	SCREW, BHSC 6-32 X .188, 18-8 SS
	21	26898	1	CHOOSE REACTION BAR

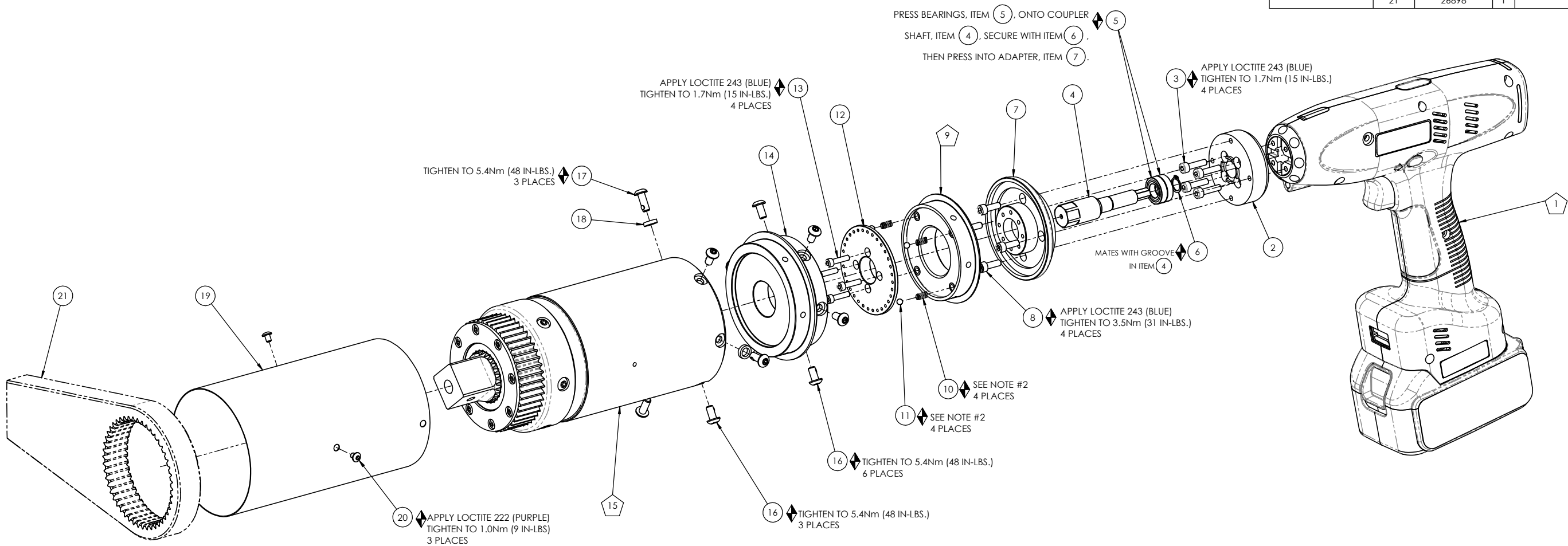

 SUB-ASSEMBLY

- 1) GEARS & SPLINES: LUBRICATE WITH DOW CORNING MOLYKOTE BR2 PLUS GREASE.
- 2) BEARINGS: LUBRICATE WITH CHEVRON SR1 GREASE
- 3) O-RINGS: LUBRICATE WITH O-RING LUBE



DOCUMENT CONTROL
PRINTED COPIES OF THIS DOCUMENT ARE CONSIDERED TO BE UNCONTROLLED DOCUMENTS. HOLDERS ARE RESPONSIBLE FOR VERIFYING THE CURRENT REVISION LEVEL WITH PURCHASING OR ENGINEERING PRIOR TO USE OR FABRICATION. THE CONTROLLED VERSION OF THIS DOCUMENT IS ELECTRONICALLY MAINTAINED.

PROPRIETARY AND CONFIDENTIAL
THIS DRAWING CONTAINS INFORMATION STRICTLY
CONFIDENTIAL TO ACRADYNE/AIMCO. IN THE ABSENCE
OF EXCESSIVE WRITTEN PERMISSION, ACRADYNE/AIMCO
HAS NO INTENT TO SHARE THIS INFORMATION, INCLUDING
THAT (A) IT WILL NOT BE USED FOR ANY PURPOSE OTHER
THAN FOR THAT IN WHICH IT WAS PROVIDED, (B) THE DATA
CONTAINED HEREIN WILL NOT BE DISCLOSED TO OTHERS,
(C) IT WILL NOT BE REPRODUCED, AND (D) IT WILL BE RETURNED
TO ACRADYNE/AIMCO IMMEDIATELY UPON DEMAND.

REVISION LEVEL	REVISION RELEASE DATE	DESCRIPTION OF CHANGES MADE TO PART	ECN #	AUTHOR/ APPROVAL
REVISION BLOCK				

**UNLESS OTHERWISE SPECIFIED,
DIMENSIONS ARE IN INCHES**
DIMENSIONS AND TOLERANCING PER ANSI Y14.5
SURFACE ROUGHNESS PER ANSI Y14.36

BLOCK TOLERANCING PER DECIMAL:
 $X = \pm .030$ $.XX = \pm .010$ $.XXX = \pm .005$ $.XXXX = \pm .0005$

REMOVE BURRS AND SHARP EDGES: R.015 MAX
MACHINE SURFACE FINISH: 125 RMS OR BETTER

**DRAWINGS AND TECHNICAL DOCUMENTS CONTROLLED BY:
ACRADYNE MECHANICAL ENGINEERING**

**CORDLESS HT PISTOL
NUTRUNNER, 5000Nm GEARBOX
HT CORDLESS SERIES**

SIZE D	PART / DRAWING NUMBER ABP-CTA5000	REVISION B
SCALE 1:8	DO NOT SCALE DRAWING	SHEET 1 OF 2

