

**NOTE:**

BEVEL GEARS IN ANGLE HEAD ASSEMBLY, ITEM 3 MUST BE SHIMMED PRIOR TO INSTALLATION OF GEARHEAD ADAPTING COMPONENTS.

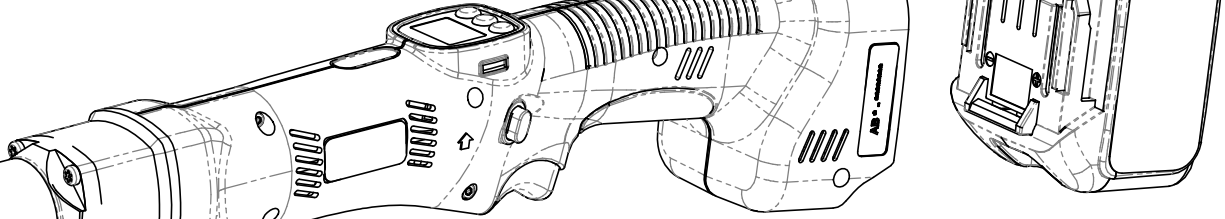
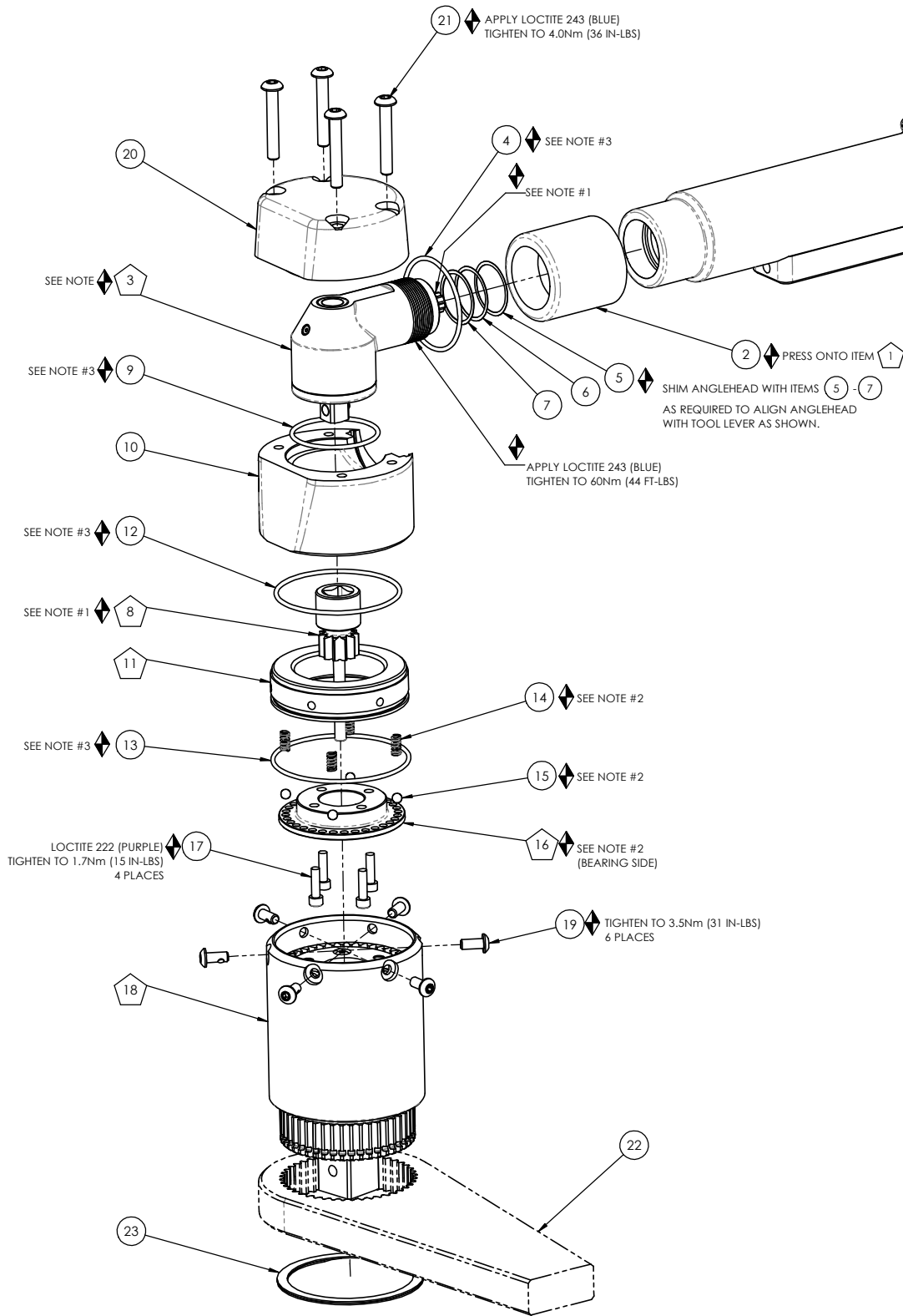

COMMENTS	ITEM NO.	PART NUMBER	QTY.	DESCRIPTION
INCLUDED IN ITEM 1	1	AB-CTA55W	1	CORDLESS NUTRUNNER, WITHOUT HEAD, CORDLESS SERIES, 55Nm
		AB-B1850L		BATTERY ASSEMBLY, 18V, LI-ION, 5.0 AH
	2	31804	1	ANGLE HEAD ADAPTER, 900Nm
	3	27135	1	ANGLE HEAD ASM, 3/8 SQ.
	4	27204	1	O-RING, OUTER CLUTCH PLATE
	5	21091	1	SHIM, PINION SHAFT, .002 --- 2000 SERIES
	6	21092	1	SHIM, PINION SHAFT, .005 --- 2000 SERIES
	7	21093	1	SHIM, PINION SHAFT, .010 --- 2000 SERIES
	8	29501	1	INPUT GEAR ASSY, HT ANGLEHEAD
	9	27235	1	O-RING, BUNA-N, #28
	10	29485	1	ADAPTER, HT ANGLEHEAD, 900Nm
	11	29500	1	CLUTCH PLATE ASSY, HT AIR TOOLS
	12	28018	1	O-RING, Ø1/16 X Ø2.000
	13	26488	1	O-RING, MOTOR HOUSING
	14	28174	4	SPRING, COMPRESSION
	15	20105	4	DETENT BALL
	16	29459	1	CLUTCH DETENT PLATE, HT ANGLEHEAD
	17	24900	4	SCREW, SHC 6-32 X 1/2, STEEL
	18	29492	1	GEARBOX ASSY, 900 Nm, HT ANGLE TOOLS
	19	29285	6	SCREW, BHSC, 8-32 x .38, TORX HEAD, NYLON PELL-IT, BLK OXIDE
	20	29486	1	TOP CAP, HT ANGLEHEAD, 900 Nm
	21	27401	4	SCREW, BHSC 10-32 X 1.25, STEEL, BLK OXIDE
	22	26896	1	CHOOSE REACTION BAR
	23	26514	1	RETAINING RING, SPIRAL, Ø2.441 X Ø2.105 X .078

◆ ASSEMBLY INSTRUCTIONS

◊ SUB-ASSEMBLY

- 1) GEARS & SPLINES: LUBRICATE WITH DOW CORNING MOLYKOTE BR2 PLUS GREASE.
- 2) BEARINGS: LUBRICATE WITH CHEVRON SR1 GREASE
- 3) O-RINGS: LUBRICATE WITH O-RING LUBE

**DOCUMENT CONTROL**

PRINTED COPIES OF THIS DOCUMENT ARE CONSIDERED TO BE UNCONTROLLED DOCUMENTS. HOLDERS ARE RESPONSIBLE FOR VERIFYING THE CURRENT REVISION LEVEL WITH PURCHASING OR ENGINEERING PRIOR TO USE OR FABRICATION. THE CONTROLLED VERSION OF THIS DOCUMENT IS ELECTRONICALLY MAINTAINED.

**PROPRIETARY AND CONFIDENTIAL**

THIS DRAWING CONTAINS INFORMATION STRICTLY CONFIDENTIAL TO ACRADYNE/AMCO. IN THE ABSENCE OF EXPRESSED WRITTEN PERMISSION, ACRADYNE/AMCO HAS LOANED THIS COPY WITH THE MUTUAL UNDERSTANDING THAT (A) IT WILL NOT BE USED FOR ANY PURPOSE OTHER THAN FOR THAT IN WHICH IT WAS PROVIDED, (B) THE DATA CONTAINED HEREIN WILL NOT BE DISCLOSED TO OTHERS, (C) IT WILL NOT BE REPRODUCED, AND (D) IT WILL BE RETURNED TO ACRADYNE/AMCO IMMEDIATELY UPON DEMAND.

10000 SE PINE STREET  
PORTLAND, OREGON 97216  
503.254.6600

REVISION LEVEL	REVISION RELEASE DATE	DESCRIPTION OF CHANGES MADE TO PART	ECN #	AUTHOR/ APPROVAL

**REVISION BLOCK**

UNLESS OTHERWISE SPECIFIED, DIMENSIONS ARE IN INCHES  
DIMENSIONS AND TOLERANCING PER ANSI Y14.5  
SURFACE ROUGHNESS PER ANSI Y14.36

BLOCK TOLERANCING PER DECIMAL:  
X = ±.030 XX = ±.010 XXX = ±.005 XXXX = ±.0005  
ANGLE = ±0° 30'

REMOVE BURRS AND SHARP EDGES: R.015 MAX  
MACHINE SURFACE FINISH: 125 RMS OR BETTER

DRAWINGS AND TECHNICAL DOCUMENTS CONTROLLED BY:  
**ACRADYNE MECHANICAL ENGINEERING**

**CORDLESS ANGLE NUTRUNNER  
900Nm**

CORDLESS SERIES

SIZE	PART / DRAWING NUMBER	REVISION
<b>D</b>	<b>ABN-CTA900W</b>	<b>A</b>

SCALE 3:4 DO NOT SCALE DRAWING SHEET 1 OF 2

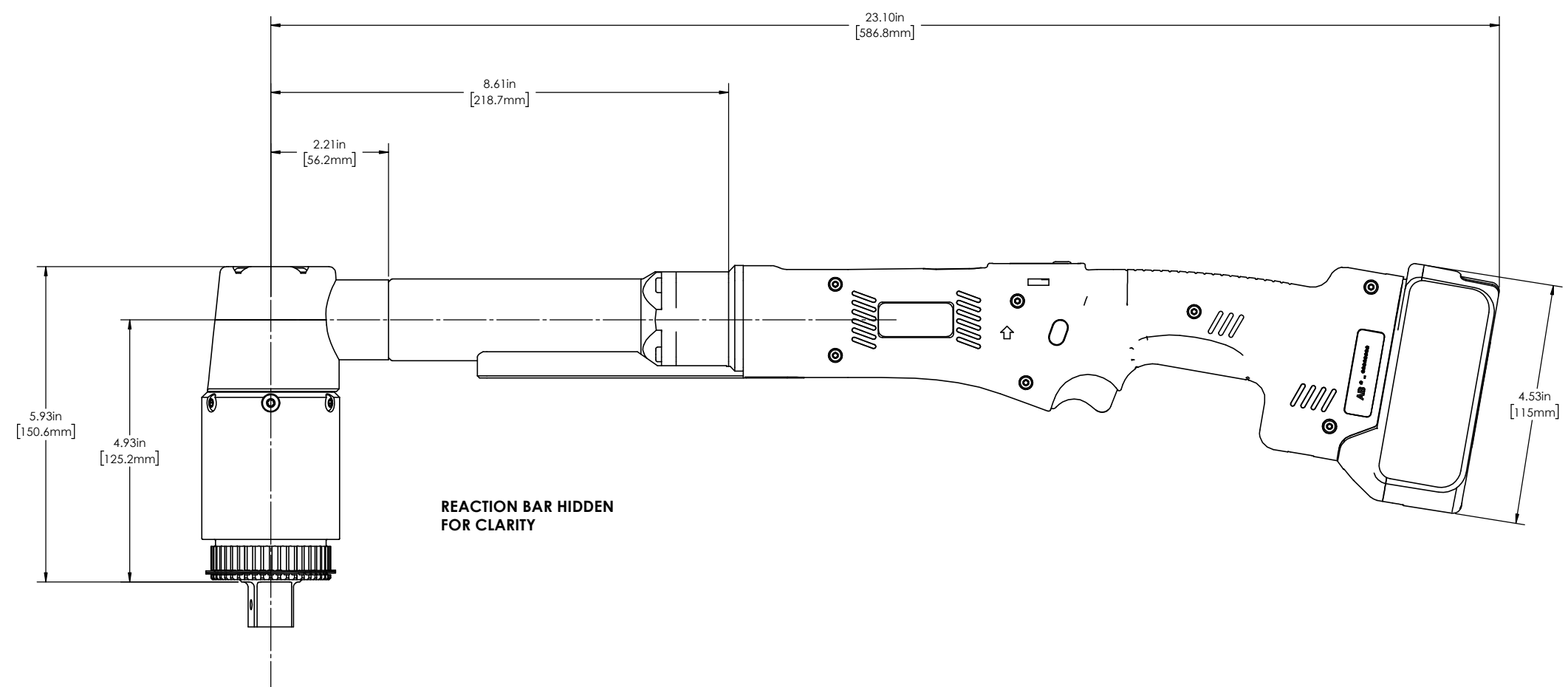
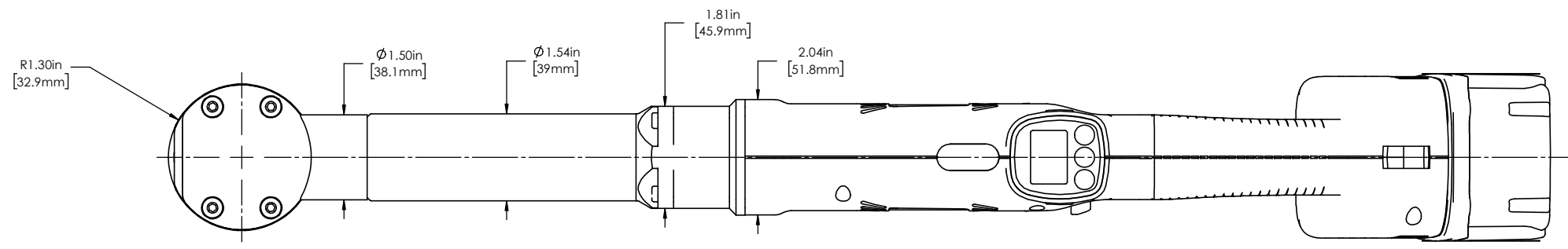

REACTION BAR HIDDEN FOR CLARITY

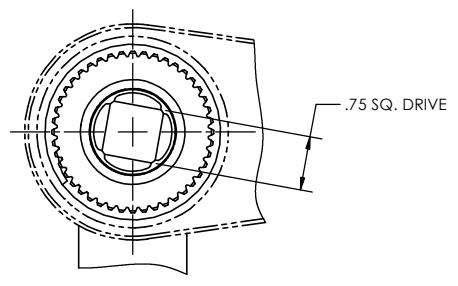
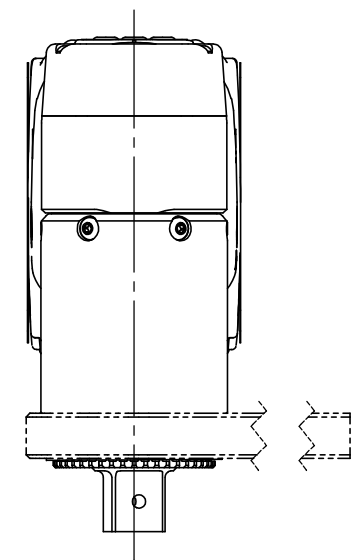
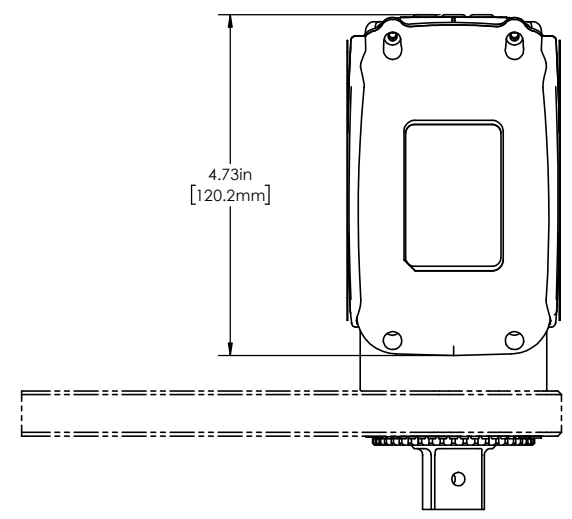

**DOCUMENT CONTROL**  
 PRINTED COPIES OF THIS DOCUMENT ARE CONSIDERED TO BE UNCONTROLLED DOCUMENTS. HOLDERS ARE RESPONSIBLE FOR VERIFYING THE CURRENT REVISION LEVEL WITH PURCHASING OR ENGINEERING PRIOR TO USE OR FABRICATION. THE CONTROLLED VERSION OF THIS DOCUMENT IS ELECTRONICALLY MAINTAINED.

**PROPRIETARY AND CONFIDENTIAL**  
 THIS DRAWING CONTAINS INFORMATION STRICTLY CONFIDENTIAL TO ACRADYNE/AIMCO. IN THE ABSENCE OF EXPRESSED WRITTEN PERMISSION, ACRADYNE/AIMCO HAS LOANED THIS COPY WITH THE MUTUAL UNDERSTANDING THAT (A) IT WILL NOT BE USED FOR ANY PURPOSE OTHER THAN FOR THAT IN WHICH IT WAS PROVIDED, (B) THE DATA CONTAINED HEREIN WILL NOT BE DISCLOSED TO OTHERS, (C) IT WILL NOT BE REPRODUCED, AND (D) IT WILL BE RETURNED TO ACRADYNE/AIMCO IMMEDIATELY UPON DEMAND.

REVISION LEVEL	REVISION RELEASE DATE	DESCRIPTION OF CHANGES MADE TO PART	ECN #	AUTHOR/ APPROVAL

**UNLESS OTHERWISE SPECIFIED, DIMENSIONS ARE IN INCHES**  
 DIMENSIONS AND TOLERANCING PER ANSI Y14.5  
 SURFACE ROUGHNESS PER ANSI Y14.36

**BLOCK TOLERANCING PER DECIMAL:**  
 .X = ±.030 .XX = ±.010 .XXX = ±.005 .XXXX = ±.0005  
 ANGLE = ±0° 30'

REMOVE BURRS AND SHARP EDGES: R.015 MAX  
 MACHINE SURFACE FINISH: 125 RMS OR BETTER

DRAWINGS AND TECHNICAL DOCUMENTS CONTROLLED BY:  
**ACRADYNE MECHANICAL ENGINEERING**

**CORDLESS ANGLE NUTRUNNER 900Nm**

CORDLESS SERIES

SIZE	PART / DRAWING NUMBER	REVISION
<b>D</b>	<b>ABN-CTA900W</b>	<b>A</b>

SCALE: 1:2 DO NOT SCALE DRAWING SHEET 2 OF 2