



# FASTENER TOOLS

## *2019*

# STANDARD FASTENER TOOLS

## STANDARD FASTENER TOOLS

Connect your tool to the application with Bits, Sockets, and Nutsetters from AIMCO.

AIMCO has assembled a complete package of commonly used screwdriver bits and nutsetters. Our goal is to supply you with the highest quality bits and nutsetters for your fastener needs. Whether you're in electronics, aerospace, automotive, or general industry, AIMCO has the bits and nutsetters to fit your needs.

## MAG-O-NETS®: A Revolutionary Way to Convert Standard Bits to Magnetic Bits

### FEATURES AND BENEFITS

- Easy, cost effective alternative to traditional magnetic bit holder and insert bit combination
- Improves torque transfer by eliminating "wobble effect"
- Easily adjust magnetic attraction by moving Mag-O-Net collar closer to or further from fastener
- Fits virtually any standard screwdriver bit
- Reusable and interchangeable – once a bit is worn out, simply remove your Mag-O-Net and slide it onto the next bit
- Lifetime guarantee on magnetic attraction



\*U.S. Patent 5861789

PART NO	INNER DIAMETER (ID)	OUTER DIAMETER (OD)	L MM
AM1/4Z	7 mm	19 mm	10
AM5Z	6 mm	17.5 mm	10
AM3/16Z	3/16 in	17.5 mm	10

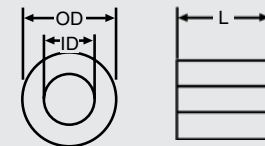

## MARKER SOCKETS

Marker Sockets paint the bolt head at the same time the torque is checked. Sockets are designed to your specification.

- Unit consists of a marker socket, an ink cartridge, a spring, and the cartridge cap
- Cartridge can be inserted/taken off easily for ink management
- Easily replaceable paint point
- Can be used with either oil-based or water-based inks
- When ordering, provide dimensions shown. To order, contact an AIMCO Customer Service Associate 1-503-254-6600, or toll free 1-800-852-1368



Socket



Bolt



Nut



Recessed bolt

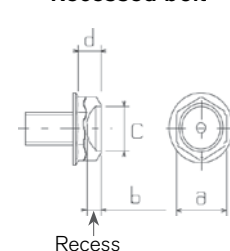
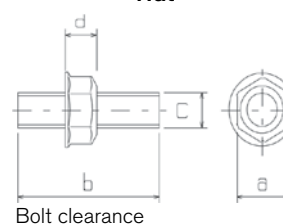
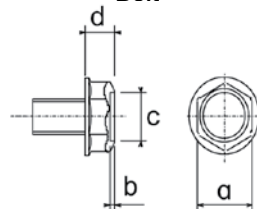

# STANDARD FASTENER TOOLS

## IMPACT SOCKETS

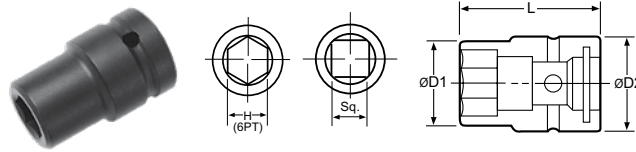

	PART NO	HEX	D1 MM	D1 IN	D2 MM	D2 IN	L MM	L IN
<b>3/8" Square Drive</b>								
SAE	A31/4	1/4"	10	0.39	19	0.75	34	1.34
	A35/16	5/16"	12	0.47	19	0.75	34	1.34
	A33/8	3/8"	15	0.59	19	0.75	34	1.34
METRIC	A306	6 mm	10	0.39	19	0.75	34	1.34
	A307	7 mm	13	0.49	20	0.79	32	1.26
	A308	8 mm	14	0.55	20	0.79	32	1.26
<b>3/8" Square Drive, Deep</b>								
	A307-2	7 mm	13	0.49	20	0.79	50	1.97
	A307-2.75	7 mm	13	0.49	20	0.79	70	2.76
	A308-2	8 mm	14	0.55	20	0.79	50	1.97
<b>3/8" Square Drive, Magnetic</b>								
SAE	A31/4MP	1/4"	10	0.39	19	0.75	34	1.34
	A35/16MP	5/16"	12	0.47	19	0.75	34	1.34
	A33/8MP	3/8"	15	0.59	19	0.75	34	1.34
METRIC	A308MP	8 mm	14	0.55	20	0.79	32	1.26
	A310MP	10 mm	17	0.65	20	0.79	32	1.26
	A311MP	11 mm	17	0.65	19	0.75	34	1.34
<b>1/2" Square Drive</b>								
SAE	A43/8	3/8"	16	0.63	25	0.98	38	1.50
	A47/16	7/16"	18	0.69	25	0.98	38	1.50
	A41/2	1/2"	19	0.75	25	0.98	50	1.97
METRIC	A408	8 mm	16	0.61	25	0.98	40	1.58
	A409	9 mm	16	0.63	25	0.98	40	1.58
	A410	10 mm	18	0.69	25	0.98	40	1.58
<b>1/2" Square Drive, Deep</b>								
SAE	A43/8-3.25	3/8"	17	0.67	25	0.98	82	3.23
	A47/16-3.25	7/16"	19	0.73	25	0.98	82	3.23
	A41/2-3.25	1/2"	22	0.85	25	0.98	82	3.23

	PART NO	HEX	D1 MM	D1 IN	D2 MM	D2 IN	L MM	L IN
METRIC	A410-2	10 mm	18	0.69	25	0.98	50	1.97
	A410-3	10 mm	18	0.69	25	0.98	75	2.95
	A410-3.25	10 mm	17	0.67	25	0.98	82	3.23
	A411-3.25	11 mm	19	0.73	25	0.98	82	3.23
<b>1/2" Square Drive, Magnetic</b>								
	A408MP	8 mm	16	0.61	25	0.98	40	1.58
	A410MP	10 mm	18	0.69	25	0.98	40	1.58
	A412MP	12 mm	21	0.81	25	0.98	40	1.58
<b>3/4" Square Drive</b>								
SAE	A611/16	11/16"	30	1.18	44	1.73	50	1.97
	A63/4	3/4"	32	1.26	44	1.73	50	1.97
	A613/16	13/16"	35	1.38	44	1.73	50	1.97
METRIC	A614	14 mm	24	0.95	38	1.50	55	2.17
	A616	16 mm	27	1.06	44	1.73	50	1.97
	A617	17 mm	30	1.18	38	1.50	55	2.17
<b>3/4" Square Drive, Deep</b>								
SAE	A611/16-4	11/16"	31	1.22	44	1.73	100	3.94
	A63/4-4	3/4"	33	1.30	44	1.73	100	3.94
	A613/16-4	13/16"	36	1.42	44	1.73	100	3.94
METRIC	A617-4	17 mm	31	1.22	44	1.73	100	3.94
	A618-4	18 mm	32	1.26	44	1.73	100	3.94
	A619-4	19 mm	33	1.30	38	1.50	100	3.94
<b>1" Square Drive</b>								
SAE	A87/8	7/8"	37	1.46	54	2.13	59	2.32
	A815/16	15/16"	38	1.50	54	2.13	59	2.32
	A81	1"	41	1.61	54	2.13	59	2.32
METRIC	A817	17 mm	31	1.22	50	1.97	63	2.48
	A819	19 mm	33	1.30	50	1.97	63	2.48
	A821	21 mm	37	1.46	50	1.97	63	2.48

Additional types and sizes of fastener tools, as well as custom parts, are available upon request. Contact an AIMCO Customer Service Associate at 1-503-254-6600, or toll free 1-800-852-1368.

## ANTI-MARRING SOCKETS

AIMCO's anti-marring sockets have a protective resin cover that spins freely, preventing damage to application surfaces, and protecting fingers.



CV Series



CVF Series



CVF Series  
with Bit  
Attachment



# STANDARD FASTENER TOOLS

## UNIVERSAL SOCKETS

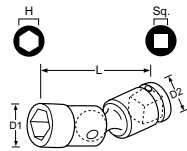

PART NO	HEX	D1 MM	D1 IN	D2 MM	D2 IN	L MM	L IN
<b>3/8" Square Drive</b>							
A310U	10 mm	16	0.63	20	0.79	55	2.17
A311U	11 mm	16	0.63	20	0.79	60	2.36

<b>1/2" Square Drive</b>							
A412U	12 mm	20.5	0.81	25	0.98	70	2.76
A413U	13 mm	19	0.75	24	0.95	70	2.76

## QUICK CHANGE CHUCKS

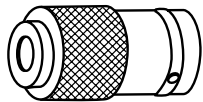

PART NO	SQ DRIVE	HEX	D1 MM	D1 IN	L MM	L IN
ADC-2S	1/4"	1/4"	19	0.75	38	1.50
ADC-3S	3/8"	1/4"	20	0.79	42	1.65
ADC-4S	1/2"	1/4"	19	0.75	46	1.81
ADC-3SH7/16Z	3/8"	7/16"	25	0.98	46	1.81
ADC-4SH7/16Z	1/2"	7/16"	33	1.30	55	2.17

## ALLEN SOCKETS

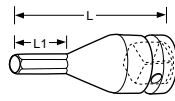

PART NO	HEX	L1 MM	L1 IN	L MM	L IN
<b>3/8" Square Drive</b>					
A314C	1/4"	10	0.39	42	1.65
A304C	4 mm	10	0.39	42	1.65

<b>1/2" Square Drive</b>					
A414C	1/4"	25	0.98	50	1.97
A405C	5 mm	25	0.98	50	1.97

## EXTENSIONS

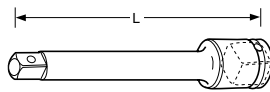

PART NO	SQ DRIVE	HEX	L MM	L IN	D MM	D IN
A375E	3/8"	3/8"	75	2.95	20	0.79
A405E	1/2"	1/2"	51	2.01	30	1.18
A610E	3/4"	3/4"	100	3.94	44	1.73
A810E	1"	1"	102	4.02	54	2.13
A1220E	1-1/4"	1-1/4"	200	7.87	60	2.36
A1418E	1-1/2"	1-1/2"	178	7.01	84	3.31
A2426E	2-1/2"	2-1/2"	264	10.39	137	5.39

## NUTSETTERS

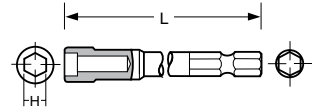

PART NO	HEX	L MM	L IN
A3B1/4-2	1/4"	50	1.97
A3B1/4-2.5	1/4"	63	2.50
A3B5/16-2	5/16"	50	1.97
A3B5/16-2.5	5/16"	63	2.50
A3B3/8-2	3/8"	50	1.97
A3B3/8-2.5	3/8"	63	2.50
A3B05-2.75	5 mm	70	2.76
A3B55-1.2	5.5 mm	30	1.18
A3B55-2.75	5.5 mm	70	2.76
A3B55-4	5.5 mm	100	3.94
A3B06-2.75	6 mm	70	2.76
A3B07-1.2	7 mm	30	1.18
A3B07-2	7 mm	50	1.97
A3B07-2.75	7 mm	70	2.76
A3B07-4	7 mm	100	3.94
A3B08-1.2	8 mm	30	1.18
A3B08-2	8 mm	50	1.97
A3B08-2.75	8 mm	70	2.76
A3B08-4	8 mm	100	3.94
A3B08-6	8 mm	150	5.91
A3B08-8	8 mm	200	7.87
A3B09-2.75	9 mm	70	2.76
A3B09-4	9 mm	100	3.94
A3B10-1.2	10 mm	30	1.18
A3B10-2	10 mm	50	1.97
A3B10-2.75	10 mm	70	2.76
A3B11-2.75	11 mm	70	2.76
A3B12-1.2	12 mm	30	1.18
A3B13-2.75	13 mm	70	2.76
A3B14-2.75	14 mm	70	2.76
A3B16-2.75	16 mm	70	2.76
A3B17-2.75	17 mm	70	2.76

## SOCKET ADAPTERS

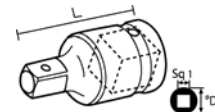

PART NO	FEMALE SQ. DRIVE	MALE SQ. DRIVE	D MM	D IN	L MM	L IN
A302A	3/8"	1/4"	22	0.87	35	1.38
A403A	1/2"	3/8"	25	0.98	37	1.46
A504A	5/8"	1/2"	35	1.38	47	1.85
A604A	3/4"	1/2"	38	1.50	53	2.09
A806A	1"	3/4"	50	1.97	70	2.76
A128A	1-1/4"	1"	60	2.36	76	2.99
A#508A	Spine #5	1"	60	2.36	90	3.54

Additional types and sizes of fastener tools, as well as custom parts, are available upon request. Contact an AIMCO Customer Service Associate at 1-503-254-6600, or toll free 1-800-852-1368.

# STANDARD FASTENER TOOLS

## PHILLIPS POWER BITS

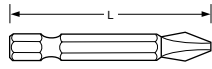

PART NO	POINT SIZE	L MM	L IN
A3S0-2	0	50	1.97
A3S1-2	1	50	1.97
A3S1-2.75	1	70	2.76
A3S1-3	1	75	2.95
A3S1-3.5	1	90	3.54
A3S1-4	1	100	3.94
A3S1-6	1	150	5.91
A3S2-1.2	2	30	1.18
A3S2-1.6	2	40	1.57
A3S3-2	3	50	1.97
A3S3-2.75	3	70	2.76

### Double-Ended

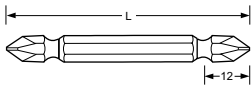

A3W1-3	1	75	2.94
A3W1-4	1	100	3.94
A3W2-2	2	50	1.97
A3W2-3	2	75	2.94
A3W2-4	2	100	3.94
A3W2-6	2	150	5.91
A3W2-8	2	200	7.87
A3W2-10	2	250	9.84
A3W2-12	2	300	11.81
A3W3-2	3	50	1.97
A3W3-3	3	75	2.94
A3W3-4	3	100	3.94
A3W3-6	3	150	5.91
A3W3-8	3	200	7.87

## TORX POWER BITS

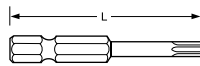

PART NO	TORX SIZE	L MM	L IN
A3T6-2	T6	50	1.97
A3T7-2	T7	50	1.97
A3T7-2.75	T7	70	2.76
A3T7-3.5	T7	90	3.54
A3T7-6	T7	150	5.91
A3T8-2	T8	50	1.97
A3T9-2.75	T9	70	2.76

## BIT HOLDERS

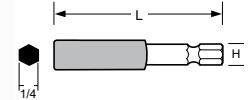

PART NO	L MM	L IN
1/4" Hex, Magnetic		
A3BHM-3	75	2.94
A3BHM-4	100	3.94
A3BHM-6	150	5.91
A3BHM-8	200	7.87
A3BHM-10	250	9.84

## Bit and Nutsetter Part Number Nomenclature

### Precedes Part Number

**BITS**  
**A3S** = Phillips® Power Drive  
**A3W** = Double Ended Phillips®  
**A3S** = Phillips® Insert  
**A3S** = Phillips® Insert Reduced Nose  
**A3M** = Slotted Power Drive  
**A3M** = Slotted Insert  
**A3MT** = Slotted Power Drive Reduced Nose  
**A3C** = Allen Socket Head Power Drive  
**A3C** = Allen Socket Head Insert  
**A3R** = Square Recess Power Drive  
**A3RT** = Square Recess Turned Down (Power)  
**A3BR** = Square Recess Insert  
**A3T** = Torx® Power Drive  
**A3T** = Torx® Insert  
**A3TS** = Torq-Set® Power Drive  
**A3TS** = Torq-Set® Insert  
**A3TA** = Triangle Power Drive  
**A3TW** = Tri-Wing® Power Drive  
**A38TW** = Tri-Wing® Insert

**A7** = 7/16 Power Drive  
**AS** = Electric Type Phillips®  
**AM** = Electric Type Slotted  
**ATW** = Electric Type Tri-Wing®  
**AT** = Electric Hios Type Torx®  
**A26S** = Electric Driver Phillips®  
**A26M** = Electric Driver Slotted  
**A26C** = Electric Driver Allen Socket Head  
**A3BHM** = Insert Bit Holder (Magnetic Type)  
**A3BHD** = Insert Bit Holder (Non Magnetic)

### NUTSETTERS

**A3B** = Nutsetter  
**A3BMP** = Magnetic (MP) Pressed Type  
**A3BMS** = Magnetic (MS) Spring Loaded  
**A3BMT** = Magnetic (MT) Tube Type  
**A3BU** = Universal Nutsetter

### MAG-O-NETS

**AM** = AIMCO Mag-O-Net®

### Contained within Part Number

**BITS**  
**PZ** = Pozidriv®  
**PZACR** = Pozidriv® ACR®  
**SDV** = Supadriv®  
**TR** = Torx® Tamper Resistant  
**ACRI** = ACR® Installation  
**ACR** = ACR® Remove  
**ACRB** = ACR® 4x4 Both Install and Remove  
**E4** = Electric 4mm diameter  
**E5** = Electric 5mm diameter  
**RS** = Reduced Shank

Additional types and sizes of fastener tools, as well as custom parts, are available upon request. Contact an AIMCO Customer Service Associate at 1-503-254-6600, or toll free 1-800-852-1368.

# ERGO-DRIVE SERIES

## ERGO-DRIVE® SOCKETS PROTECT...



### ...YOUR INVESTMENT!

Pulse tools are an investment and the anvil is the most expensive single part of any pulse tool. ERGO-DRIVE sockets decrease vibration and wear on this critical component.

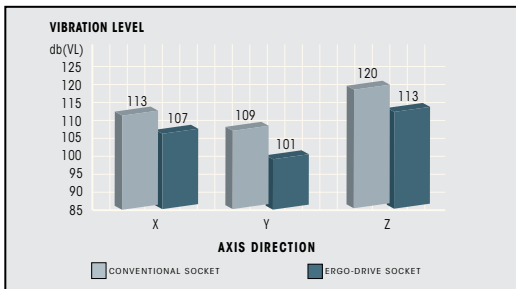
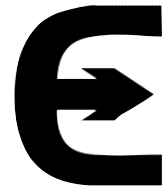

### ...YOUR ASSEMBLERS!

ERGO-DRIVE sockets cause significantly less vibration during fastening than conventional sockets. This allows your assemblers to do their jobs without the worry of vibration related injuries.

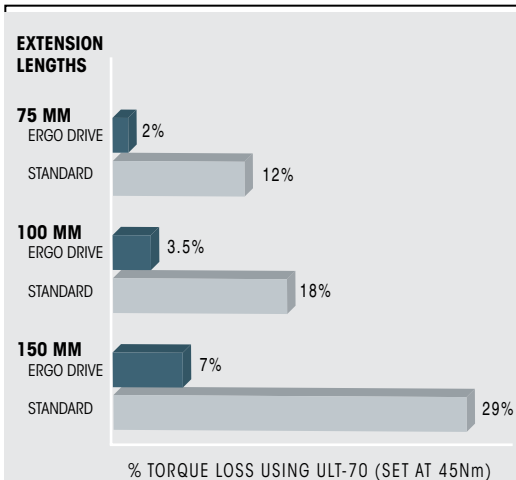

### ...YOUR PRODUCTS!

By reducing run-out and vibration, ERGO-DRIVE sockets allow the most repeatable, accurate rundowns to take place, ensuring excellent product quality.

## ERGO-DRIVE VS. STANDARD

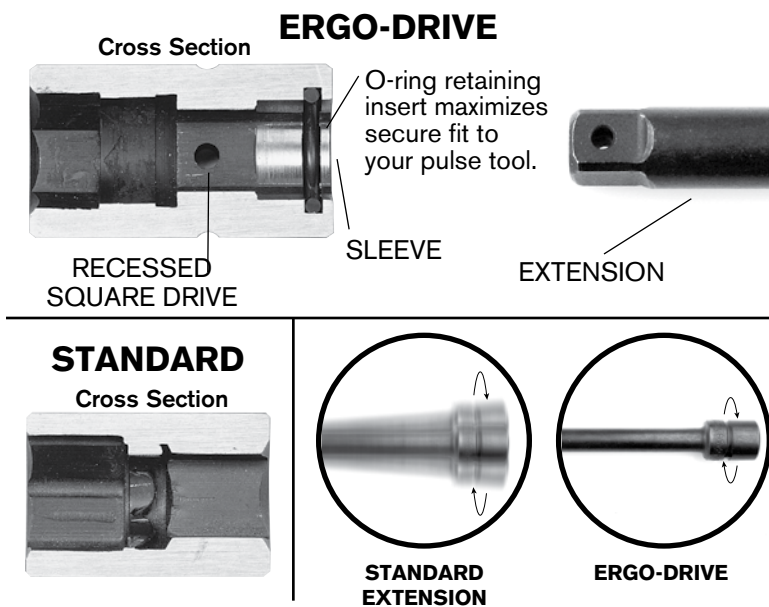

# ERGO-DRIVE FASTENER TOOLS

## ERGO-DRIVE SOCKETS

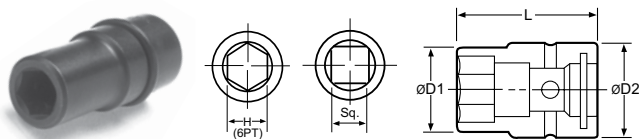

PART NO	HEX	D1 MM	D1 IN	D2 MM	D2 IN	L MM	L IN
---------	-----	----------	----------	----------	----------	---------	---------

3/8" Square Drive							
A31/4EDS	1/4"	10	0.39	19	0.75	44	1.73
A31/2EDS	1/2"	20	0.77	22	0.87	44	1.73
A306EDS	6 mm	10	0.39	19	0.75	44	1.73
A308EDS	8 mm	14	0.55	20	0.79	42	1.65
A310EDS	10 mm	17	0.65	20	0.79	42	1.65
A312EDS	12 mm	20	0.79	20	0.79	42	1.65
A314EDS	14 mm	22	0.87	20	0.79	42	1.65
A316EDS	16 mm	25	0.98	20	0.79	45	1.77
A318EDS	18 mm	27	1.06	20	0.79	45	1.77

1/2" Square Drive							
A41/2EDS	1/2"	19	0.75	25	0.98	50	1.97
A413EDS	13 mm	22	0.85	25	0.98	52	2.05
A414EDS	14 mm	23	0.89	25	0.98	52	2.05
A415EDS	15 mm	24	0.93	25	0.98	52	2.05
A416EDS	16 mm	25	0.98	25	0.98	52	2.05
A417EDS	17 mm	28	1.10	28	1.10	54	2.13
A418EDS	18 mm	29	1.14	28	1.10	54	2.13
A419EDS	19 mm	30	1.18	28	1.10	54	2.13

3/4" Square Drive							
A61-1/8EDS	1-1/8"	44	1.73	44	1.73	64	2.52
A61-1/4EDS	1-1/4"	49	1.91	44	1.73	66	2.60
A61-1/2EDS	1-1/2"	57	2.24	44	1.73	68	2.68
A618EDS	18 mm	31	1.22	44	1.73	60	2.36
A624EDS	24 mm	40	1.52	40	1.73	65	2.36

1" Square Drive							
A815/16EDS	15/16"	38	1.50	54	2.13	69	2.72
A8100EDS	100 mm	136	5.35	76	2.99	120	4.72

## ERGO-DRIVE EXTENSIONS

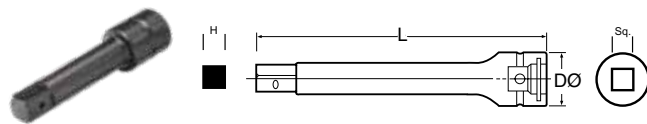

PART NO	SQ DRIVE	H	L MM	L IN	D MM	D IN
---------	-------------	---	---------	---------	---------	---------

3/8" Square Drive						
A352EDE	3/8"	3/8"	52	2.05	20	0.79
A3100EDE	3/8"	3/8"	100	3.94	20	0.79
A375EDE	3/8"	3/8"	75	2.95	20	0.79
A3150EDE	3/8"	3/8"	150	5.91	20	0.79
A3190EDE	3/8"	3/8"	190	7.48	20	0.79
A3254EDE	3/8"	3/8"	254	10.00	20	0.79
A3300EDE	3/8"	3/8"	300	11.81	20	0.79
A3320EDE	3/8"	3/8"	320	12.60	20	0.79

1/2" Square Drive						
A464EDE	1/2"	1/2"	64	2.52	28	1.10
A476EDE	1/2"	1/2"	76	2.99	28	1.10
A4125EDE	1/2"	1/2"	125	4.92	28	1.10
A4204EDE	1/2"	1/2"	204	8.03	28	1.10
A4254EDE	1/2"	1/2"	254	10.00	28	1.10
A4355EDE	1/2"	1/2"	355	13.98	28	1.10

3/4" Square Drive						
A676EDE	3/4"	3/4"	76	2.99	40	1.58
A6100EDE	3/4"	3/4"	100	3.94	40	1.58
A6150EDE	3/4"	3/4"	150	5.91	40	1.58
A6200EDE	3/4"	3/4"	200	7.87	40	1.58

1" Square Drive						
A8150EDE	1"	1"	150	5.91	54	2.13
A8200EDE	1"	1"	200	7.87	54	2.13

## ERGO-DRIVE QUICK CHANGE CHUCKS

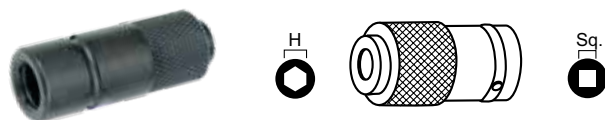

PART NO	SQUARE DRIVE	HEX
---------	--------------	-----

3/8" Square Drive		
ADC-3SEDSQ	3/8"	1/4"
ADC-3SEDSQH7/16	3/8"	7/16"

1/2" Square Drive		
ADC-4SEDSQ	1/2"	1/4"
ADC-4SEDSQH7/16	1/2"	7/16"

Additional types and sizes of fastener tools, as well as custom parts, are available upon request. Contact an AIMCO Customer Service Associate at 1-503-254-6600, or toll free 1-800-852-1368.

# CUSTOM BITS, SOCKETS, AND EXTENSIONS

## CUSTOM BITS, SOCKETS, AND EXTENSIONS FOR THE POWER TOOL USER

AIMCO can provide specials for virtually any application. From design to delivery, AIMCO's quick response ensures high quality, tight tolerance specials.

### Specials are available in every style including:

- Deep Socket
- Extended Socket
- Universal
- Allen Head
- Torx Head
- Socket Adapter
- Nut Runner Socket
- Nut Runner Joint
- Nutsetter
- Magnetic Nutsetter
- Universal Nutsetter
- Screwdriver Bits



Sample request forms are shown. Your detailed requirements will allow AIMCO to quickly respond with custom solutions for your fastening requirements.

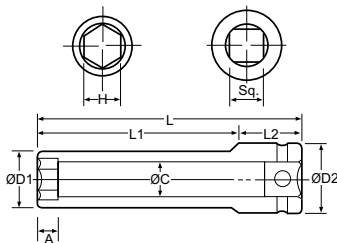

MAGNET		
MP	MT	MS
•	•	•
•	•	•

### SOCKET

	H	L	L <sub>1</sub>	L <sub>2</sub>	A	ØC	ØD <sub>1</sub>	ØD <sub>2</sub>	Sq.
SIZE	•	•	•	•	•	•	•	•	•
TYPE	•	•	•	•	•	•	•	•	•



# SPECIAL PARTS

**SOCKET TYPES**

DOUBLE HEX D (12 PT) (DH)    SURFACE DRIVE (SF)    DOUBLE SQUARE (DSQ)    FLANK DRIVE (FD)    SINGLE HEX H (6 PT) (SH)    FAST LEAD (FL)    SINGLE SQUARE (SQ)    HEX LOBULE (TORX)

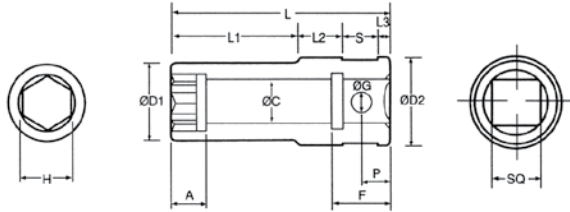

**NUTRUNNER SOCKET TYPE A**

Min. Qty. 10

Magnet MP MT MS	H	L	L <sub>1</sub>	L <sub>2</sub>	L <sub>3</sub>	S	ØD <sub>1</sub>	A	ØC	ØG	P	F	ØD <sub>2</sub>	Sq.	Qty.
SIZE															
TYPE															

✓ Box for Ergo-Drive

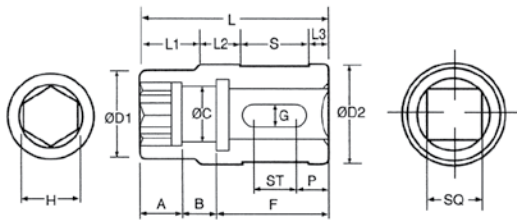

**NUTRUNNER SOCKET TYPE B**

Min. Qty. 10

H	L	L <sub>1</sub>	L <sub>2</sub>	L <sub>3</sub>	S	ØD <sub>1</sub>	A	B	ØC	G	P	F	ST	ØD <sub>2</sub>	Sq.	Qty.
SIZE																
TYPE																

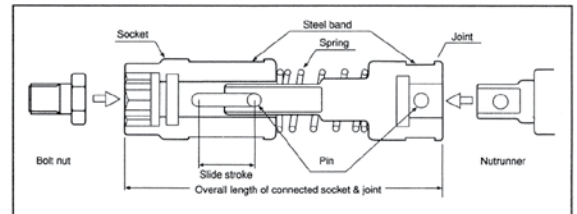
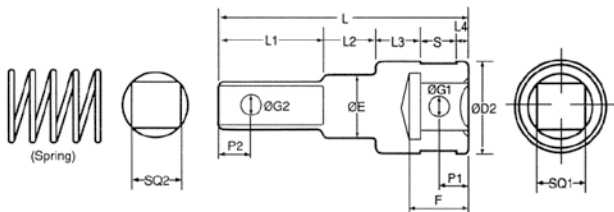

**NUTRUNNER JOINT TYPE B**

Min. Qty. 10

SQ <sub>2</sub>	L	L <sub>1</sub>	L <sub>2</sub>	L <sub>3</sub>	L <sub>4</sub>	S	P <sub>1</sub>	ØG <sub>2</sub>	ØE	F	ØG <sub>1</sub>	P <sub>2</sub>	ØD <sub>2</sub>	SQ <sub>1</sub>	Qty.

✓ Box for Ergo-Drive

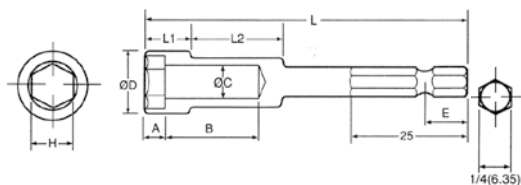

**NUT SETTER**

Min. Qty. 10

H	ØD	L	E	L <sub>1</sub>	L <sub>2</sub>	A	B	ØC	Qty.
SIZE									
TYPE									

# SPECIAL PARTS

## MAGNETIC STYLES:

MP (Press-inserted) Type

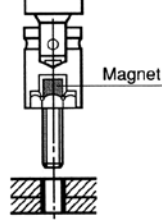

MS (Sliding) Type

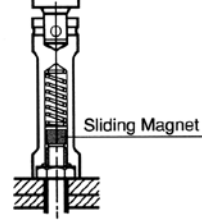

MT (Tube) Type

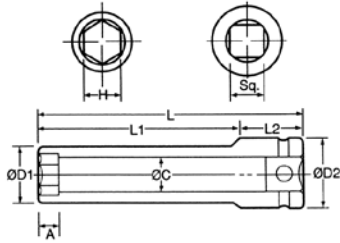
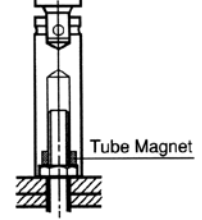

## SOCKET

Min. Qty. 10

Magnet		H	L	L <sub>1</sub>	L <sub>2</sub>	A	øC	øD <sub>1</sub>	øD <sub>2</sub>	Sq.	Qty.
MP	MT	MS									
SIZE											
TYPE											

√ Box for Ergo-Drive

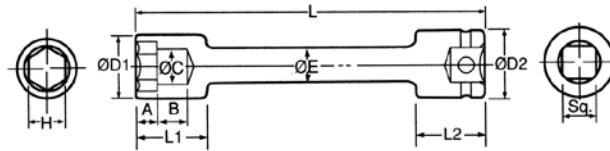

## EXTENSION SOCKET

Min. Qty. 10

Magnet		H	L	L <sub>1</sub>	L <sub>2</sub>	A	B	øC	øD <sub>1</sub>	øD <sub>2</sub>	øE	Sq.	Qty.
MP	MT	MS											
SIZE													
TYPE													

√ Box for Ergo-Drive

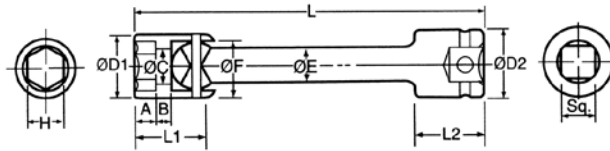

## UNIVERSAL SOCKET

Min. Qty. 10

Magnet		H	L	L <sub>1</sub>	L <sub>2</sub>	A	B	øC	øD <sub>1</sub>	øD <sub>2</sub>	øE	øF	Sq.	Qty.
MP	MT	MS												
SIZE														
TYPE														

√ Box for Ergo-Drive

## ALLEN HEAD/TORX HEAD

Min. Qty. 10

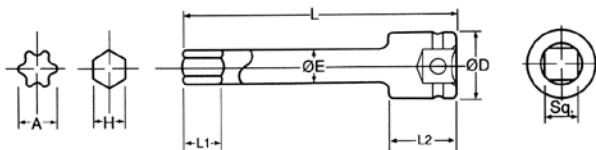

Torx	H	L	L <sub>1</sub>	L <sub>2</sub>	øD	øE	Sq.	Qty.

√ Box for Ergo-Drive

## SOCKET ADAPTER

Min. Qty. 10

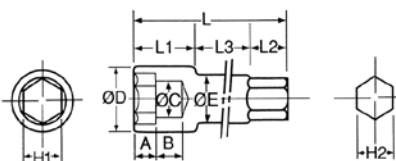

H <sub>1</sub>	L	L <sub>1</sub>	L <sub>2</sub>	L <sub>3</sub>	øD	A	B	øC	øE	H <sub>2</sub>	Qty.
SIZE											
TYPE											

# SPECIAL PARTS

## (MP) MAGNETIC NUT SETTER

Min. Qty. 10

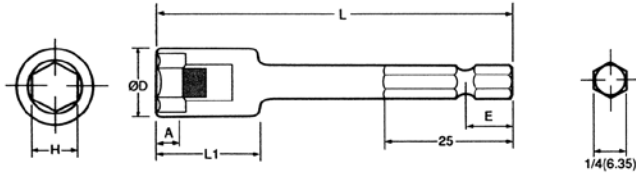

	H	L	E	L <sub>1</sub>	∅D	A	Qty.
SIZE							
TYPE							

## (MS) MAGNETIC NUT SETTER

Min. Qty. 10

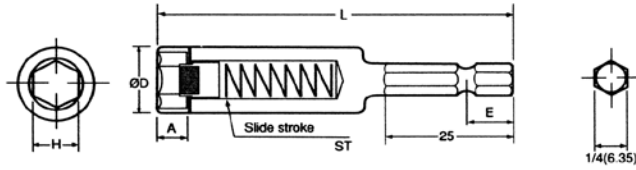

	H	L	E	∅D	A	ST	Qty.
SIZE							
TYPE							

## (MT) MAGNETIC NUT SETTER

Min. Qty. 10

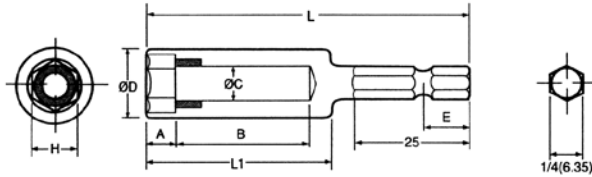

	H	L	E	L <sub>1</sub>	∅D	A	B	∅C	Qty.
SIZE									
TYPE									

## UNIVERSAL NUT SETTER

Min. Qty. 10

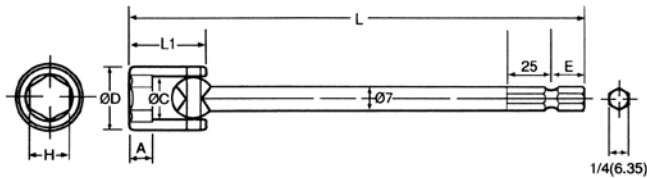

	H	L	E	L <sub>1</sub>	A	∅C	∅D	Qty.

## SCREWDRIVER BIT

Min. Qty. 500

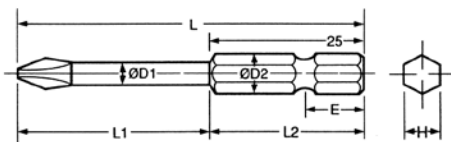

Point Size	L	L <sub>1</sub>	L <sub>2</sub>	∅D <sub>1</sub>	∅D <sub>2</sub>	E	H	Qty.

CIRCLE ONE:





PRINTED IN THE U.S.A.

LIT-AT125, REV 06-17-19, ©2019 AIMCO

AIMCO CORPORATE HEADQUARTERS

10000 SE Pine Street  
Portland, Oregon 97216  
Phone: (503) 254-6600  
Toll Free: 1-800-852-1368

AIMCO CORPORATION DE MEXICO SA DE CV

Ave. Cristobal Colon 14529  
Chihuahua, Chihuahua. 31125  
Phone: (01-614) 380-1010  
Fax: (01-614) 380-1019