

UXR-2400SMC OIL-PULSE TOOLS

EXPLODED VIEW

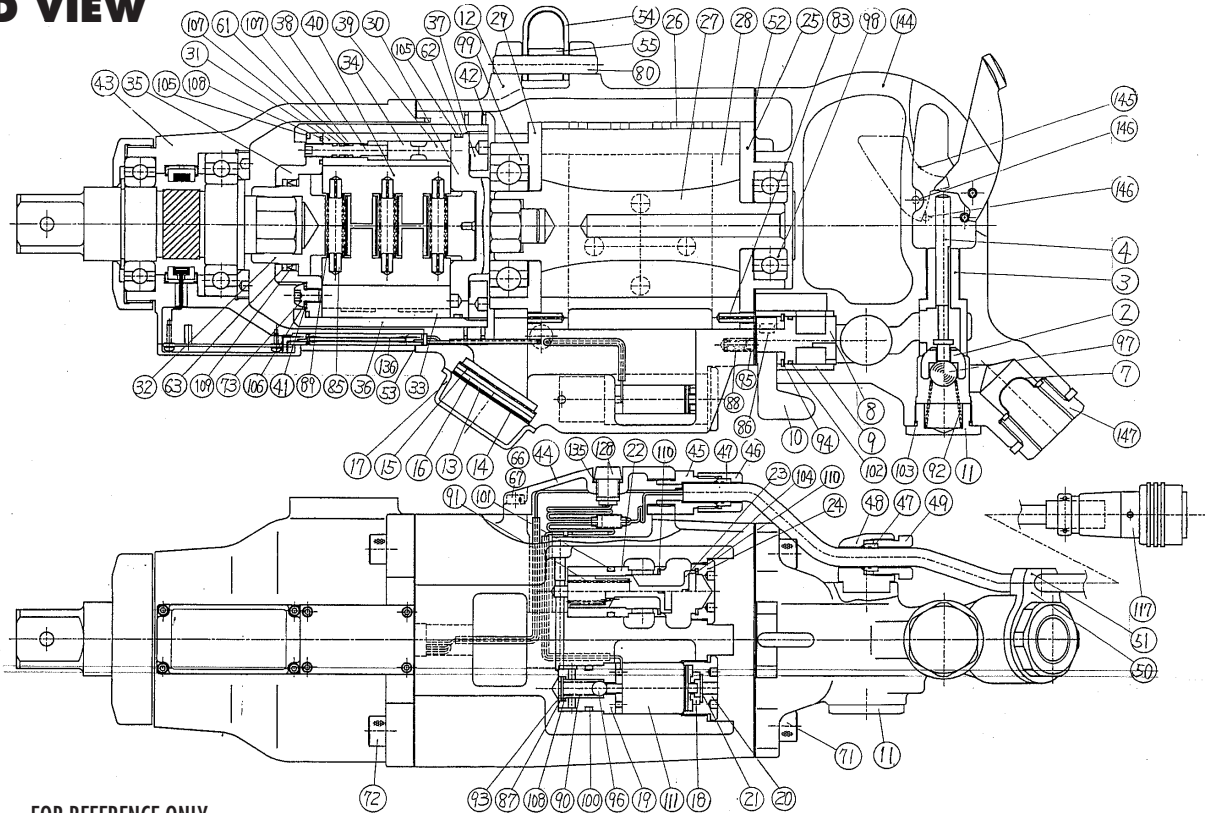

PARTS LIST — FOR REFERENCE ONLY

Index Number	Part Number	Description	Qty.	Index Number	Part Number	Description	Qty.	Index Number	Part Number	Description	Qty.
1	166-010-0	Handle (Out)	1	44	166-035-0	Casing Connector	1	87	975-594-0	Round Plate	1
2	116-100-0	Valve	1	45	149-079-2	Connector	1	88	976-076-0	Spring (5 x 19)	1
3	116-103-0	Valve Rod Bushing	1	46	149-018-2	Cap	1	89	976-798-0	Spring (7.3 x 56) (0.9) (WPC)	3
4	166-104-0	Valve Rod	1	47	149-562-2	Stopper	2	90	976-114-0	Spring (6 x 18)	1
5	109-107-1	Throttle Trigger (Out)	1	48	166-278-0	Handle Connector	1	91	976-509-0	Spring (10 x 38) (1.0) SUS	1
6	518-091-6	Air Inlet Bushing	1	49	166-082-1	Connecting Screw	1	92	977-257-0	Cone Spring (10 x 15 x 25)	1
7	573-835-9	Filter	1	50	166-718-0	Mounting Fixture	1	93	979-003-0	Inner Snap Ring (10)	1
8	176-210-5	Reverse Valve	1	51	166-965-0	Mounting Plate	1	94	979-015-0	Inner Snap Ring (22)	1
9	176-211-5	Reverse Valve Bushing	1	52	103-850-0	Rear Packing	1	95	981-005-0	Ball (7/32)	1
10	103-212-0	Reverse Lever	1	53	166-867-0	Front Casing Packing	1	96	981-029-0	Ball (1/4)	1
11	103-243-0	Regulator Valve Cover	2	54	195-790-9	Suspension Ring	1	97	981-032-0	Ball (7/16)	1
12	166-025-0	Casing	1	55	173-796-3	Suspension Bushing	1	98	982-204-0	Ball Bearing (6204)	1
13	194-021-9	Exhaust Mesh Plate	1	56	116-896-0	Dead Handle Assembly	1	99	982-206-0	Ball Bearing (6206)	1
14	194-042-9	Silencer	1	57	116-720-0	Dead Handle	1	100	990-016-0	O-Ring (P16)	1
15	194-099-9	Punch Plate	1	58	116-722-0	Dead Handle Connector	1	101	990-958-0	O-Ring (P16)	1
16	194-835-9	Filter	2	59	166-924-0	Metal Tag	1	102	990-916-0	O-Ring (SNS-18)	1
17	103-782-0	Exhaust Cover	1	60	940-035-0	Air Hose Nipple (1/2 x 1/2)	1	103	990-979-0	O-Ring (SNS-20)	2
18	166-120-0	Valve Packing Spacer	1	61	944-005-0	Support Ring (4.2 x 6 x 1)	1	104	990-919-0	O-Ring (SNS-22)	1
19	166-147-0	Stop Valve Bushing	1	62	944-077-0	Supporting Ring (77 x 80 x 1)	1	105	990-889-0	O-Ring (SNS-75)	2
20	166-149-0	Stop Valve Plug	1	63	944-230-0	Supporting Ring (33.9 x 39.6 x 1.5)	1	106	990-949-0	O-Ring (P3) (NOK)	1
21	193-872-6	Valve Packing	1	64	945-000-0	Allen Head Bolt (M3 x 8)	2	107	990-972-0	O-Ring (SNS-4) (NOK)	2
22	166-253-0	Shut-Off Valve Bushing	1	65	945-008-0	Allen Head Bolt (M4 x 8)	4	108	990-975-0	O-Ring (SNS-8) (NOK)	2
23	166-254-0	Shut-Off Valve	1	66	945-010-0	Allen Head Bolt (M4 x 10)	2	109	995-501-0	Teflon Seal (P34)	1
24	166-927-0	Shut-Off Valve Cover	1	67	945-022-0	Allen Head Bolt (M4 x 22)	2	110	996-436-0	Urethane Packing (20 x 1.5 x 19)	2
25	176-285-5	Rear Plate	1	68	945-114-0	Allen Head Bolt (M5 x 14)	4	111	909-967-0	Solenoid Valve Assembly	1
26	176-286-5	Cylinder	1	69	945-128-0	Allen Head Bolt (M5 x 28)	1	117	911-087-0	Joint Cable Assembly	1
27	176-287-5	Rotor	1	70	945-318-0	Allen Head Bolt (M8 x 18)	2	124	909-918-0	Socket (DF-11-12DC-2C)	1
28	176-288-5	Blade	7	71	945-322-0	Allen Head Bolt (M8 x 22)	4	125	909-733-0	Connector (RF-06)	1
29	176-289-5	Front Plate	1	72	945-325-0	Allen Head Bolt (M8 x 25)	4	126	909-707-0	Shrink Tube (6 x 30)	1
30	176-901-5	Rear Liner Plate	1	73	945-960-0	Hexagon Round Head Bolt (M6 x 8)	1	127	909-708-0	Shrink Tube (8 x 30)	1
31	176-902-5	Liner	1	74	952-105-0	Allen Head Dog Point Screw (M4 x 5)	1	128	909-548-0	LED Lamp Assembly	1
32	166-319-0	Anvil	1	75	953-210-0	Allen Head Flat Point Screw (M5 x 10)	1	136	909-999-0	Sensor Cable Connector Assembly	1
33	176-974-5	Roller (4.4 x 55)	2	76	961-014-0	Flat Washer (8 mm)	2	140	909-921-0	Sensor Cable Assembly (3F5)	1
34	176-440-5	Driving Blade	2	77	965-006-0	Helix-Sert (M4 x 1.5D)	4	144	166-010-2	Handle (In)	1
35	176-904-5	Front Liner Plate	1	78	965-041-0	Helix-Sert (M8 x 1.5D)	8	145	085-107-1	Throttle Trigger	1
36	176-905-5	Liner Casing	1	79	969-465-0	Pin (G) (6 x 12)	2	146	973-124-0	Roll Pin (3 x 24)	2
37	176-906-5	Liner Casing Setter	1	80	969-481-0	Pin (C) (8 x 45)	1	148	940-126-0	Air Hose Nipple (NPT 1/2 x 1/2)	1
38	194-907-8	Relief Valve Spindle	1	81	970-508-0	Pin (H) (6 x 8)	4	149	904-430-0	Extension Bar 1" (1 x 90)	1
39	194-969-9	Relief Valve Plug	1	82	973-108-0	Roll Pin (3 x 8)	2	150	953-408-0	Allen Head Flat Point Screw (M8 x 8)	1
40	194-970-8	Relief Valve	1	83	973-214-0	Roll Pin (4 x 14)	2	151	971-435-0	Pin (5 x 35)	1
41	188-807-1	Spacer	1	84	973-222-0	Roll Pin (4 x 22)	2				
42	166-754-0	Clip Guide	1	85	973-308-0	Roll Pin (5 x 8)	6				
43	851-687-1	Sensor Casing Assembly	1	86	974-008-0	Key (3 x 8)	1				

FOOTNOTES



10000 SE PINE
PORTLAND, OR 97216
503-254-6600
FA x 503-255-2615

When ordering spare parts, please specify
tool type, part number, and description.